

- NOTES:
1. MATERIALS: SEE TABLE
 2. PLATING: SEE TABLE
 3. RECOMMENDED PCB THICKNESS=1.2mm.
 4. PRODUCT SPECIFICATION REFER TO PS-48286-001.
 5. PACKING SPECIFICATION REFER TO PK-48286-001.
 6. TEST SUMMARY REFER TO TS-48286-001.
 7. LEAD FREE AND RoHS COMPLIANT PRODUCT.
 8. DATE CODE: 123 4 56 7.
 - MONDAY: 1-SUNDAY: 7
 - WEEK CODE
 - YEAR
 - MOLEX INTERNAL

ITEM	DESCRIPTION	Q'TY	MATERIAL	TREATMENT	REMARK
8	CN# CONTACT	1	PHOSPHOR BRONZE THICKNESS=0.2	GOLD FLASH OVERALL UNDERPLATED NICKEL (Ni) OVERALL	
7	CS# CONTACT	1	BRASS THICKNESS=0.2	GOLD FLASH OVERALL UNDERPLATED NICKEL (Ni) OVERALL	
6	1# CONTACT	1	PHOSPHOR BRONZE THICKNESS=0.2	SELECTIVE GOLD (Au) IN CONTACT AREA THICKNESS = 0.75 MICROMETER MINIMUM GOLD FLASH OVERALL UNDERPLATED NICKEL (Ni) OVERALL	
5	3# CONTACT	1	PHOSPHOR BRONZE THICKNESS=0.25	GOLD FLASH OVERALL UNDERPLATED NICKEL (Ni) OVERALL	
4	4# CONTACT	1	TITANIUM COPPER THICKNESS=0.25	SELECTIVE GOLD (Au) IN CONTACT AREA THICKNESS = 0.75 MICROMETER MINIMUM GOLD FLASH OVERALL UNDERPLATED NICKEL (Ni) OVERALL	
3	5# CONTACT	1	PHOSPHOR BRONZE THICKNESS=0.25	GOLD FLASH OVERALL UNDERPLATED NICKEL (Ni) OVERALL	
2	SHELL	1	BRASS THICKNESS=0.2	NICKEL (Ni) OVER ALL	
1	HOUSING	1	NYLON	COLOR: BLACK, GLASS FIBER FILLED, UL94V-0.	

ENTER DESCRIPTION EC NO: SHZ008-0283 DRW: BKANG 2007/12/13 CHKD: 2007/12/18 APPR: WMSCHANG 2008/01/14	QUALITY SYMBOLS ▽=0 ◻=0	GENERAL TOLERANCES (UNLESS SPECIFIED)		DIMENSION STYLE MM ONLY		SCALE 5:1		DESIGN UNITS METRIC		THIRD ANGLE PROJECTION	
		4 PLACES ± --- ± --- 3 PLACES ± --- ± --- 2 PLACES ± 0.25 ± --- 1 PLACE ± 0.25 ± --- ANGULAR ± 3 °	DRAWN BY AMANDA DATE 2007/07/01	TITLE AUDIO JACK 6 CKTS RIGHT ANGLE DIP TYPE							
B	REV	DRAFT WHERE APPLICABLE MUST REMAIN WITHIN DIMENSIONS		APPROVED BY ALL IN DATE 2007/07/13		MATERIAL NO. 48286-0002		MOLEX INCORPORATED		SHEET NO. 1 OF 2	
		SIZE A3		THIS DRAWING CONTAINS INFORMATION THAT IS PROPRIETARY TO MOLEX INCORPORATED AND SHOULD NOT BE USED WITHOUT WRITTEN PERMISSION							

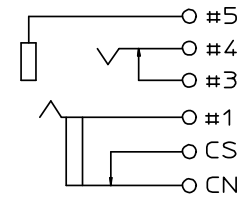
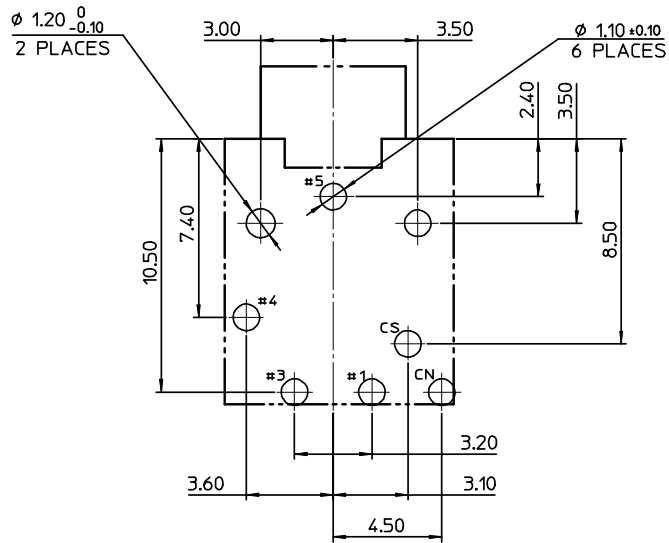

SCHEMATIC

△

SCHEMATIC DESCRIPTION	
PLUG OUT	#3 & #4 CLOSE CS & CN CLOSE
PLUG INSERT	#3 & #4 OPEN CS & CN OPEN

△ RECOMMENDED P.C.B. LAYOUT, THICKNESS=1.2mm
△ (COMPONENT SIDE) TOLERANCE:±0.05mm

ENTER DESCRIPTION EC NO: SH2008-0283 DRWN: BKANG 2007/12/13 CHKD: 2007/12/18 APPR: WMSCHANG 2008/01/14	QUALITY SYMBOLS ▽=0 ▽=0	GENERAL TOLERANCES (UNLESS SPECIFIED)		DIMENSION STYLE MM ONLY		SCALE 1:1	DESIGN UNITS METRIC	THIRD ANGLE PROJECTION			
				mm	INCH	DRAWN BY	DATE	TITLE			
		4 PLACES	± ---	± ---	AMANDA	2007/07/01	AUDIO JACK 6 CKTS RIGHT ANGLE DIP TYPE				
		3 PLACES	± ---	± ---	CHECKED BY	DATE					
2 PLACES	± 0.25	± ---	BKANG	2007/07/13	MOLEX INCORPORATED						
1 PLACE	± 0.25	± ---	APPROVED BY	DATE							
ANGULAR ± 3°		DRAFT WHERE APPLICABLE MUST REMAIN WITHIN DIMENSIONS		ALL IN	2007/07/13	MATERIAL NO. 48286-0002		DOCUMENT NO. SD-48286-001			
				SIZE	THIS DRAWING CONTAINS INFORMATION THAT IS PROPRIETARY TO MOLEX INCORPORATED AND SHOULD NOT BE USED WITHOUT WRITTEN PERMISSION				SHEET NO. 2 OF 2		