

Pb THIS PRODUCT MANUFACTURED WITH LEAD-FREE PROCESSING

DESIGNED & DIMENSIONED IN MILLIMETERS [INCHES]

DO NOT SCALE FROM THIS PRINT

RFX6T-XXXXX-XXXXXX-XXXX

CABLE CALLOUT
A6T: RG-6 CABLE (CCA-6)
B6T: BELDEN 1694A CABLE (CCA-1694A)

OVERALL ASSEMBLY LENGTH (OAL)
XXXX (MILLIMETERS) (0300 MIN)
(SEE NOTE 8)

END 1 CONNECTOR
(SEE TABLE 3, SHT 2)

END 2 CONNECTOR OR PREPARATION
(SEE TABLE 3, SHT 2)

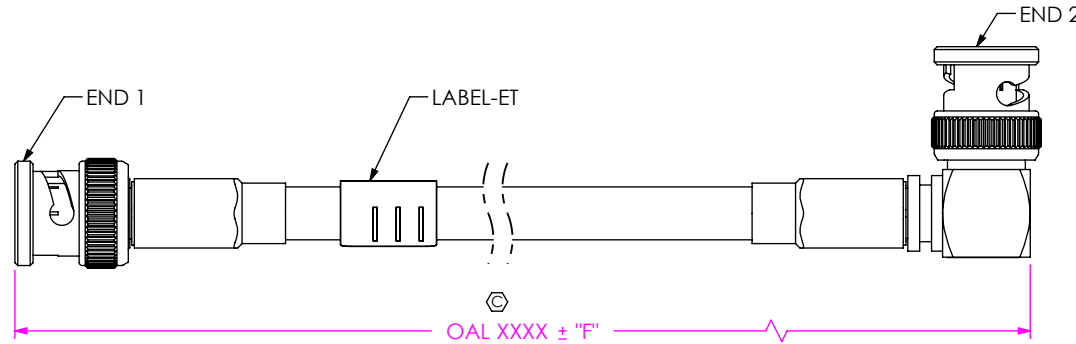

FIG 1
RFX6T-74SPX-74RPX-XXXX SHOWN

| TABLE 2 | |
|-------------------------|------------------------|
| LENGTH | "F" |
| 0300-0500 [11.81-19.69] | +5.0 [.20]/-0.0 [.00] |
| 0501-1100 [19.72-43.31] | +10.0 [.40]/-0.0 [.00] |
| >1100 [43.31] | ± 1% |

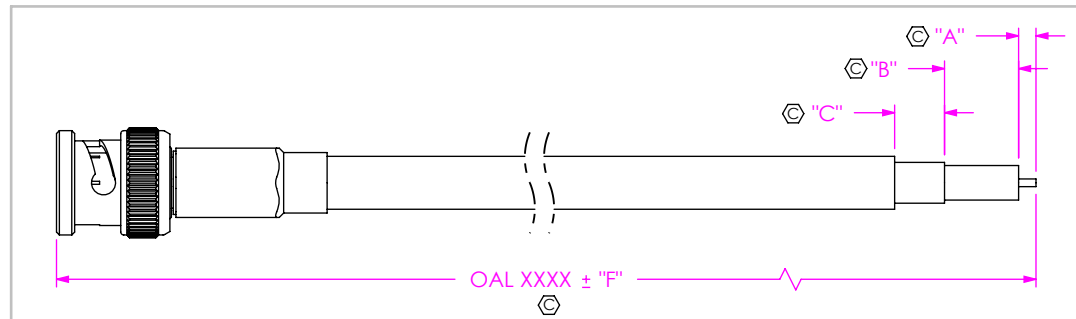

FIG 2
RFX6T-74SPX-172849-XXXX SHOWN (SEE NOTES 5 & 7)

"C" FORMAT: X.X mm
"B" FORMAT: X.X mm
"A" FORMAT: X.X mm

DO NOT LEAVE ANY SPACE BLANK,
EACH MUST CONTAIN A
NUMERIC CHARACTER 0 THRU 9.

NOTES:

- ⊕ REPRESENTS A CRITICAL DIMENSION
- ASSEMBLY TO BE 100% TESTED FOR OPENS, SHORTS & HI-POT TESTED (PER TABLE 1, AC OR DC), THE HI-POT VOLTAGE FOR THE ASSEMBLY SHOULD BE SET TO THE END OPTION WITH THE LOWEST TEST VOLTAGE RATING.
- AFTER FINAL ELECTRICAL TEST, LABEL EACH CABLE ASSEMBLY WITH 1 LABEL-ET.
- FINISHED ASSEMBLIES TO BE PACKAGED PER PACKAGING STANDARD CO-RF-WI-3040-M. ASSEMBLIES WITH LOCKWASHERS, NUTS, AND GASKETS TO BE SHIPPED KITTED AS ONE ASSEMBLY PER BAG, UNASSEMBLED.
- DIM "A", "B", AND "C" HAVE A MINIMUM VALUE OF 0.0mm & A MAXIMUM VALUE OF 9.9mm.
- CONNECTORS TO BE ORIENTED ACCORDING TO CO-RF-WI-3048-M.
- FOR STRIPPED AND TINNED OPTION, ONLY THE CENTER CONDUCTOR IS TINNED.
- CABLE LENGTHS LONGER THAN 1000 MILLIMETERS ARE NOT SUPPORTED BY S.I. TEST DATA.

F:\DWG\MISC\MKTG\RFX6T-XXXXX-XXXXXX-MKT.SLDDRW

UNLESS OTHERWISE SPECIFIED, DIMENSIONS ARE IN MILLIMETERS [INCHES]. TOLERANCES ARE:

| | |
|----------------------|--------|
| DECIMALS | ANGLES |
| .X: ±0.3 [.01] | 2° |
| .XX: ±0.13 [.005] | |
| .XXX: ±0.051 [.0020] | |

MATERIAL: DO NOT SCALE DRAWING SHEET SCALE: 2:1

DIELECTRIC: PTFE
GASKET: SILICONE
SPRING: STAINLESS STEEL
ALL OTHER: BRASS

PROPRIETARY NOTE
THIS DOCUMENT CONTAINS CONFIDENTIAL AND PROPRIETARY INFORMATION AND ALL DESIGN, MANUFACTURING, REPRODUCTION, USE, PATENT RIGHTS AND SALES RIGHTS ARE EXPRESSLY RESERVED BY SAMTEC, INC. THIS DOCUMENT SHALL NOT BE DISCLOSED, IN WHOLE OR PART, TO ANY UNAUTHORIZED PERSON OR ENTITY NOR REPRODUCED, TRANSFERRED OR INCORPORATED IN ANY OTHER PROJECT IN ANY MANNER WITHOUT THE EXPRESS WRITTEN CONSENT OF SAMTEC, INC.



520 PARK EAST BLVD, NEW ALBANY, IN 47150
PHONE: 812-944-6733 FAX: 812-948-5047
e-Mail info@SAMTEC.com code 55322

DESCRIPTION:
TRUE 75 OHM, RF6T CABLE ASSEMBLY

DWG. NO.
RFX6T-XXXXX-XXXXXX-XXXX

BY: R MUSSER 03/27/2009 SHEET 1 OF 8

TABLE 3

| END 2 OPTION | SERIES | GENDER | CONFIGURATION | PLATING | | | FIGURE |
|--------------|-------------------------|--------|---------------|----------------|---------------|------------------|--------------|
| | | | | CENTER CONTACT | OUTER CONTACT | OTHER COMPONENTS | |
| -74RP3 | 75 OHM BNC | PLUG | RIGHT ANGLE | 10µ" GOLD | 100µ" NICKEL | 100µ" NICKEL | SHT 3, FIG 3 |
| -74SP3 | 75 OHM BNC | PLUG | STRAIGHT | 10µ" GOLD | 100µ" NICKEL | 100µ" NICKEL | SHT 3, FIG 4 |
| -H4SP2 | 75 OHM HIGH DENSITY BNC | PLUG | STRAIGHT | 30µ" GOLD | 100µ" NICKEL | 100µ" NICKEL | SHT 4, FIG 5 |
| -H4SP3 | 75 OHM HIGH DENSITY BNC | PLUG | STRAIGHT | 10µ" GOLD | 100µ" NICKEL | 100µ" NICKEL | |
| -H4SP4 | 75 OHM HIGH DENSITY BNC | PLUG | STRAIGHT | 10µ" GOLD | 3µ" GOLD | 100µ" NICKEL | |
| -H4SP8 | 75 OHM HIGH DENSITY BNC | PLUG | STRAIGHT | 30µ" GOLD | 3µ" GOLD | 100µ" NICKEL | |
| -D4SP3 | 75 OHM BNC (DIE CAST) | PLUG | STRAIGHT | 10µ" GOLD | 100µ" NICKEL | 100µ" NICKEL | SHT 4, FIG 6 |
| -78SP4 | 75 OHM DIN 1.0/2.3 | PLUG | STRAIGHT | 10µ" GOLD | 3µ" GOLD | 100µ" NICKEL | SHT 5, FIG 7 |
| -78SP5 | 75 OHM DIN 1.0/2.3 | PLUG | STRAIGHT | 10µ" GOLD | 10µ" GOLD | 100µ" NICKEL | |
| -78SP6 | 75 OHM DIN 1.0/2.3 | PLUG | STRAIGHT | 30µ" GOLD | 30µ" GOLD | 100µ" NICKEL | |
| ** -79SP2 | 75 OHM MINI BNC | PLUG | STRAIGHT | 30µ" GOLD | 100µ" NICKEL | 100µ" NICKEL | SHT 5, FIG 8 |
| ** -79SP3 | 75 OHM MINI BNC | PLUG | STRAIGHT | 10µ" GOLD | 100µ" NICKEL | 100µ" NICKEL | |
| ** -79RP2 | 75 OHM MINI BNC | PLUG | RIGHT ANGLE | 30µ" GOLD | 100µ" NICKEL | 100µ" NICKEL | SHT 6, FIG 9 |
| ** -79RP3 | 75 OHM MINI BNC | PLUG | RIGHT ANGLE | 10µ" GOLD | 100µ" NICKEL | 100µ" NICKEL | |
| *-SING | SINGLE ENDED | - | - | - | - | - | - |
| *-XXXXXX | STRIPPED & TINNED | - | - | - | - | - | SHT 1, FIG 2 |

* = END OPTION ONLY

** = FOR EXISTING CUSTOMERS ONLY

TABLE 1

| END OPTION | SUBTRACTOR | STRIP DIMENSIONS | | | | HI POT | |
|------------|-------------|------------------|-------------|-----------------|------|--------|------|
| | | "Y" | "A" | "D" | "E" | "DC" | "AC" |
| -74RP3 | 4.7 [0.19] | 2.3 [0.09] | 12.1 [0.48] | 18.7 [0.74] | 1000 | 300 | |
| -74SP3 | 10.3 [0.41] | 3.2 [0.13] | 5.4 [0.21] | 11.9 [0.47] | 1000 | 300 | |
| -H4SP2 | 13.4 [0.53] | 2.7 [0.11] | 4.2 [0.17] | 11.0 [0.43] | 1000 | 300 | |
| -H4SP3 | | | | | | | |
| -H4SP4 | | | | | | | |
| -H4SP8 | | | | | | | |
| -D4SP3 | 10.3 [0.41] | 3.2 [0.13] | 5.4 [0.21] | 11.9 [0.47] | 1000 | 300 | |
| -78SP4 | 15.7 [0.62] | 2.9 [0.11] | 5.0 [0.20] | 12.3 [0.48] | 1000 | 300 | |
| -78SP5 | | | | | | | |
| -78SP6 | | | | | | | |
| ** -79SP2 | 8.7 [0.34] | 2.0 [0.08] | 2.6 [0.10] | 8.6 [0.34] | 1000 | 300 | |
| ** -79SP3 | | | | | | | |
| ** -79RP2 | 3.0 [0.12] | 1.7 [0.07] | 7.1 [0.28] | 13.7 [0.54] | 1000 | 300 | |
| ** -79RP3 | | | | | | | |
| *-SING | 0.0 [0.00] | - | - | - | 1000 | N/A | |
| *-XXXXXX | 0.0 [0.00] | "A" | "A" + "B" | "A" + "B" + "C" | 1000 | N/A | |

* = END 2 OPTION ONLY

** = FOR EXISTING CUSTOMERS ONLY

F:\DWG\MISC\MKTG\RFx6T-XXXXX-XXXXXX-XXXX-MKT.SLDDRW

PROPRIETARY NOTE
 THIS DOCUMENT CONTAINS CONFIDENTIAL AND PROPRIETARY INFORMATION AND ALL DESIGN, MANUFACTURING, REPRODUCTION, USE, PATENT RIGHTS AND SALES RIGHTS ARE EXPRESSLY RESERVED BY SAMTEC, INC. THIS DOCUMENT SHALL NOT BE DISCLOSED, IN WHOLE OR PART, TO ANY UNAUTHORIZED PERSON OR ENTITY NOR REPRODUCED, TRANSFERRED OR INCORPORATED IN ANY OTHER PROJECT IN ANY MANNER WITHOUT THE EXPRESS WRITTEN CONSENT OF SAMTEC, INC.



520 PARK EAST BLVD, NEW ALBANY, IN 47150
 PHONE: 812-944-6733 FAX: 812-948-5047
 e-Mail: info@SAMTEC.com code 55322

DO NOT SCALE DRAWING

SHEET SCALE: 1:1

DESCRIPTION:
 TRUE 75 OHM, RF6T CABLE ASSEMBLY
 DWG. NO.
RFx6T-XXXXX-XXXXXX-XXXX
 BY: R MUSSER 03/27/2009 SHEET 2 OF 8

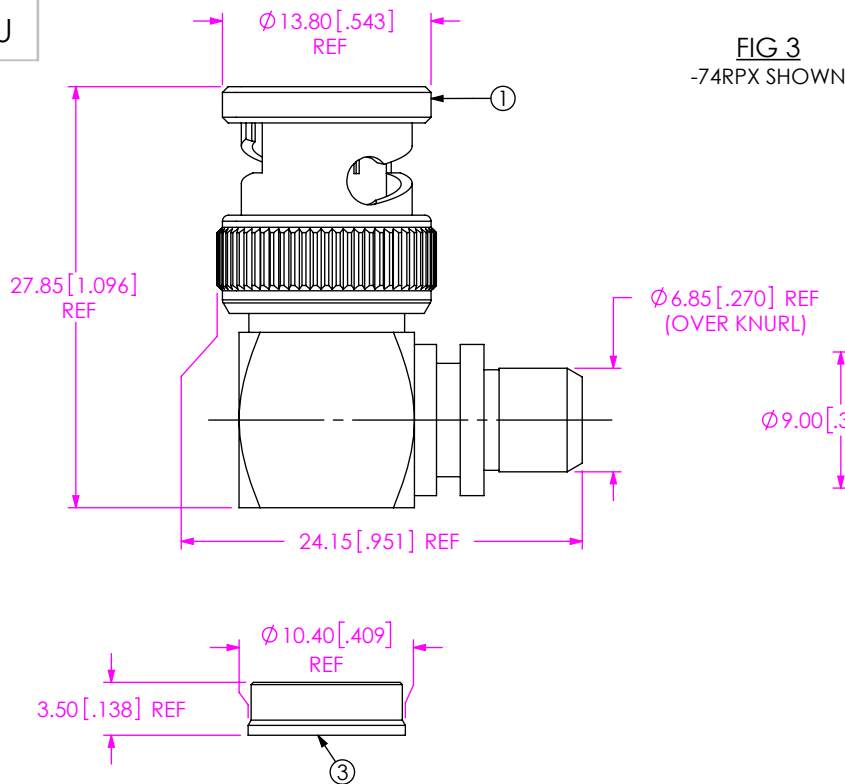

FIG 3
-74RPX SHOWN

| BOM | | |
|------|--------------|-------------------------|
| ITEM | COMPONENT | -74RP3 |
| 1 | SUB ASSEMBLY | SUB-BNC7T-P-C-GN-RA-CA6 |
| 2 | FERRULE | BNC-FER-001-N |
| 3 | CAP | BNC7T-P-C-N-RA-CA6-CAP |
| 4 | HEAT SHRINK | HST-0.500-02-BLK |

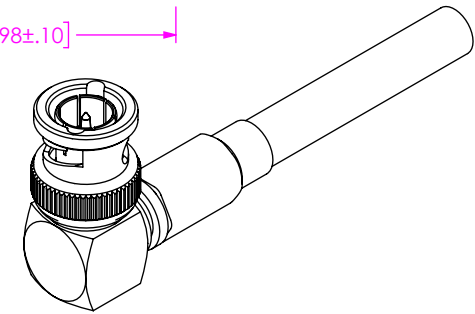
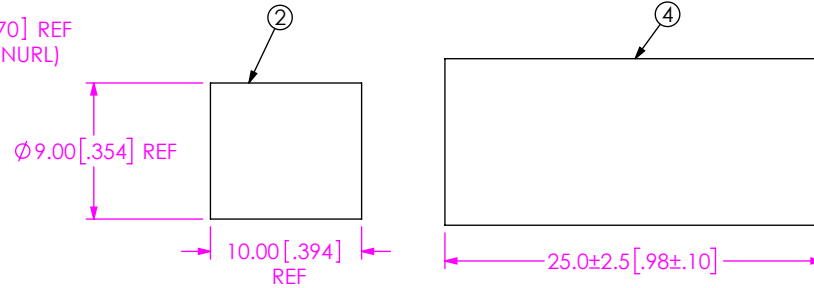
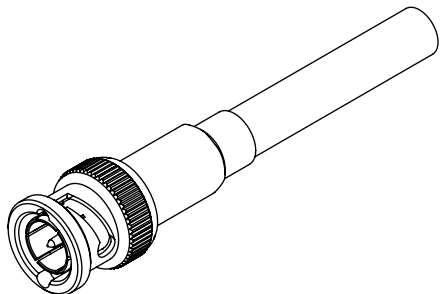
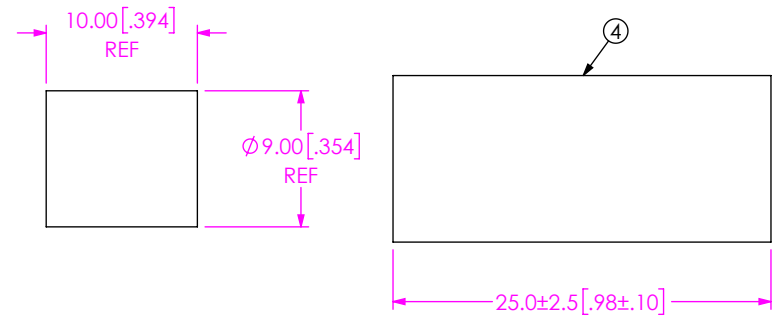
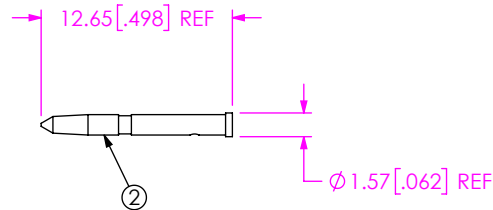
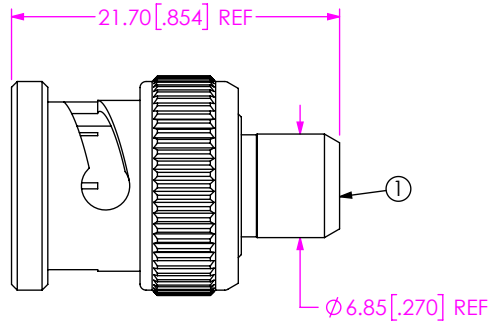

FIG 4
-74SPX SHOWN



| BOM | | |
|------|--------------|------------------------|
| ITEM | COMPONENT | -74SP3 |
| 1 | SUB-ASSEMBLY | SUB-BNC7T-P-C-N-ST-CA6 |
| 2 | PIN | BNC7T-P-C-G-ST-CA6-PIN |
| 3 | FERRULE | BNC-FER-001-N |
| 4 | HEAT SHRINK | HST-0.500-02-BLK |

F:\DWG\MISC\MKTG\RF6T-XXXX-XXXX-XXXX-MKT.SLDDRW

PROPRIETARY NOTE
THIS DOCUMENT CONTAINS CONFIDENTIAL AND PROPRIETARY INFORMATION AND ALL DESIGN, MANUFACTURING, REPRODUCTION, USE, PATENT RIGHTS AND SALES RIGHTS ARE EXPRESSLY RESERVED BY SAMTEC, INC. THIS DOCUMENT SHALL NOT BE DISCLOSED, IN WHOLE OR PART, TO ANY UNAUTHORIZED PERSON OR ENTITY NOR REPRODUCED, TRANSFERRED OR INCORPORATED IN ANY OTHER PROJECT IN ANY MANNER WITHOUT THE EXPRESS WRITTEN CONSENT OF SAMTEC, INC.

DO NOT SCALE DRAWING

SHEET SCALE: 2:1



520 PARK EAST BLVD, NEW ALBANY, IN 47150
PHONE: 812-944-6733 FAX: 812-948-5047
e-Mail info@SAMTEC.com code 55322

DESCRIPTION:
TRUE 75 OHM, RF6T CABLE ASSEMBLY

DWG. NO.
RFX6T-XXXXX-XXXXXX-XXXX

BY: R MUSSER 03/27/2009 SHEET 3 OF 8

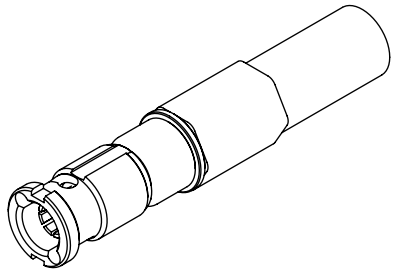
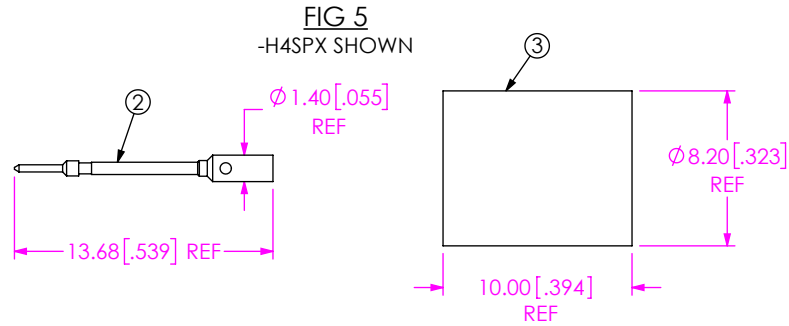
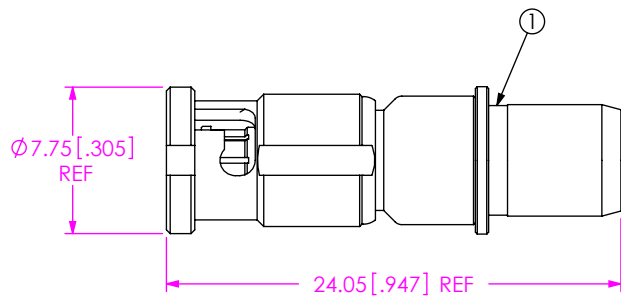

| BOM | | | | | |
|------|--------------|-------------------------|-------------------------|-------------------------|-------------------------|
| ITEM | COMPONENT | -H4SP2 | -H4SP3 | -H4SP4 | -H4SP8 |
| 1 | SUB ASSEMBLY | SUB-HDBNC-P-C-NN-ST-CA6 | SUB-HDBNC-P-C-NN-ST-CA6 | SUB-HDBNC-P-C-FN-ST-CA6 | SUB-HDBNC-P-C-FN-ST-CA6 |
| 2 | PIN | HDBNC-P-C-H-ST-CA6-PIN | HDBNC-P-C-G-ST-CA6-PIN | HDBNC-P-C-G-ST-CA6-PIN | HDBNC-P-C-H-ST-CA6-PIN |
| 3 | FERRULE | HDBNC-FER-001-N | | | |

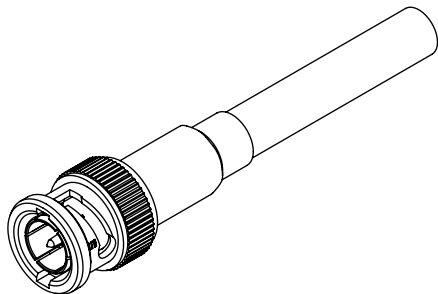
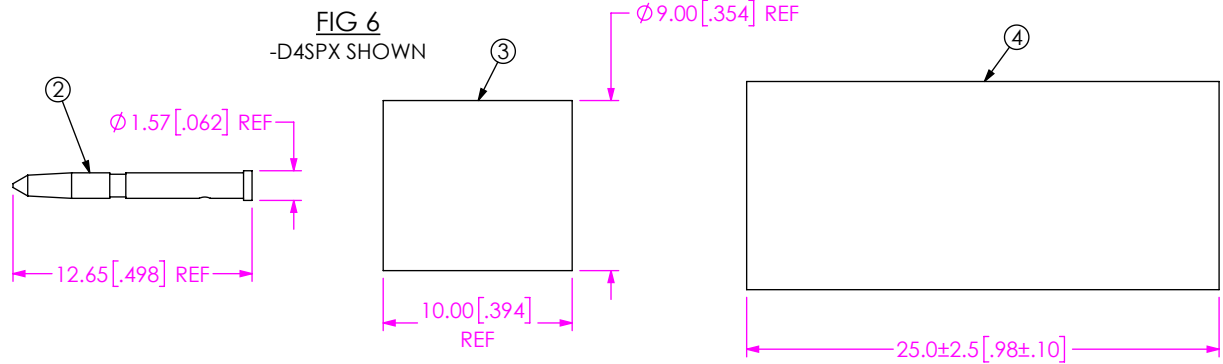
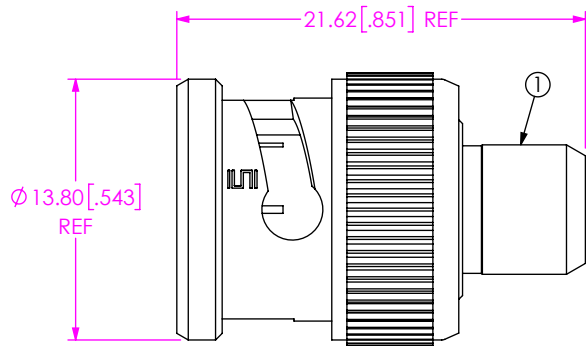

| BOM | | |
|------|--------------|-------------------------|
| ITEM | COMPONENT | -D4SP3 |
| 1 | SUB-ASSEMBLY | SUB-BNC7T-P-C-N-ST-CA6D |
| 2 | PIN | BNC7T-P-C-G-ST-CA6-PIN |
| 3 | FERRULE | BNC-FER-001-N |
| 4 | HEAT SHRINK | HST-0.500-02-BLK |

PROPRIETARY NOTE
 THIS DOCUMENT CONTAINS CONFIDENTIAL AND PROPRIETARY INFORMATION AND ALL DESIGN, MANUFACTURING, REPRODUCTION, USE, PATENT RIGHTS AND SALES RIGHTS ARE EXPRESSLY RESERVED BY SAMTEC, INC. THIS DOCUMENT SHALL NOT BE DISCLOSED, IN WHOLE OR PART, TO ANY UNAUTHORIZED PERSON OR ENTITY NOR REPRODUCED, TRANSFERRED OR INCORPORATED IN ANY OTHER PROJECT IN ANY MANNER WITHOUT THE EXPRESS WRITTEN CONSENT OF SAMTEC, INC.

DO NOT SCALE DRAWING

SHEET SCALE: 2.5:1



520 PARK EAST BLVD, NEW ALBANY, IN 47150
 PHONE: 812-944-6733 FAX: 812-948-5047
 e-Mail info@SAMTEC.com code 55322

DESCRIPTION:
 TRUE 75 OHM, RF6T CABLE ASSEMBLY

DWG. NO.
 RFX6T-XXXXX-XXXXXX-XXXX

BY:R MUSSER 03/27/2009 SHEET 4 OF 8

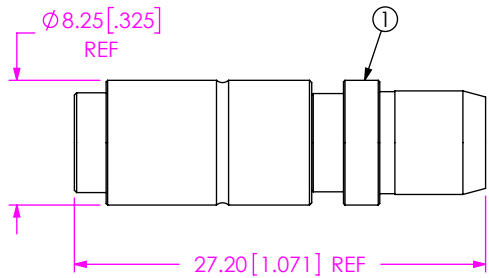
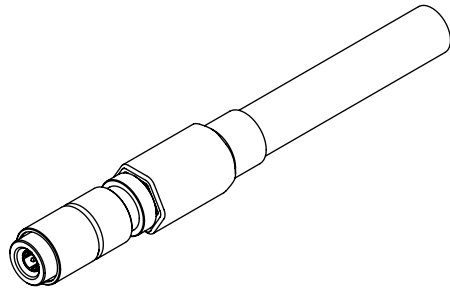
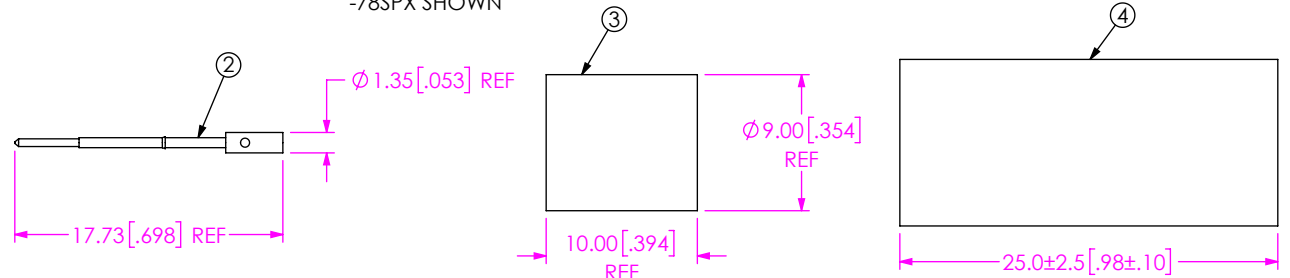

FIG 7
-78SPX SHOWN



| BOM | | | | |
|------|--------------|--------------------------|--------------------------|--------------------------|
| ITEM | COMPONENT | -78SP4 | -78SP5 | -78SP6 |
| 1 | SUB ASSEMBLY | SUB-DIN7A-PP-C-FN-ST-CA6 | SUB-DIN7A-PP-C-GN-ST-CA6 | SUB-DIN7A-PP-C-HN-ST-CA6 |
| 2 | PIN | DIN7A-P-C-G-ST-CA6-PIN | DIN7A-P-C-G-ST-CA6-PIN | DIN7A-P-C-H-ST-CA6-PIN |
| 3 | FERRULE | BNC-FER-001-N | | |
| 4 | HEAT SHRINK | HST-0.500-02-BLK | | |

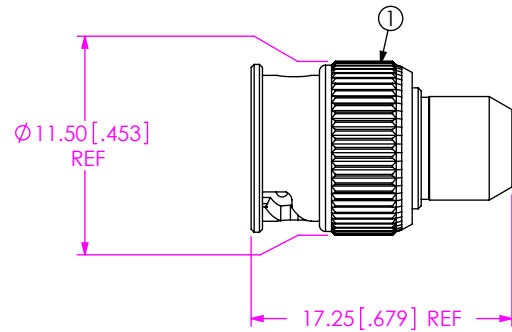
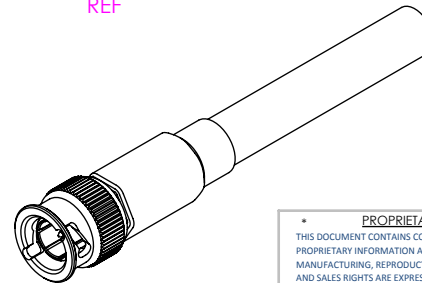
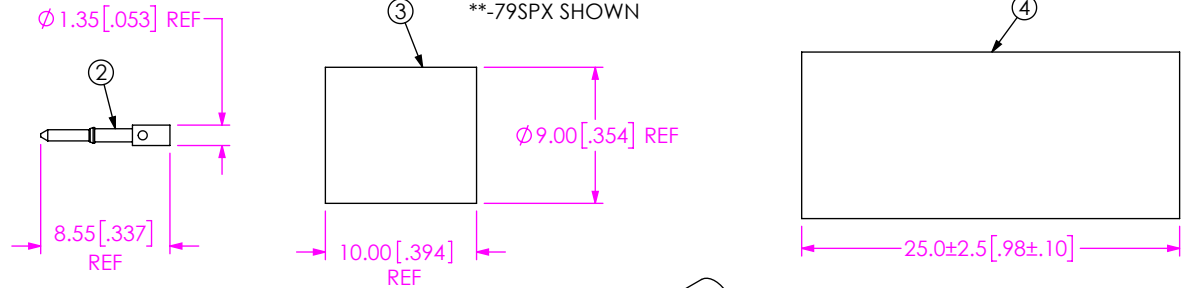

FIG 8
**-79SPX SHOWN



| BOM | | | |
|------|--------------|------------------------|------------------------|
| ITEM | COMPONENT | ** -79SP2 | ** -79SP3 |
| 1 | SUB ASSEMBLY | SUB-MBNC7-P-C-N-ST-CA6 | |
| 2 | PIN | MBNC7-P-C-H-ST-CA6-PIN | MBNC7-P-C-G-ST-CA6-PIN |
| 3 | FERRULE | BNC-FER-001-N | |
| 4 | HEAT SHRINK | HST-0.500-02-BLK | |

** = FOR EXISTING CUSTOMERS ONLY

PROPRIETARY NOTE
THIS DOCUMENT CONTAINS CONFIDENTIAL AND PROPRIETARY INFORMATION AND ALL DESIGN, MANUFACTURING, REPRODUCTION, USE, PATENT RIGHTS AND SALES RIGHTS ARE EXPRESSLY RESERVED BY SAMTEC, INC. THIS DOCUMENT SHALL NOT BE DISCLOSED, IN WHOLE OR PART, TO ANY UNAUTHORIZED PERSON OR ENTITY NOR REPRODUCED, TRANSFERRED OR INCORPORATED IN ANY OTHER PROJECT IN ANY MANNER WITHOUT THE EXPRESS WRITTEN CONSENT OF SAMTEC, INC.



520 PARK EAST BLVD, NEW ALBANY, IN 47150
PHONE: 812-944-6733 FAX: 812-948-5047
e-Mail info@SAMTEC.com code 55322

DO NOT SCALE DRAWING

SHEET SCALE: 2:1

DESCRIPTION:
TRUE 75 OHM, RF6T CABLE ASSEMBLY

DWG. NO.
RFX6T-XXXXX-XXXXXX-XXXX

BY: R MUSSER 03/27/2009 SHEET 5 OF 8

FIG 9
**-79RPX SHOWN

| BOM | | | |
|------|--------------|-------------------------|-------------------------|
| ITEM | COMPONENT | ** -79RP2 | ** -79RP3 |
| 1 | SUB ASSEMBLY | SUB-MBNC7-P-C-HN-RA-CA6 | SUB-MBNC7-P-C-GN-RA-CA6 |
| 2 | FERRULE | BNC-FER-001-N | |
| 3 | CAP | MBNC7-P-C-N-RA-CAP | |
| 4 | HEAT SHRINK | HST-0.500-02-BLK | |

** = FOR EXISTING CUSTOMERS ONLY

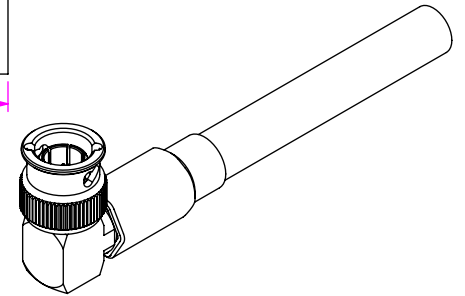
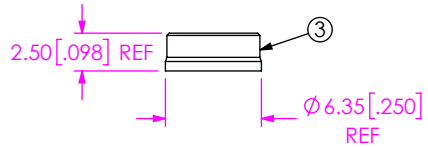
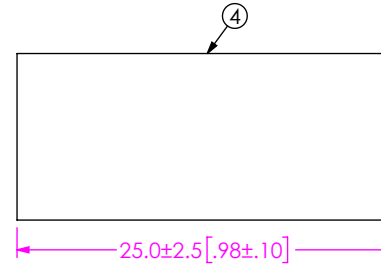
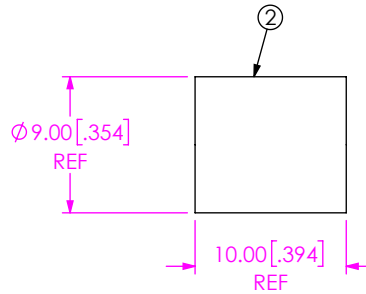
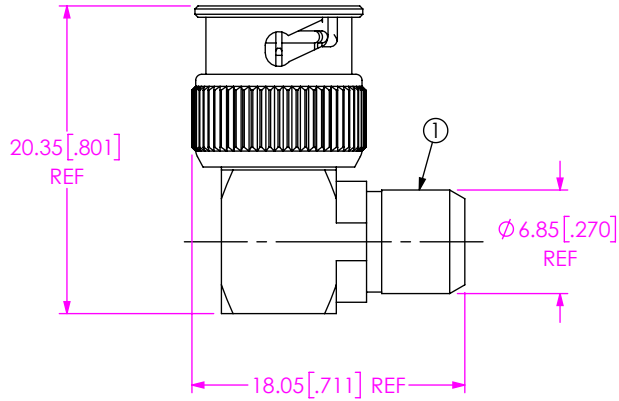

PROPRIETARY NOTE
THIS DOCUMENT CONTAINS CONFIDENTIAL AND PROPRIETARY INFORMATION AND ALL DESIGN, MANUFACTURING, REPRODUCTION, USE, PATENT RIGHTS AND SALES RIGHTS ARE EXPRESSLY RESERVED BY SAMTEC, INC. THIS DOCUMENT SHALL NOT BE DISCLOSED, IN WHOLE OR PART, TO ANY UNAUTHORIZED PERSON OR ENTITY NOR REPRODUCED, TRANSFERRED OR INCORPORATED IN ANY OTHER PROJECT IN ANY MANNER WITHOUT THE EXPRESS WRITTEN CONSENT OF SAMTEC, INC.



520 PARK EAST BLVD, NEW ALBANY, IN 47150
PHONE: 812-944-6733 FAX: 812-948-5047
e-Mail info@SAMTEC.com code 55322

DO NOT SCALE DRAWING
SHEET SCALE: 2:1

DESCRIPTION:
TRUE 75 OHM, RF6T CABLE ASSEMBLY
DWG. NO.
RFX6T-XXXXXX-XXXXXX-XXXX
BY: R MUSSER 03/27/2009 SHEET 6 OF 8

IN PROCESS 1
CUT CABLE TO LENGTH

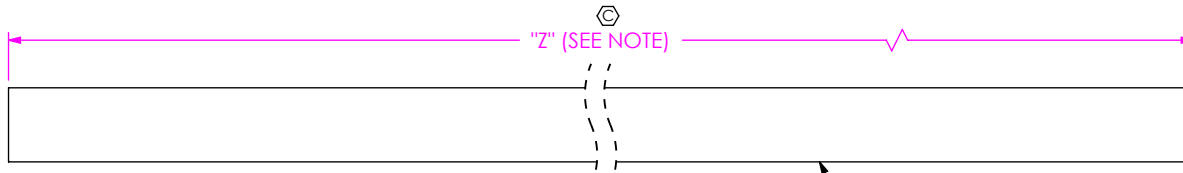

NOTE: "Z" = 2*OAL - 2*"Y"(END 1)) (FOR -SING OR -XXXXXX OPTIONS)
"Z" = OAL - "Y"(END 1) - "Y"(END 2) (FOR DOUBLE ENDED OPTIONS)

SEE TABLE

| TABLE | |
|---------------|-------------|
| CABLE CALLOUT | PART NUMBER |
| RFA6T | CCA-6 |
| RFB6T | CCA-1694A |

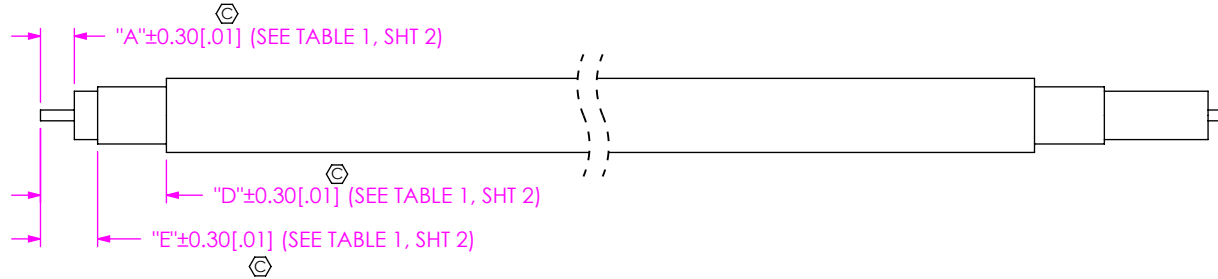

IN PROCESS 2
STRIP AND TIN INNER CONDUCTOR

STRAIGHT
IN PROCESS 3
ADD FERRULE & HEAT SHRINK TUBE (IF APPLICABLE),
SOLDER SIGNAL PIN
USING INDUCTION SOLDERING

RIGHT ANGLE
IN PROCESS 3
ADD FERRULE & HEAT SHRINK TUBE,
FLARE SHIELD, ADD SUB ASSEMBLY
(CABLE FOIL WRAP TO BE INSERTED
INSIDE CABLE BODY)
(SEE NOTE 6)

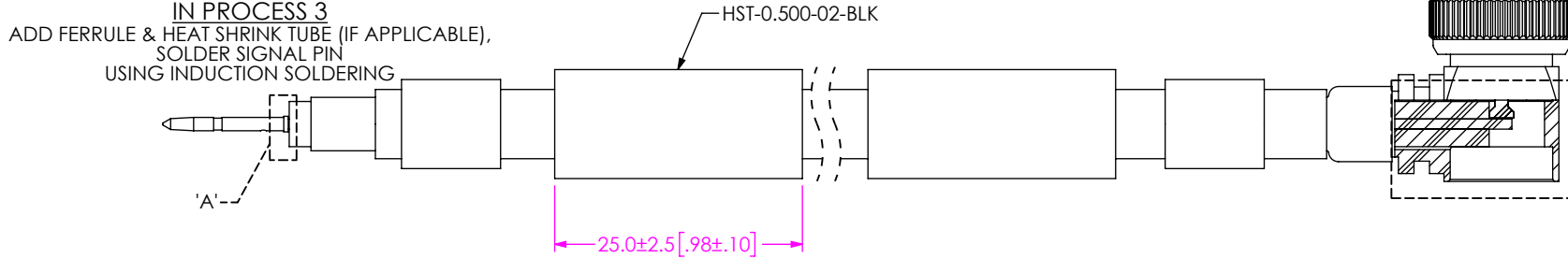

STRAIGHT
IN PROCESS 4
FLARE SHIELD,
ADD SUB ASSEMBLY
(CABLE FOIL WRAP TO BE INSERTED
INSIDE CABLE BODY)
(SEE NOTE 6)

RIGHT ANGLE
IN-PROCESS 4
CRIMP FERRULE &
SOLDER SIGNAL PIN

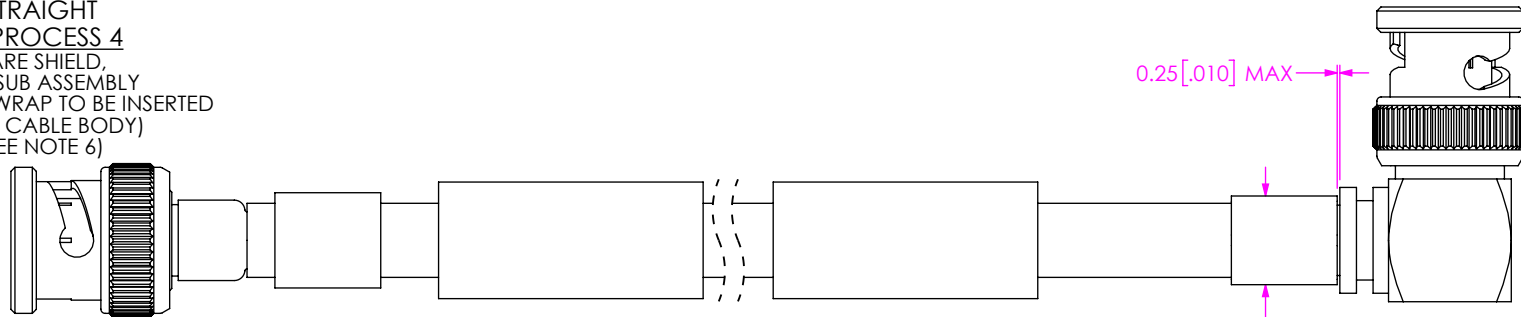

0.10 [.004] MAX

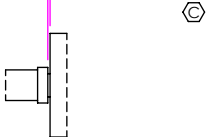

DETAIL 'A'
SCALE 3 : 1

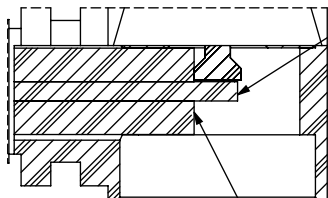

DETAIL 'B'
SCALE 2.5 : 1

CABLE CENTER CONDUCTOR
SHOULD NOT PROTRUDE
OUTSIDE CONTACT CUP

END OF CABLE DIELECTRIC
SHOULD SEAT AGAINST
CONTACT CUP

PROPRIETARY NOTE
THIS DOCUMENT CONTAINS CONFIDENTIAL AND
PROPRIETARY INFORMATION AND ALL DESIGN,
MANUFACTURING, REPRODUCTION, USE, PATENT RIGHTS
AND SALES RIGHTS ARE EXPRESSLY RESERVED BY SAMTEC,
INC. THIS DOCUMENT SHALL NOT BE DISCLOSED, IN WHOLE
OR PART, TO ANY UNAUTHORIZED PERSON OR ENTITY NOR
REPRODUCED, TRANSFERRED OR INCORPORATED IN ANY
OTHER PROJECT IN ANY MANNER WITHOUT THE EXPRESS
WRITTEN CONSENT OF SAMTEC, INC.



520 PARK EAST BLVD, NEW ALBANY, IN 47150
PHONE: 812-944-6733 FAX: 812-948-5047
e-Mail info@SAMTEC.com code 55322

DO NOT SCALE DRAWING

SHEET SCALE: 1.4:1

DESCRIPTION:
TRUE 75 OHM, RF6T CABLE ASSEMBLY

DWG. NO.
RFX6T-XXXXX-XXXXXX-XXXX

BY: R MUSSER 03/27/2009 SHEET 7 OF 8

STRAIGHT
IN-PROCESS 5
CRIMP FERRULE

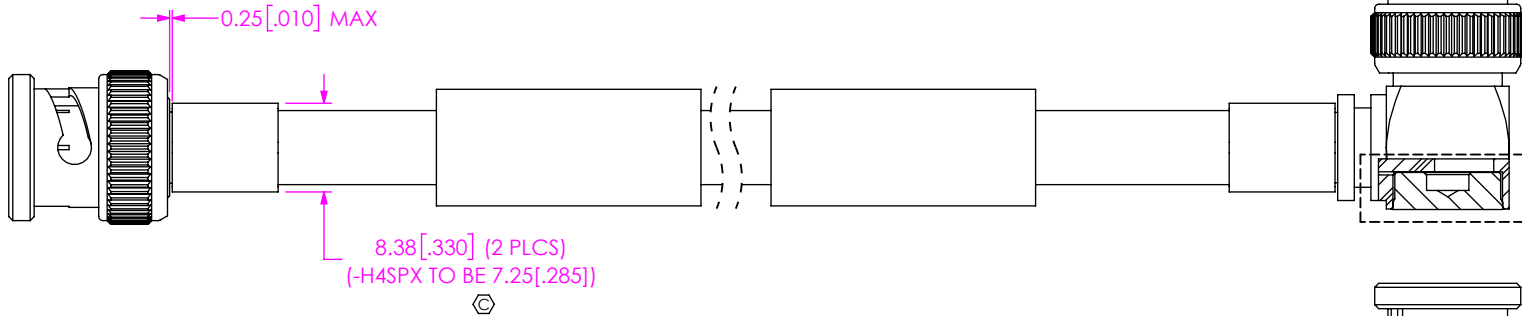

RIGHT ANGLE
IN-PROCESS 5
INSERT CAP

STRAIGHT
IN PROCESS 6
ACTIVATE HEAT SHRINK
(IF APPLICABLE)

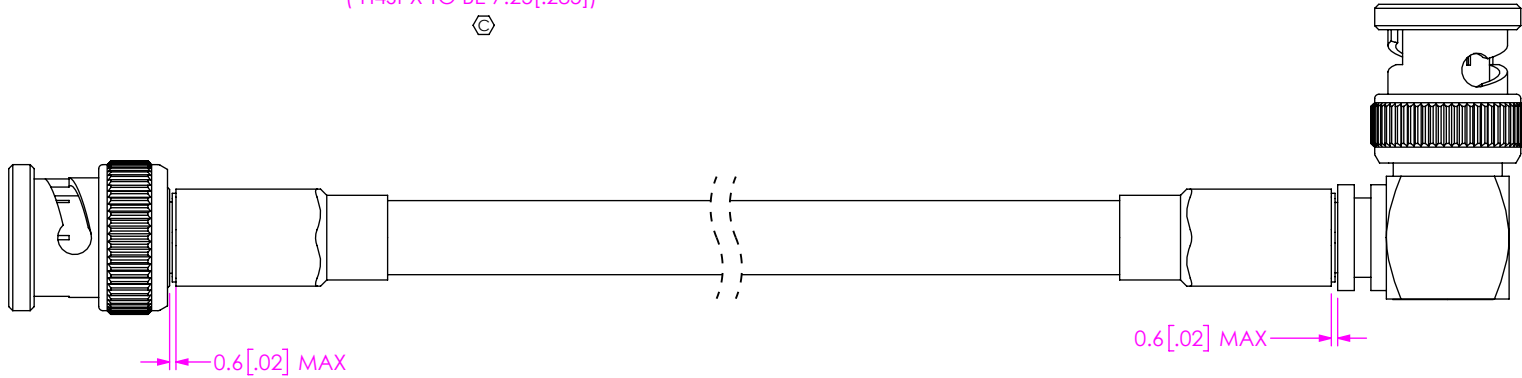

RIGHT ANGLE
IN-PROCESS 6
ACTIVATE HEAT SHRINK

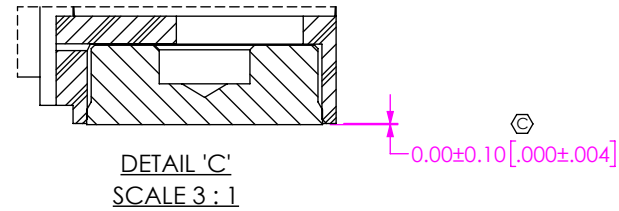

F:\DWG\MISC\MKTG\RFX6T-XXXXX-XXXXX-XXXX-MKT.SLDDRW

PROPRIETARY NOTE
THIS DOCUMENT CONTAINS CONFIDENTIAL AND PROPRIETARY INFORMATION AND ALL DESIGN, MANUFACTURING, REPRODUCTION, USE, PATENT RIGHTS AND SALES RIGHTS ARE EXPRESSLY RESERVED BY SAMTEC, INC. THIS DOCUMENT SHALL NOT BE DISCLOSED, IN WHOLE OR PART, TO ANY UNAUTHORIZED PERSON OR ENTITY NOR REPRODUCED, TRANSFERRED OR INCORPORATED IN ANY OTHER PROJECT IN ANY MANNER WITHOUT THE EXPRESS WRITTEN CONSENT OF SAMTEC, INC.



520 PARK EAST BLVD, NEW ALBANY, IN 47150
PHONE: 812-944-6733 FAX: 812-948-5047
e-Mail info@SAMTEC.com code 55322

DO NOT SCALE DRAWING

SHEET SCALE: 1.4:1

DESCRIPTION:
TRUE 75 OHM, RF6T CABLE ASSEMBLY

DWG. NO.
RFX6T-XXXXX-XXXXXX-XXXX

BY: R MUSSER 03/27/2009 SHEET 8 OF 8