

LOC	DIST	REVISIONS					
		P	LTN	DESCRIPTION	DATE	DWN	APVD
GP	00	A		PRODUCTION RELEASE	03FEB2016	JW	SH
		A1		REVISED PER ECR-18-017552	07NOV2016	IT	SH

1. MATERIAL:
 CAGE - 0.25mm THICK NICKEL SILVER ALLOY
 HEATSINK - ALUMINUM
 HEATSINK CLIP - STAINLESS STEEL
 EMI SPRING(S) - COPPER ALLOY

2. FINISH:
 HEATSINK - ELECTROLESS NICKEL
 HEATSINK CLIP - PASSIVATE
 EMI SPRING(S) - 0.8um MIN MATTE TIN OVER 0.8um MIN NICKEL,
 NON-PLATED EDGES PERMISSIBLE.

3. MATES WITH SFP MSA COMPLIANT TRANSCEIVERS.

4. PADS AND VIAS CHASSIS GROUND.

5. DATUM AND BASIC DIMENSION ESTABLISHED BY CUSTOMER.

6. MINIMUM PC BOARD THICKNESS:
 SINGLE SIDED = 1.50mm
 DOUBLE SIDED = 3.00mm

7. REFERENCE APPLICATION SPEC. 114-13120, HOLE A, FOR
 RECOMMENDED DRILL HOLE DIAMETER AND PLATING THICKNESS.

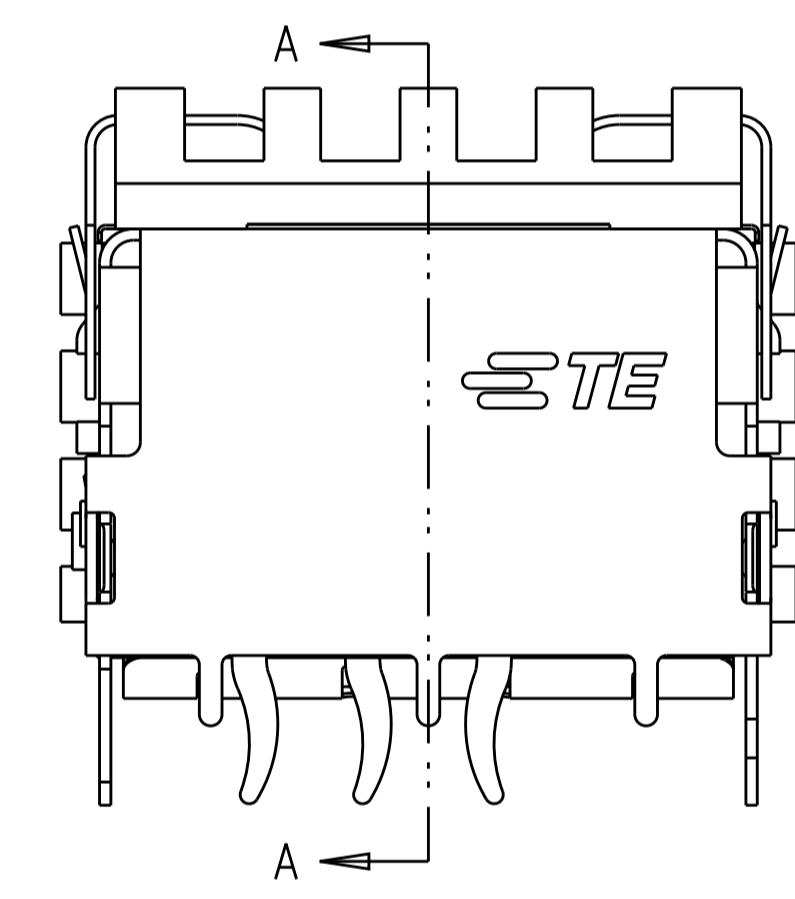
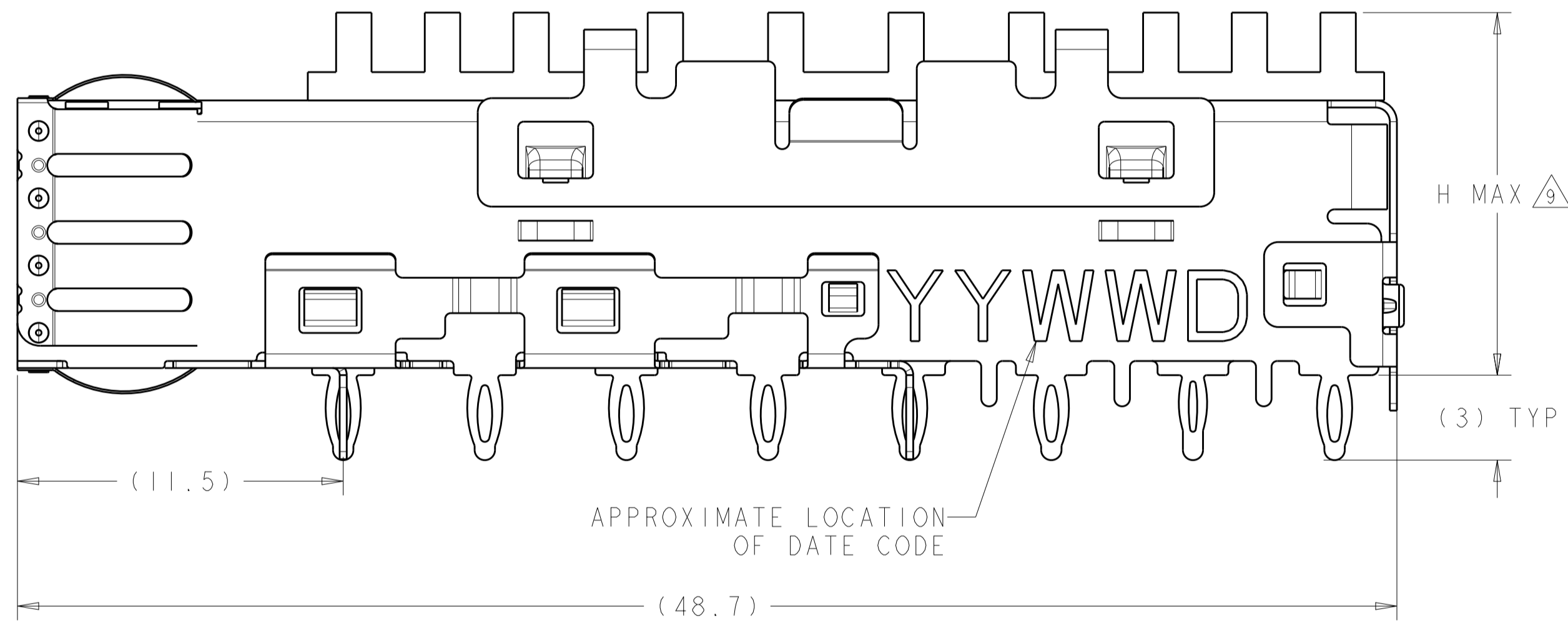
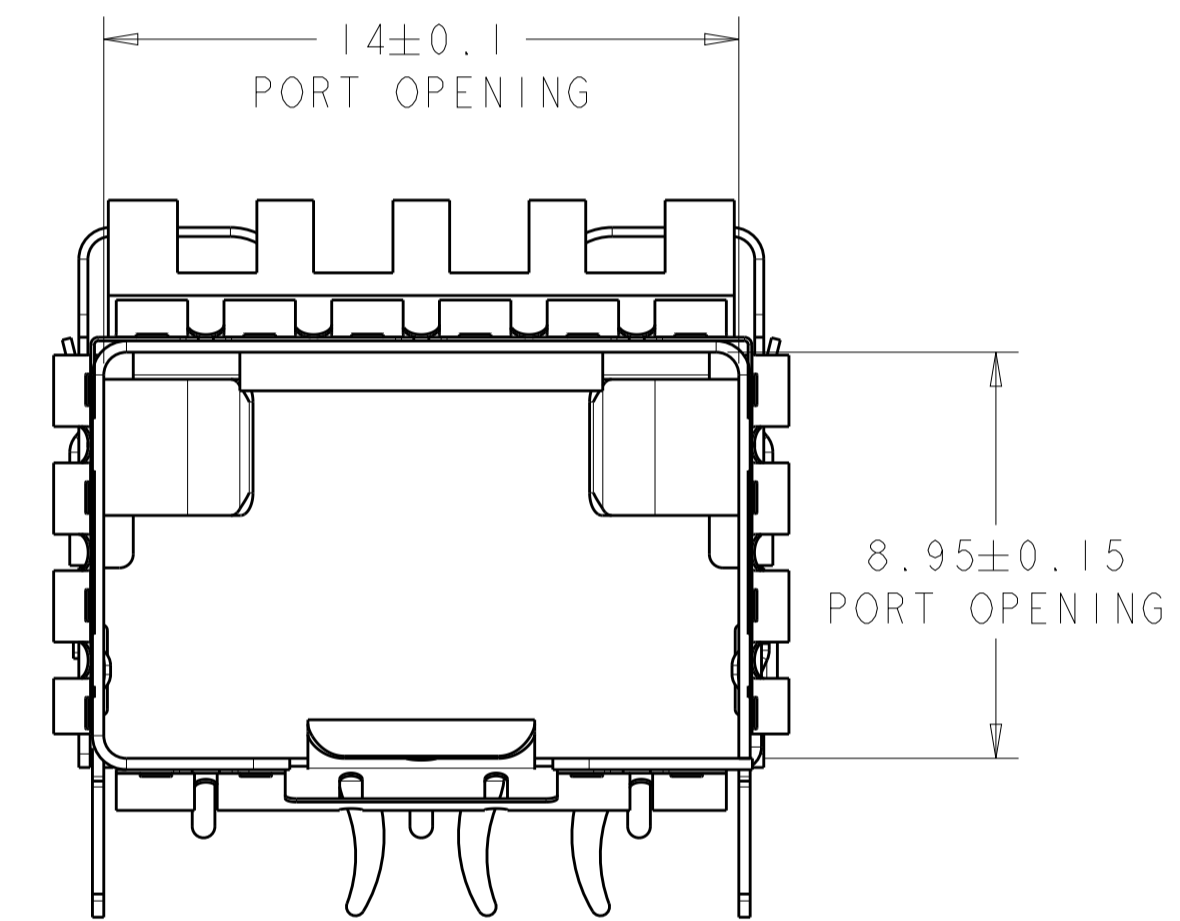
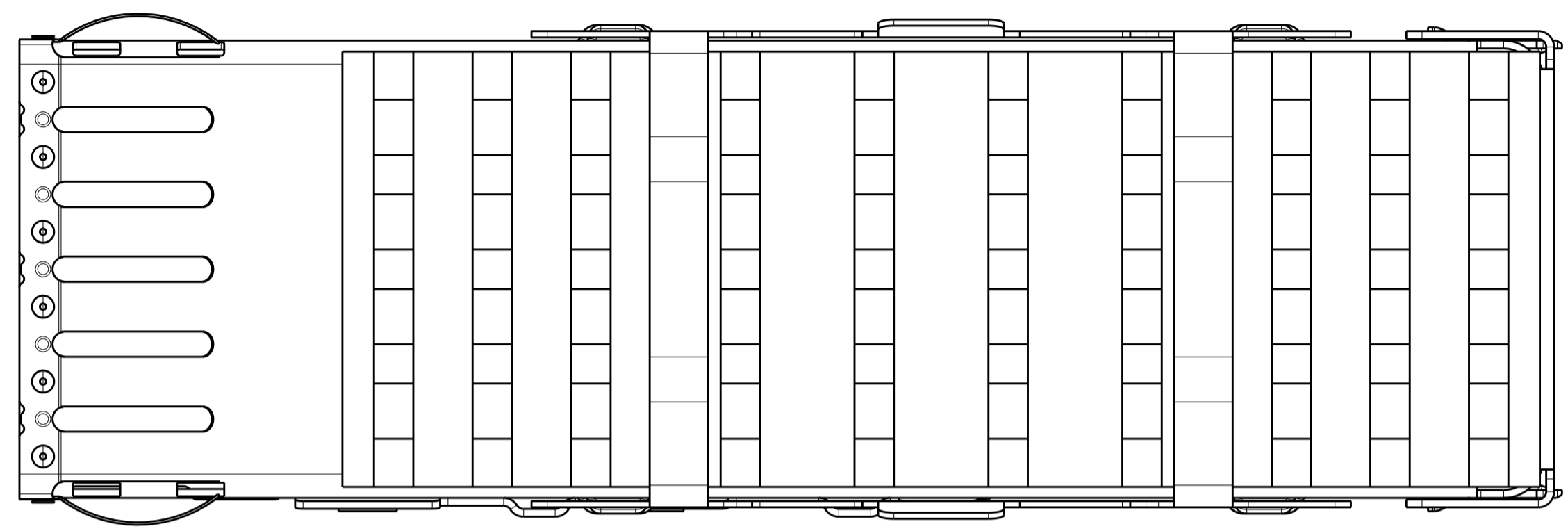
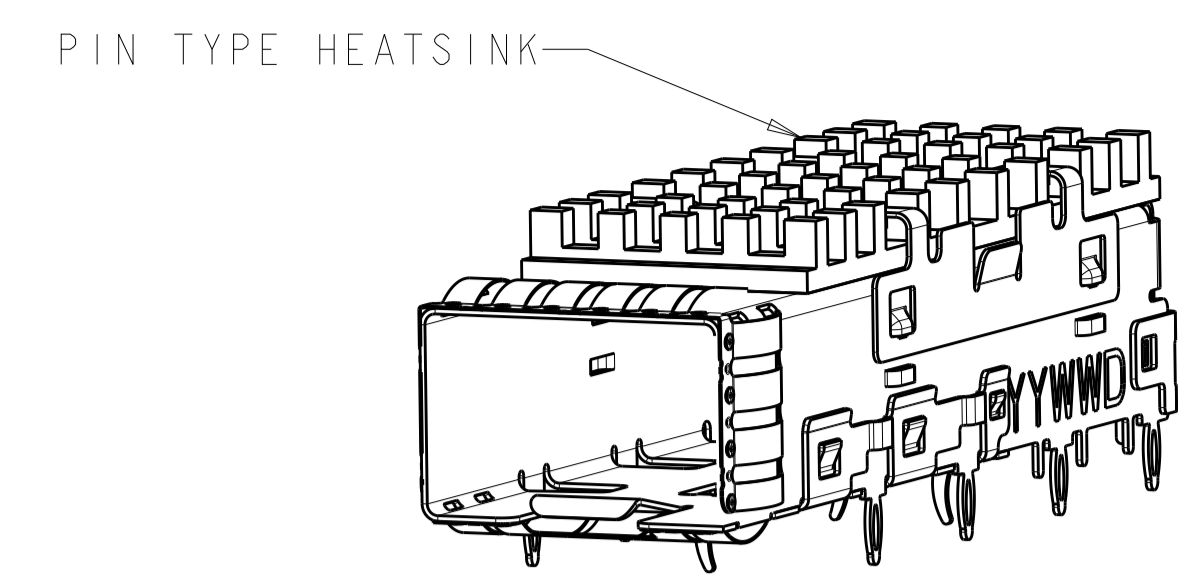
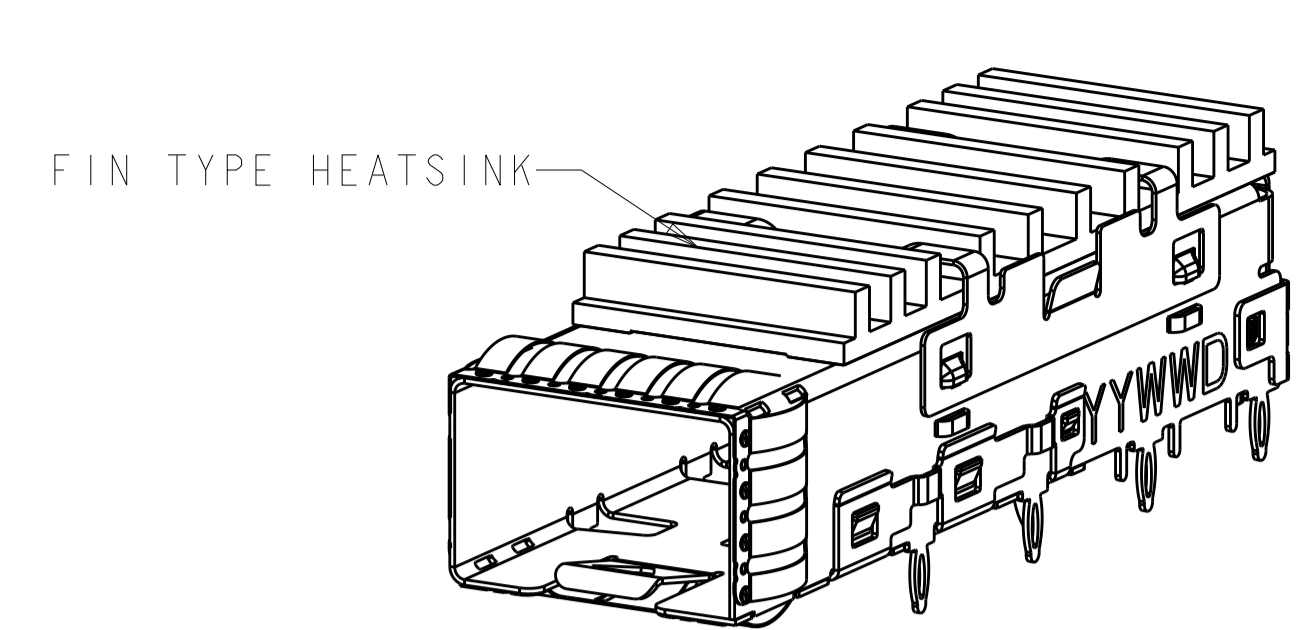

8. REFERENCE APPLICATION SPEC. 114-13120, HOLE C, FOR
 RECOMMENDED DRILL HOLE DIAMETER AND PLATING THICKNESS.

9. DIMENSION APPLIES PRIOR TO INSERTION OF SFP MODULE.

10. CAGE ASSEMBLY, HEATSINK CLIP AND HEATSINK SHIPPED
 ASSEMBLED.

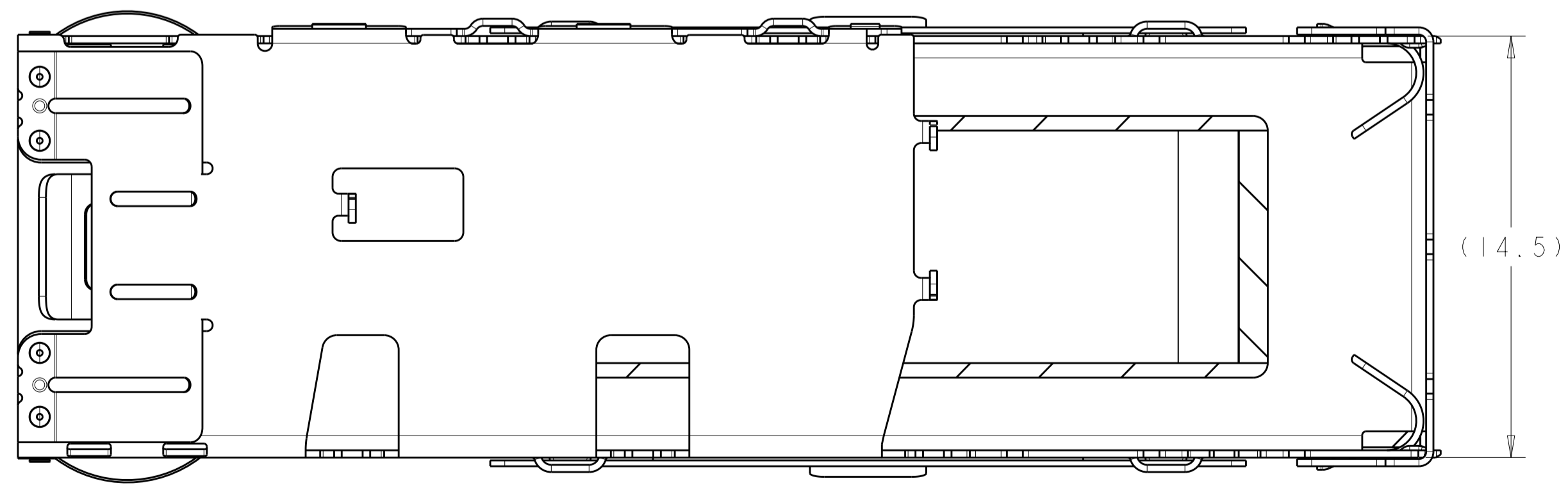

WITHOUT	WITH	INSULATING TAPE	H MAX	DIM A	HEAT SINK TYPE	PART NUMBER
13.5	22.8				FIN TYPE	1-2291634-0
13.5	22.8				PIN TYPE	2291634-9
22.8	22.8				FIN TYPE	2291634-8
22.8	22.8				FIN TYPE	2291634-7
15.8	22.8				FIN TYPE	2291634-6
13.5	22.8				FIN TYPE	2291634-5
22.8	22.8				PIN TYPE	2291634-4
22.8	22.8				PIN TYPE	2291634-3
15.8	22.8				PIN TYPE	2291634-2
13.5	22.8				PIN TYPE	2291634-1

THIS DRAWING IS A CONTROLLED DOCUMENT.

OWN: PETER PAN 17MAR2015
 CHK: SEAN HAN 17MAR2015
 APVD: SEAN HAN 17MAR2015

DIMENSIONS: mm
 TOLERANCES UNLESS OTHERWISE SPECIFIED:
 0 PLC ±0.1
 1 PLC ±0.1
 2 PLC ±0.1
 3 PLC ±0.05
 4 PLC ±0.05
 ANGLES ±0.05

MATERIAL: FINISH:

NAME: SFP+ IXI CAGE ASSEMBLY, PRESS-FIT PRESS-FIT, EMI SPRINGS WITH HEATSINK
 PRODUCT SPEC: 108-2364
 APPLICATION SPEC: 114-13120
 SIZE: A1
 CAGE CODE: 00779
 DRAWING NO: C=2291634
 WEIGHT: -
 CUSTOMER DRAWING

SCALE: 6:1 SHEET 1 OF 4 REV A1

LOC	DIST	REVISIONS			
P	LTN	DESCRIPTION	DATE	DMN	APVD
GP	00	SEE SHEET 1	-	-	-

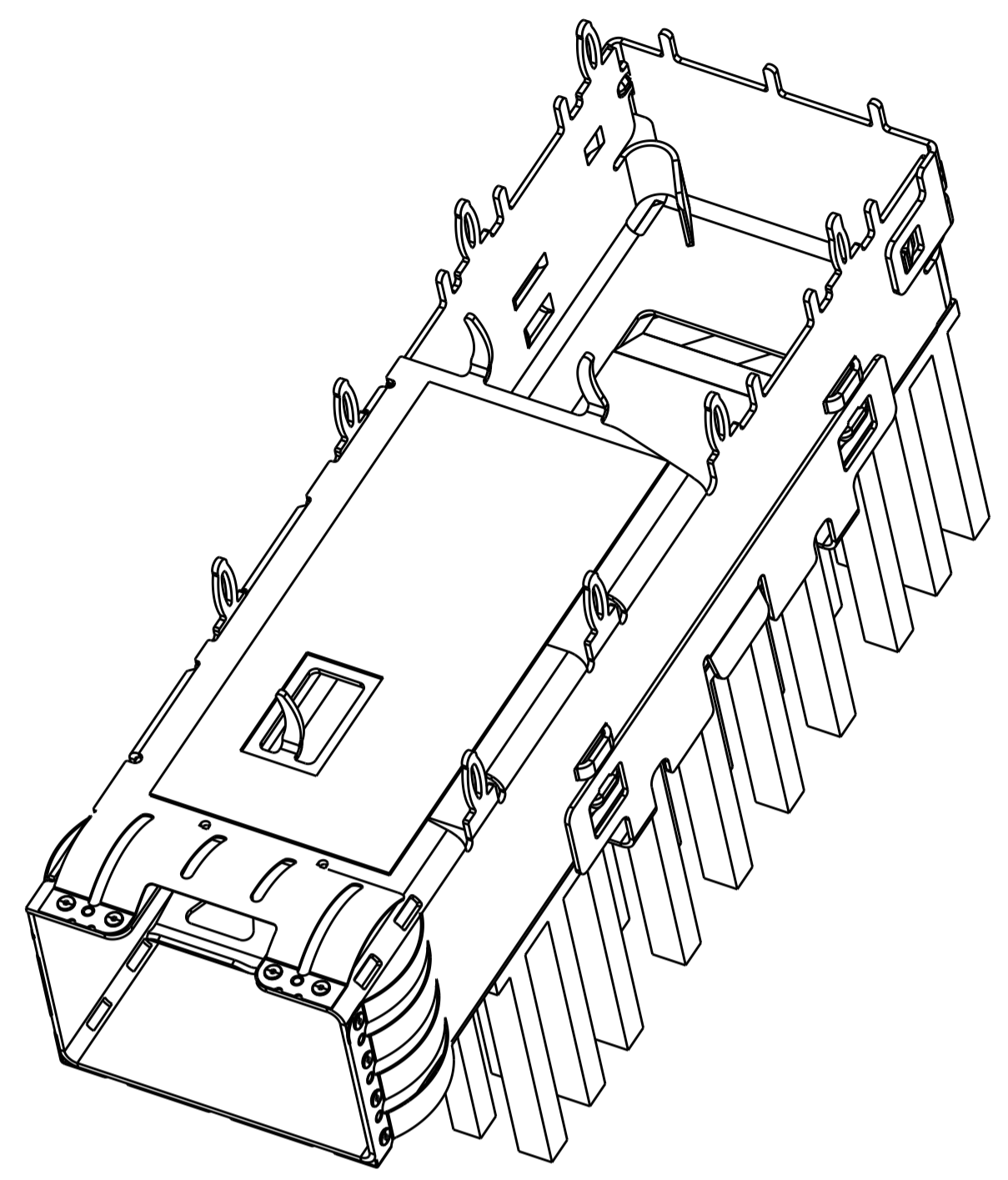

SCALE 4:1

2291634-4 AS SHOWN WITH INSULATING TAPE, PIN TYPE HEAT SINK
 2291634-1, 2, 3, 9 WITHOUT INSULATING TAPE, TAPE, PIN TYPE HEAT SINK

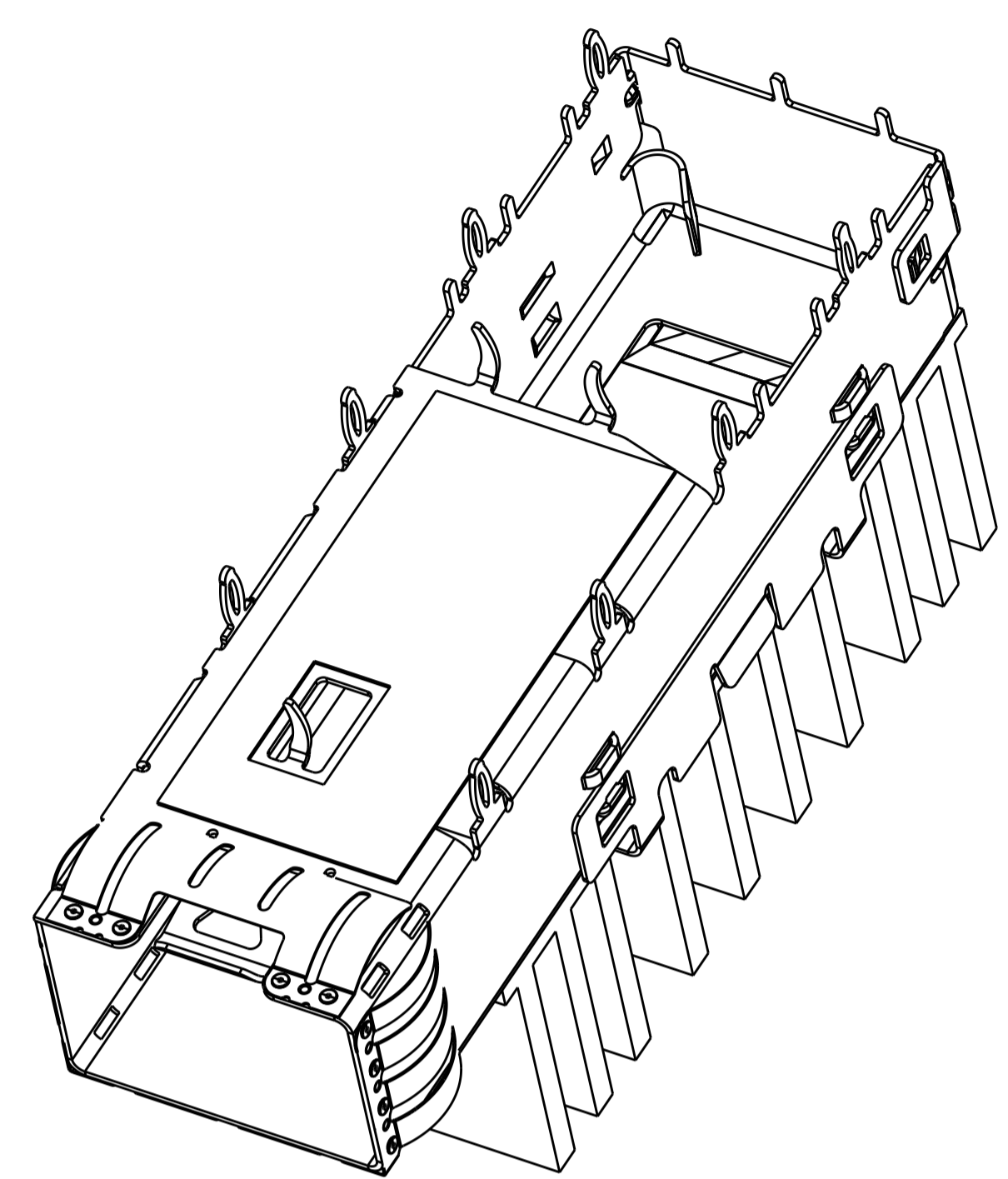

2291634-8 AS SHOWN WITH INSULATING TAPE, WITH FIN TYPE HEAT SINK
 2291634-5, 6, 7 WITHOUT INSULATING TAPE, WITH FIN TYPE HEAT SINK

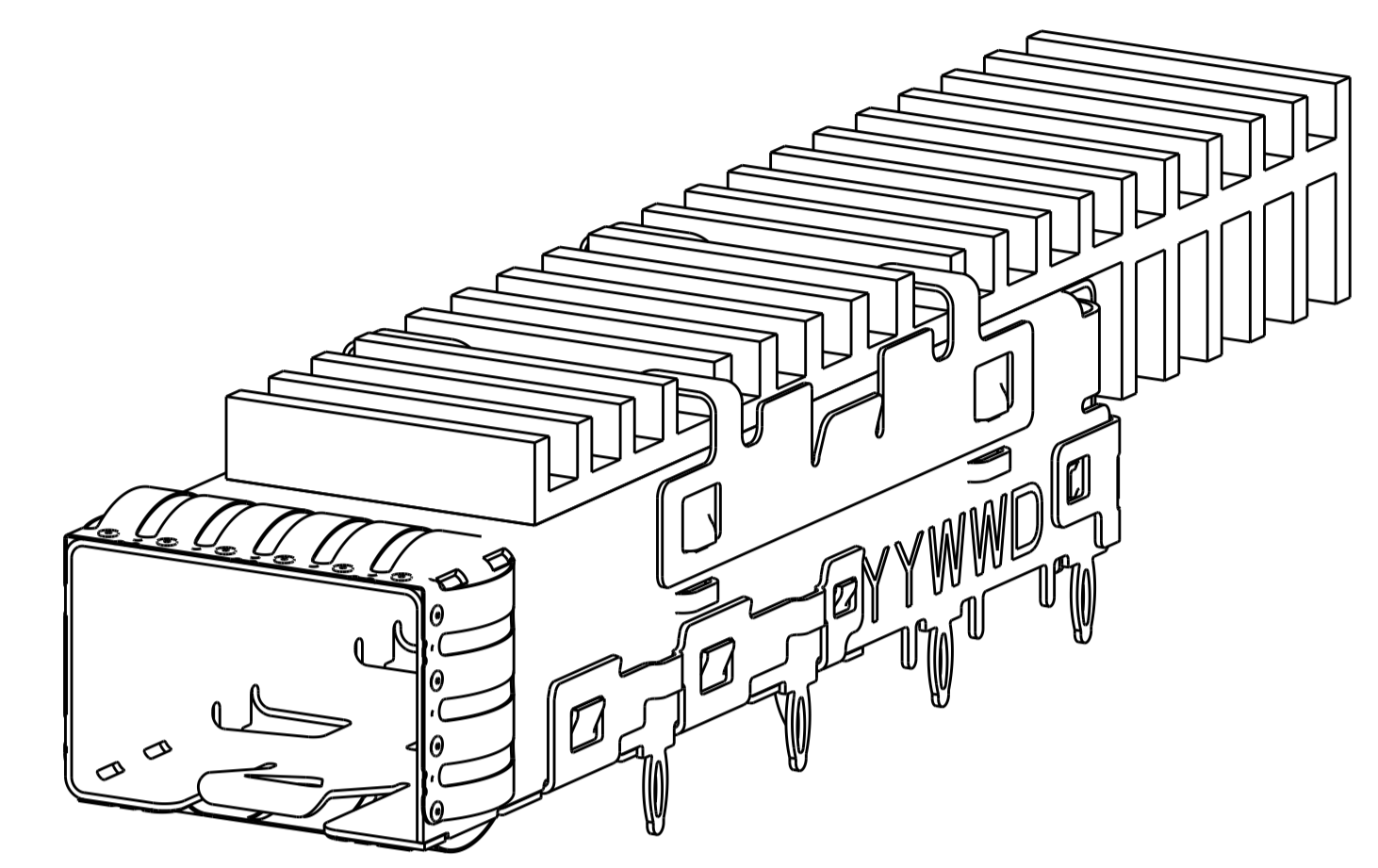

1-2291634-0 AS SHOWN WITHOUT INSULATING TAPE, WITH EXTEND FIN TYPE HEAT SINK

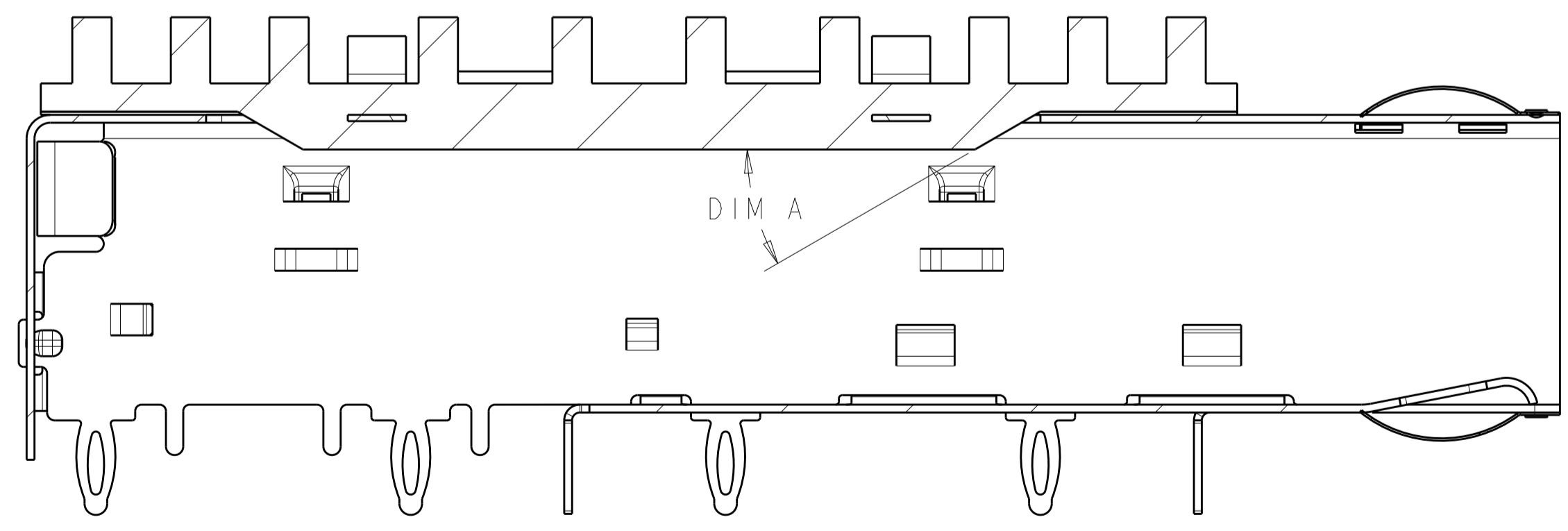

SECTION A-A

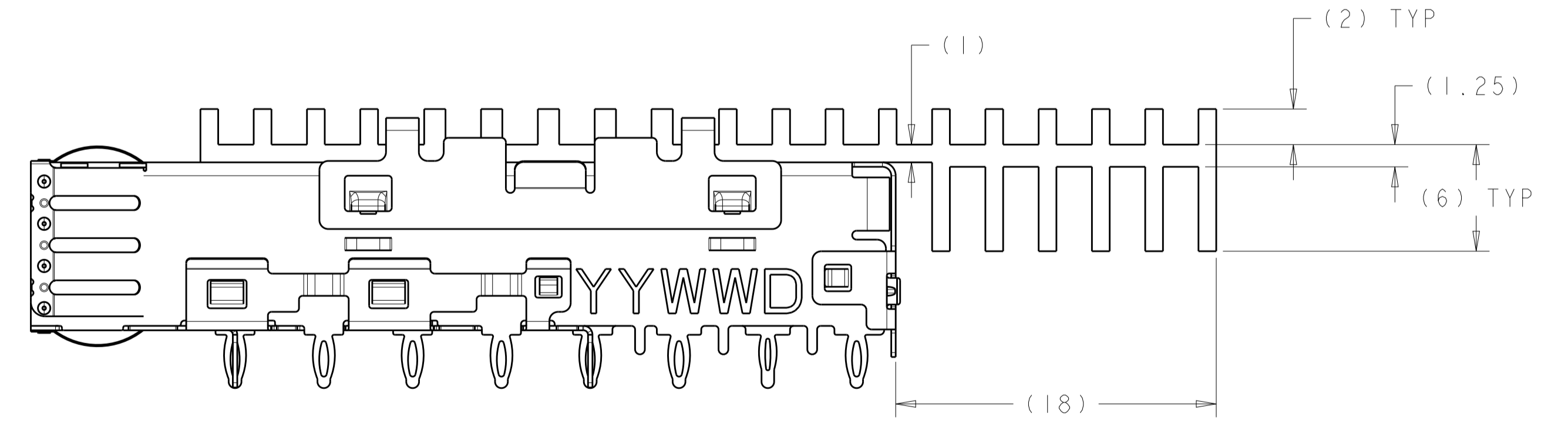

1-2291634-0 AS SHOWN EXCEPT HEATSINK SAME AS 2291634-1

THIS DRAWING IS A CONTROLLED DOCUMENT.		DMN: PETER PAN 17MAR2015	TE Connectivity
DIMENSIONS:		CHK: SEAN HAN 17MAR2015	
mm		APVD: SEAN HAN 17MAR2015	
TOLERANCES UNLESS OTHERWISE SPECIFIED: 0 PLC ±0.1 1 PLC ±0.1 2 PLC ±0.1 3 PLC ±0.1 4 PLC ±0.05 ANGLES ±0.05		NAME: SFP+ 1X1 CAGE ASSEMBLY, PRESS-FIT PRESS-FIT, EMI SPRINGS WITH HEATSINK PRODUCT SPEC: 108-2364 APPLICATION SPEC: 114-13120 WEIGHT: - FINISH: -	
MATERIAL:		RESTRICTED TO:	SIZE: A1 CAGE CODE: 00779 DRAWING NO: 2291634 CUSTOMER DRAWING: - SCALE: 2 SHEET 2 OF 4 REV: A1

LOC	DIST	REV	DATE	APPD	APVD
GP	00				
P LTH		DESCRIPTION		DATE	OWN
		SEE SHEET 1			

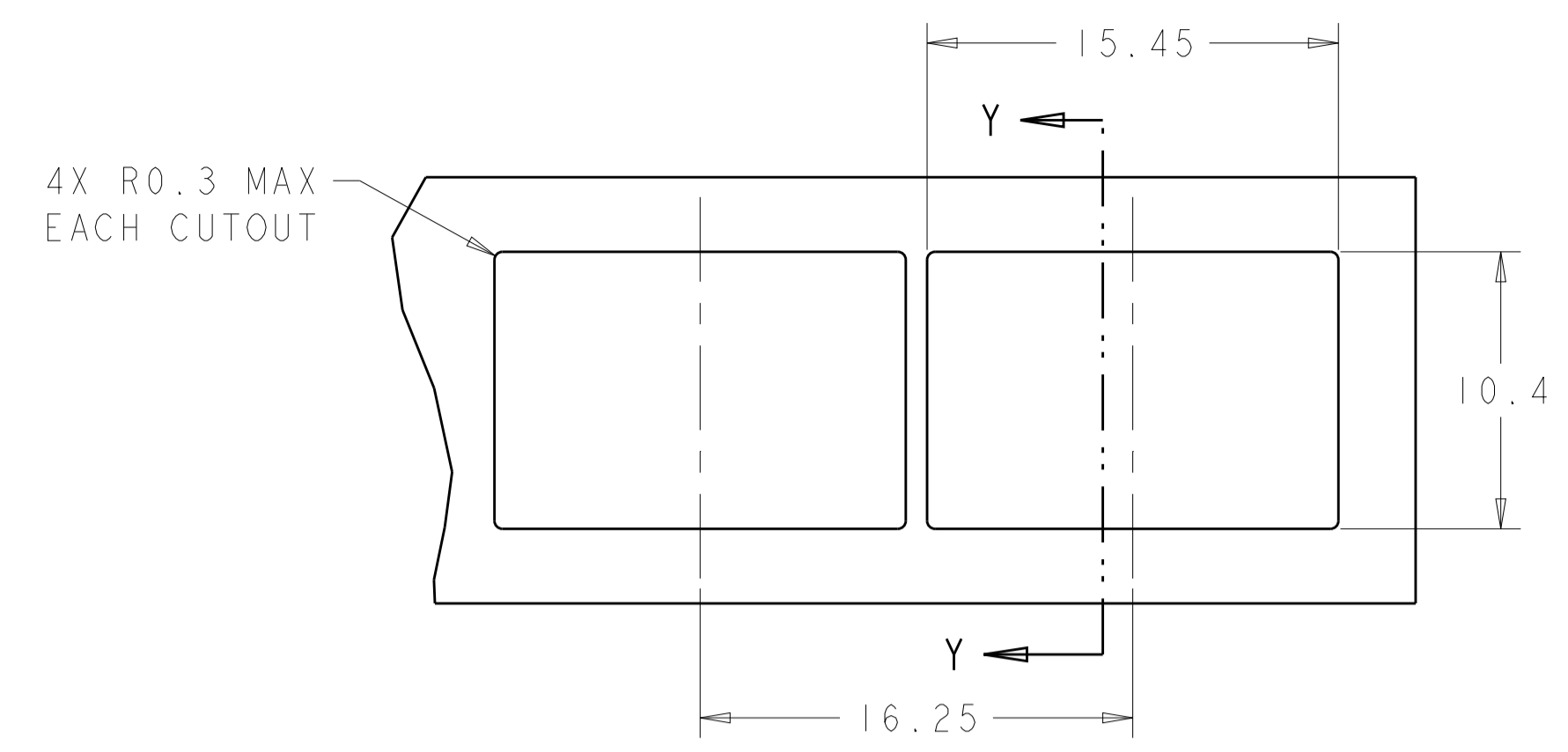

RECOMMENDED BEZEL CUTOUT
SCALE 4:1

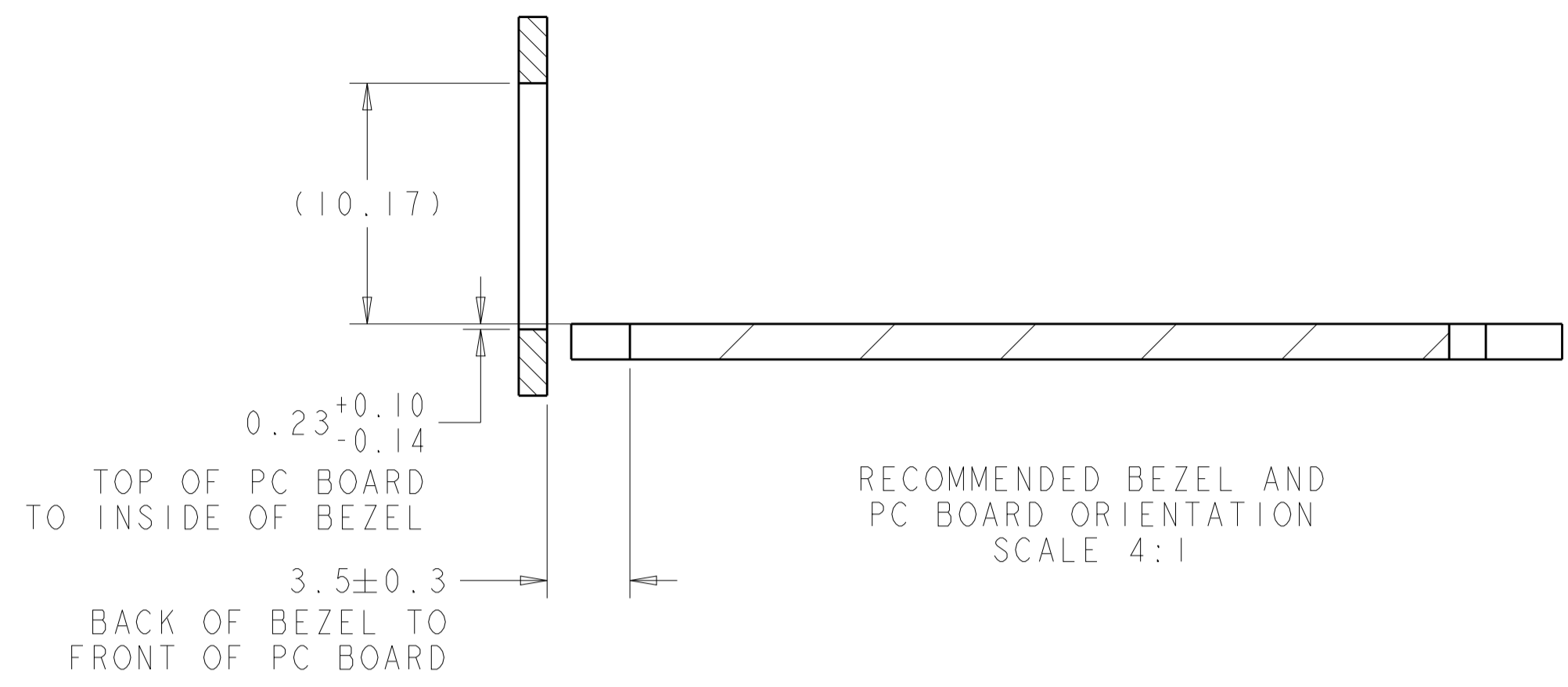

RECOMMENDED BEZEL AND
PC BOARD ORIENTATION
SCALE 4:1

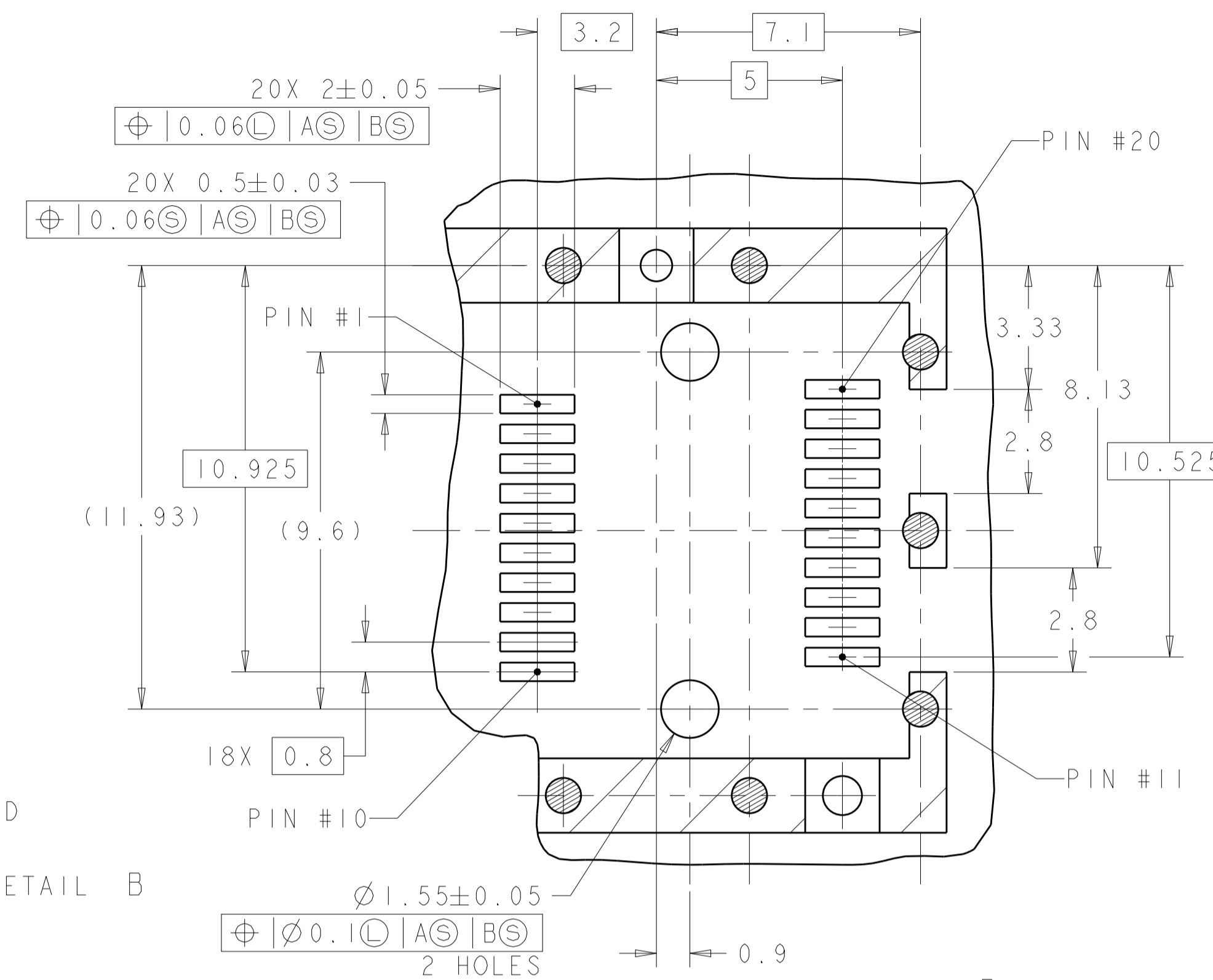

DETAIL B
SCALE 8:1

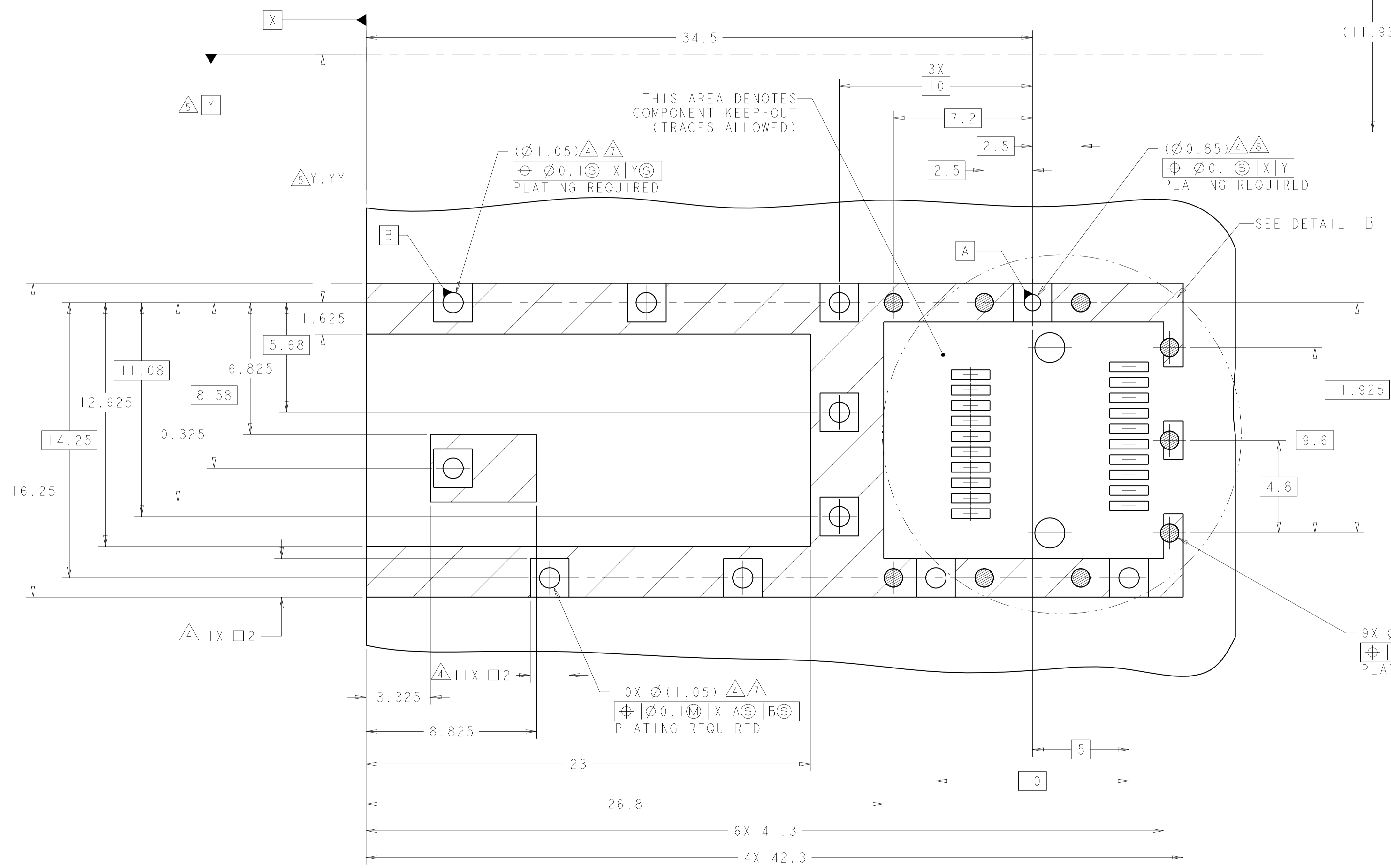

RECOMMENDED PCB LAYOUT FOR WITH
INSULATING TAPE PART
SCALE 8:1

THIS DRAWING IS A CONTROLLED DOCUMENT.		OWN: PETER PAN 17MAR2015	TE Connectivity
DIMENSIONS: mm		CHK: SEAN HAN 17MAR2015	
TOLERANCES UNLESS OTHERWISE SPECIFIED:		APPD: SEAN HAN 17MAR2015	NAME: SFP+ IXI CAGE ASSEMBLY, PRESS-FIT PRESS-FIT, EMI SPRINGS WITH HEATSINK PRODUCT SPEC: 108-2364 APPLICATION SPEC: 114-13120
0 PLC ±0.1 1 PLC ±0.1 2 PLC ±0.1 3 PLC ±0.05 4 PLC ±0.05 ANGLES ±0.05		SIZE: CAGE CODE DRAWING NO: WEIGHT: - CUSTOMER DRAWING	
MATERIAL: FINISH:		RESTRICTED TO: -	SCALE: 2 SHEET: 4 OF 4 REV: A1