

Sep.1.2020 Copyright 2020 HIROSE ELECTRIC CO., LTD. All Rights Reserved.
In case of consideration for using Automotive equipment / device which demand high reliability, kindly contact our sales window correspondents.

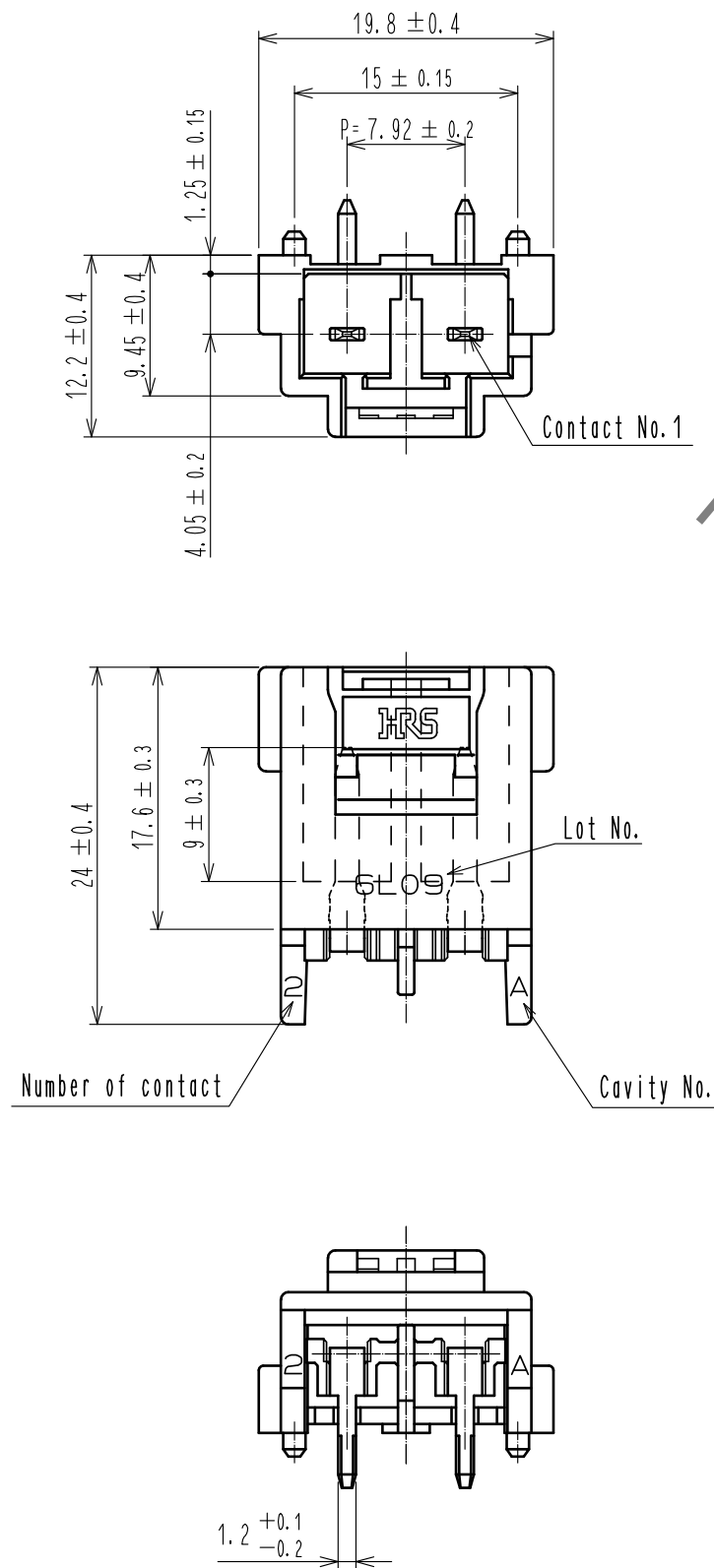

NOTE 1. Per pack : 100 pieces.
2. UL(File No. E52653)
C-UL(File No. E52653)
TÜV(File No. R9950703)authorization article.



Recommended PCB layout(Board thickness:1.6±0.1)

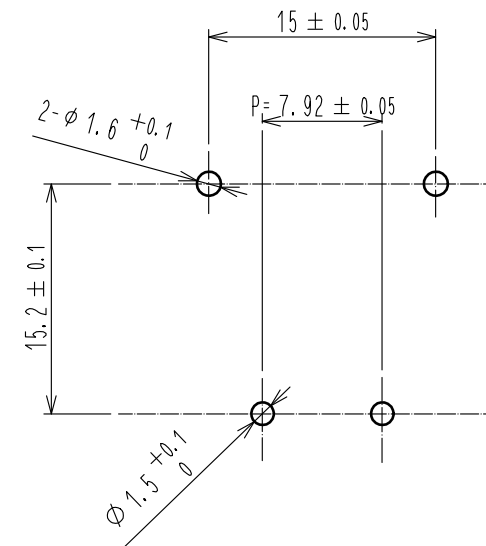

Application diagram

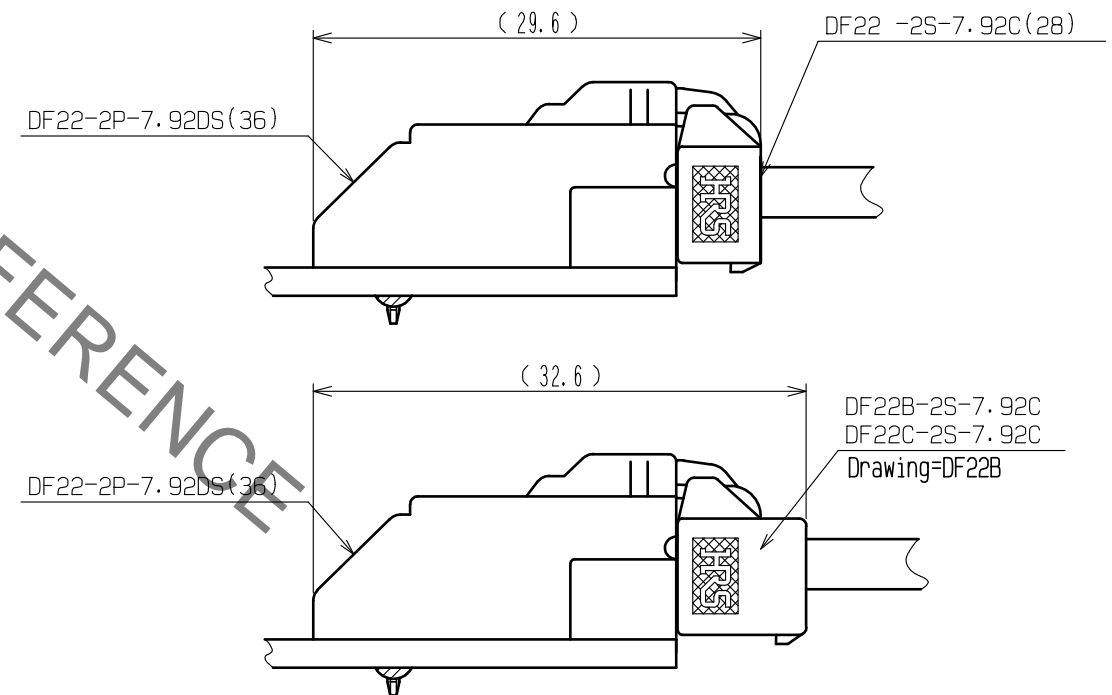

1			2		
Polyamide			Copper alloy		
Natural (beige), UL94V-0			Contact area:Gold plating 0.2mm min Lead area: Tin-copper plating 1mm min Under plating: Nickel plating 1mm min Other: Nickel plating 1mm min		
NO.	MATERIAL	FINISH . REMARKS	NO.	MATERIAL	FINISH . REMARKS
UNITS mm		SCALE 2 : 1	COUNT 1	DESCRIPTION OF REVISIONS	
DIS-H-00003575				DESIGNED TS. KUMAZAWA	CHECKED TS. FUKUSHIMA
DATE 18.03.29				DRAWING NO. EDC-163023-36-00	
APPROVED : KI. AKIYAMA 15.11.05				PART NO. DF22-2P-7.92DS(36)	
CHECKED : TS. FUKUSHIMA 15.11.05				CODE NO. CL680-1008-5-36	
DESIGNED : HT. SATO 15.11.04				1/2	
DRAWN : MI. SAKIMURA 15.11.02					

HRS HIROSE
ELECTRIC
CO., LTD.

Sep.1.2020 Copyright 2020 HIROSE ELECTRIC CO., LTD. All Rights Reserved.
In case of consideration for using Automotive equipment / device which demand high reliability, kindly contact our sales window correspondents.



Precautions

Notification for Insertion/Extraction

- 1) Please insert(extract) the crimping socket straight to the mating connector.
Insertion(extraction) at tilted angles applies load concentration to the connector end and may cause deformation (at connection area, socket and header case, etc). There is firing risk using this kind of deformed connector.

Insertion(Extraction)

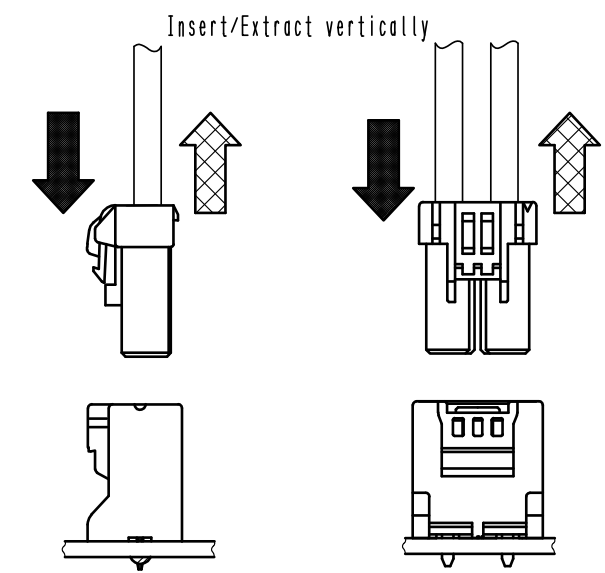
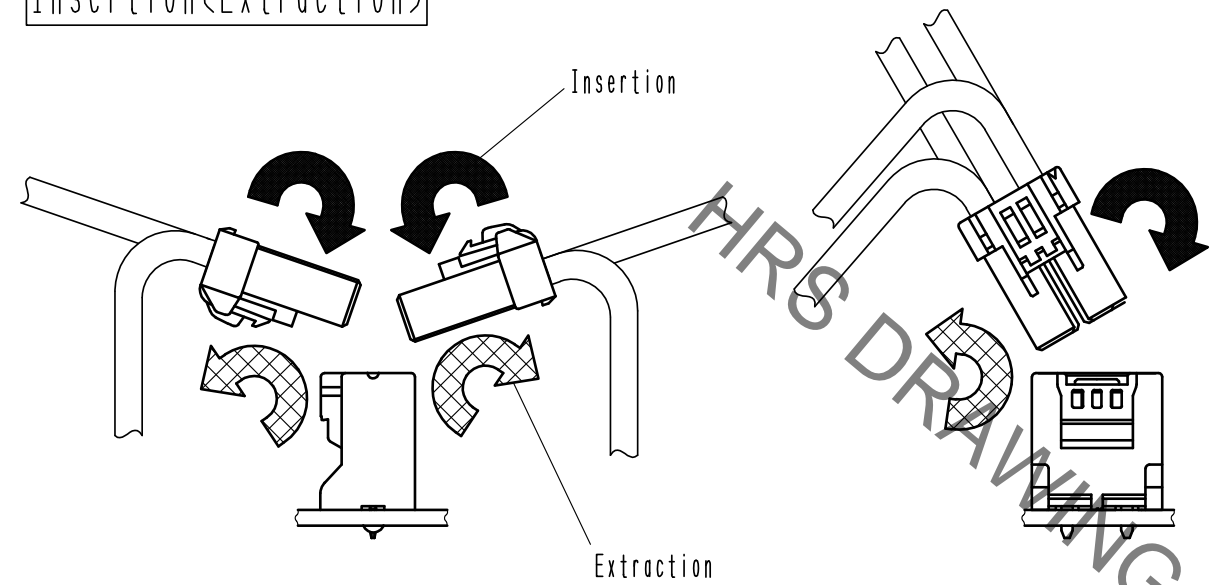

- 2) When it is hard to extract, please lightly insert the connector beforehand and then pull it with releasing the lock.
Forced extraction has a risk of connector breakage.

Notification of wiring

- 1) When using a thick cable, short cable length and bending close to the connector end, these load concentration may cause deformation.
Please note that there is firing risk using deformed connector.
When installing, please refrain from stress concentration such as cable bending close to the connector end or cable twisting.

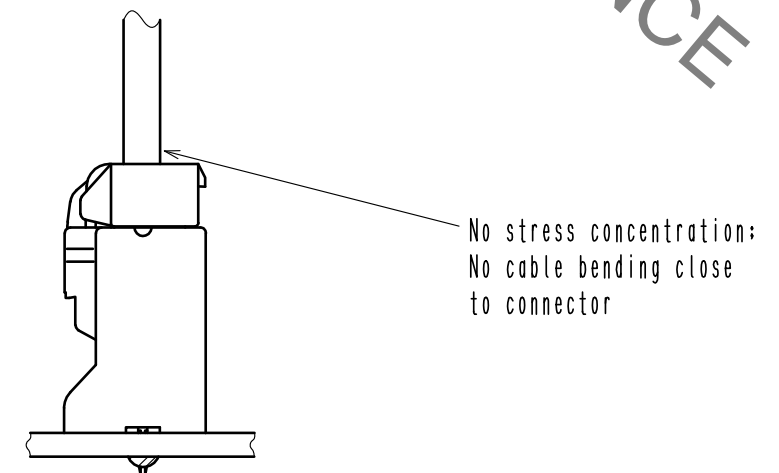
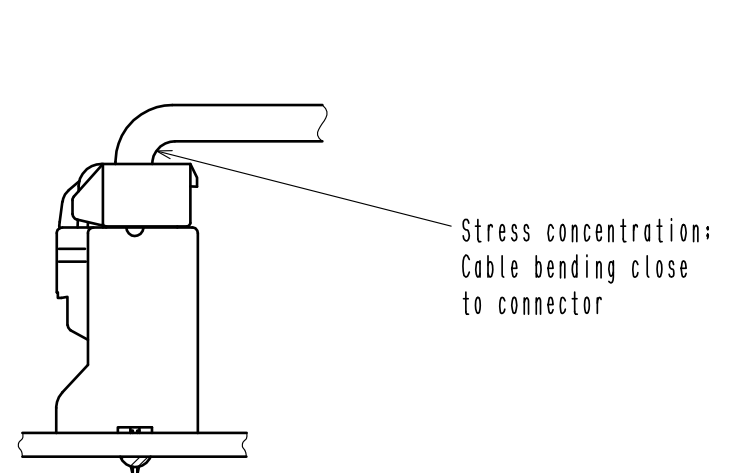

- 2) When applying load to connector end, please use the retainer for reducing the stress affection on the connector.
Retainer shall be installed after inserted crimping contact completely. It might be impossible to insert it when terminal installation is incompleated.



DRAWING NO.	EDC-163023-36-00
PART NO.	DF22-2P-7. 92DS(36)
CODE NO.	CL680-1008-5-36