

PART NUMBER	REV	DESCRIPTION
2385663-1	A	HV DIE SET
7-2385663-7	A	CRIMP TOOLING KIT
9-2385663-1	A	DIE SET WITH DIE HOLDER

REVISIONS				
P	LTN	DESCRIPTION	DATE	APPD
A		RELEASED	27SEP2021	LG TE

TERMINAL NAME	SOCKET CONTACT DIA 9.0 ASSY BUS BAR VERSION		
TE TERMINAL PART NUMBER(S)	2343462-7		
APPLICATION SPECIFICATION	114-94578		
USED ON	2305470-1	2326378-1	
INSTRUCTION SHEET	-		

CABLE SUPPLIER/SPECIFICATION	CABLE SIZE	CRIMP HEIGHT	CRIMP HEIGHT REFERENCE SETTING
COFICAB/FHLR2GCB2G LV216-2	16mm ²	6.90±0.10	E2

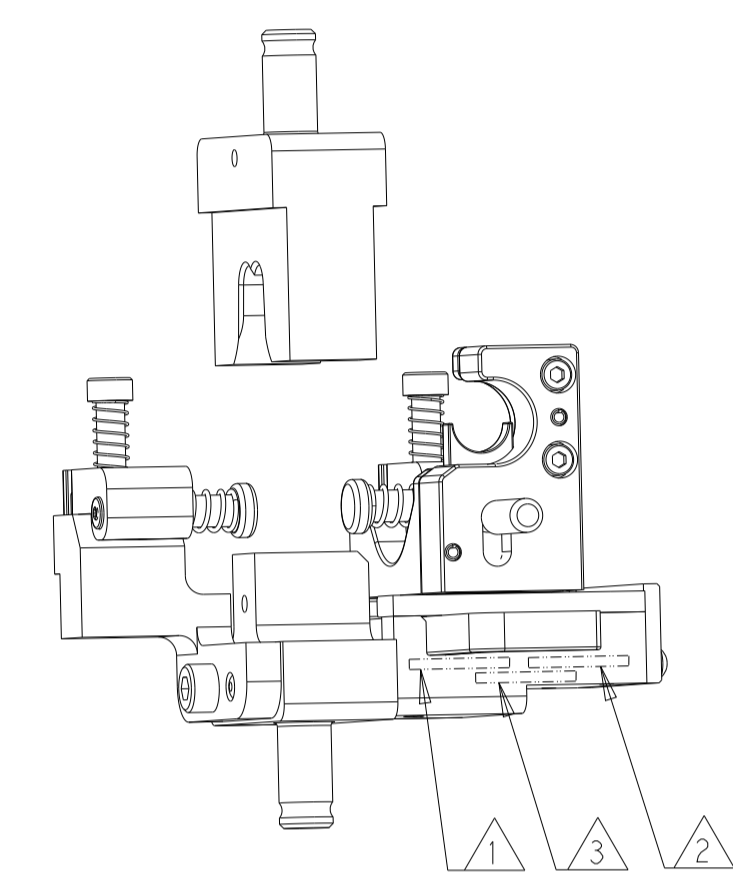

1	-	-	2305470-1	HV DIE HOLDER WITH FINE ADJUST	100
1	-	1	8-18023-4	SCR, SKT HD CAP M5 X 35.0	32
2	-	2	18024-2	SCR, BTN SKT HD CAP (M3 X 8.0)	31
4	-	4	6-993111-5	PIN, SLOTTED SPRING 3.0 X 10.0	30
4	-	4	1-994236-3	SCR, FLT SKT HD CAP M3 X 10.0	29
1	-	1	3-18032-5	SCR, SET, FLT PNT, M4 X 12.0	28
2	-	2	18023-3	SCR, SKT HD CAP M3 X 8.0	27
1	-	1	4-22282-7	SPRING, COMPRESSION	26
1	-	1	2326062-1	KNOB	25
2	-	2	2030994-3	PLUNGER, BALL END, M4x10mm	24
2	-	2	18023-5	SCR, SKT HD CAP M3 X 12.0	23
2	-	2	6-993111-7	PIN, SLOTTED SPRING 3.0 X 16.0	22
2	-	2	1-519014-7	SCR, SET, CUP POINT M2.5 X 8	21
2	-	2	19042-5	SPRING, COMPRESSION	20
2	-	2	980371-6	SCR, SKT HD SHLDR 5.0 DIA X 20.0	19
4	-	4	1-993111-9	PIN, SLOTTED SPRING 2.5 X 10.0	18
2	-	2	2326059-1	PIN, WIRE STOP	17
2	-	2	4-993111-0	PIN, SLOTTED SPRING 1.5 X 12.0	16
2	-	2	2-22281-0	SPRING, COMPRESSION	15
1	-	1	2326058-1	HOUSING, WIRE STOP	14
1	-	1	2367580-2	HOUSING, WIRE STOP	13
1	-	1	2378722-1	COVER PLATE	12
1	-	1	2378844-3	BELLMOUTH ADJUSTMENT	11
1	-	1	2326052-5	PLATE, GUIDE	10
1	-	1	2326052-4	PLATE, GUIDE	9
1	-	1	2234161-6	HOLD DOWN, TERMINAL -	8
1	-	1	2326057-2	PAWL, LOCKING	7
1	-	1	2234164-3	SUPPORT PIN	6
1	-	1	2380616-4	SUPPORT, TERMINAL	5
1	-	1	2326061-1	BASE, WIRE STOP	4
1	-	1	2378743-3	BASE, LOCATOR	3
1	1	1	2385619-1	CRIMPER HVM F	2
1	1	1	2305477-1	ANVIL HVM F	1
-91	-77	-1	PART NO	DESCRIPTION	ITEM NO

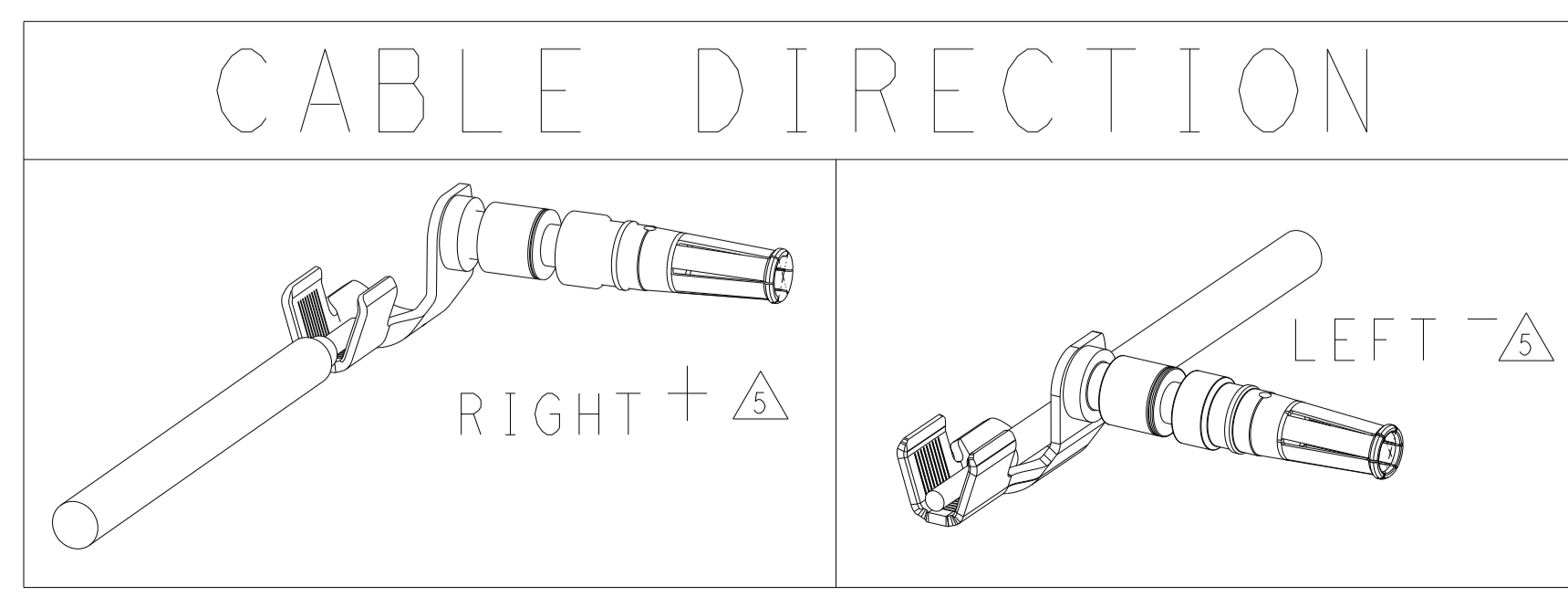
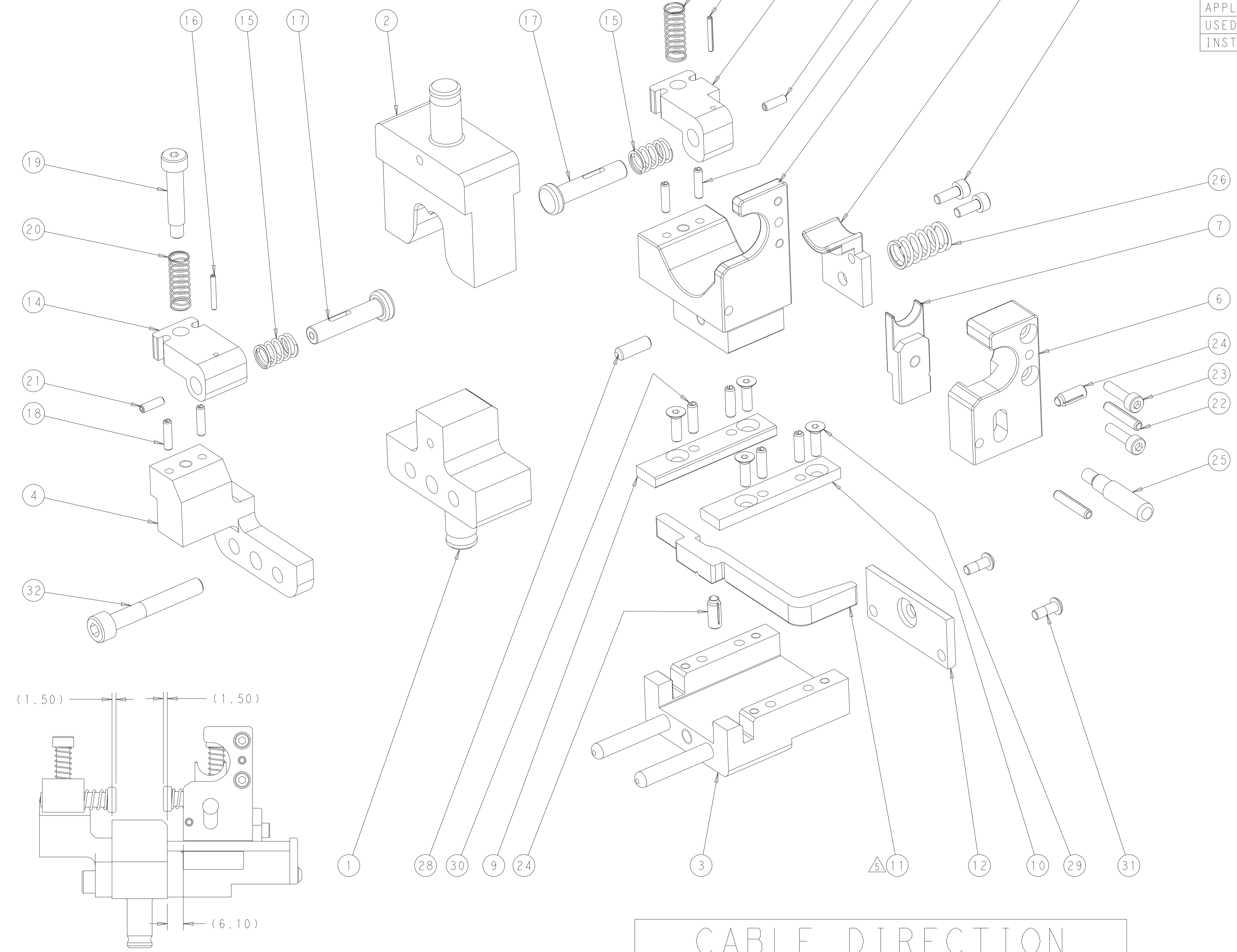

- ① APPLY "DIE SET PN" PER TEC-115-67-2 IN APPROXIMATE AREA SHOWN.
- ② IDENTIFY PART NUMBER AND REVISION LETTER PER TEC-115-67-2 IN APPROXIMATE AREA SHOWN.
- ③ IDENTIFY SERIAL NUMBER PER TEC-115-67-2 IN APPROXIMATE AREA SHOWN.
- 4. TORQUE RECOMMENDATIONS PER 101-35000 UNLESS OTHERWISE SPECIFIED.
- ⑤ TO CHANGE CABLE DIRECTION ADJUST POSITION OF ITEM 11.

THIS DRAWING IS A CONTROLLED DOCUMENT.		OWN: J. LI 21APR2021	
DIMENSIONS: mm		CHK: A. JIANG 21APR2021	
TOLERANCES UNLESS OTHERWISE SPECIFIED:		APPD: Y. YIN 21APR2021	
0 PLC ±		NAME: DIE ASSEMBLY	
1 PLC ±		PRODUCT SPEC	90 DEGREE POWER SOCKET 16mm ²
2 PLC ±		APPLICATION SPEC	SIZE: CAGE CODE: DRAWING NO:
3 PLC ±		RESTRICTED TO:	A 00779 2385663
4 PLC ±		WEIGHT:	CUSTOMER ACCESSIBLE PRODUCTION DRAWING
ANGLES FINISH:		SCALE: 1:1	SHEET 1 OF 1
MATERIAL:		REV: A	