

MATERIAL NO. LOOSE PIECE	ENG. NO.	MATERIAL NO. TAPE MOUNTED	ENG. NO.	STUD SIZE	±.003 "S"	"W" MAX.	"C" MIN.	"L" MAX.
190690352	M-1113-02	190690353	M-1113-02T	2	.094 (2.38)	.213 (5.40)	(B)	(B)
190690354	M-1113-04	190690355	M-1113-04T	4	.119 (3.02)		(B)	(B)
190690356	M-1113-06	190690357	M-1113-06T	6	.146 (3.71)		(B)	(B)
190690358	M-1114-02	190690405	M-1114-02T	2	.094 (2.38)	.150 (3.80)	(B)	(B)
190690361	M-1118-06	190690362	M-1118-06T	6	.146 (3.71)	.260 (6.60)	(B)	(B)
190690363	M-1118-08	190690364	M-1118-08T	8	.173 (4.39)		(B)	(B)
190690365	M-1118-10	190690406	M-1118-10T	10	.198 (5.03)		(B)	(B)
190690369	M-1122-00	190690407	M-1122-00T	00	.067 (1.70)	.150 (3.80)	.121 (3.10)	.366 (9.30)
190690370	M-1122-02	190690371	M-1122-02T	2	.094 (2.38)			

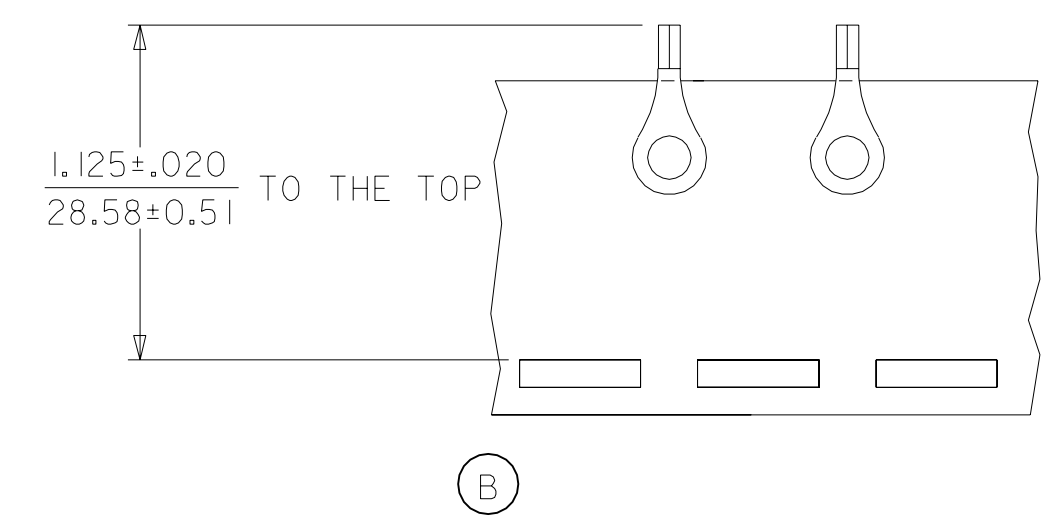
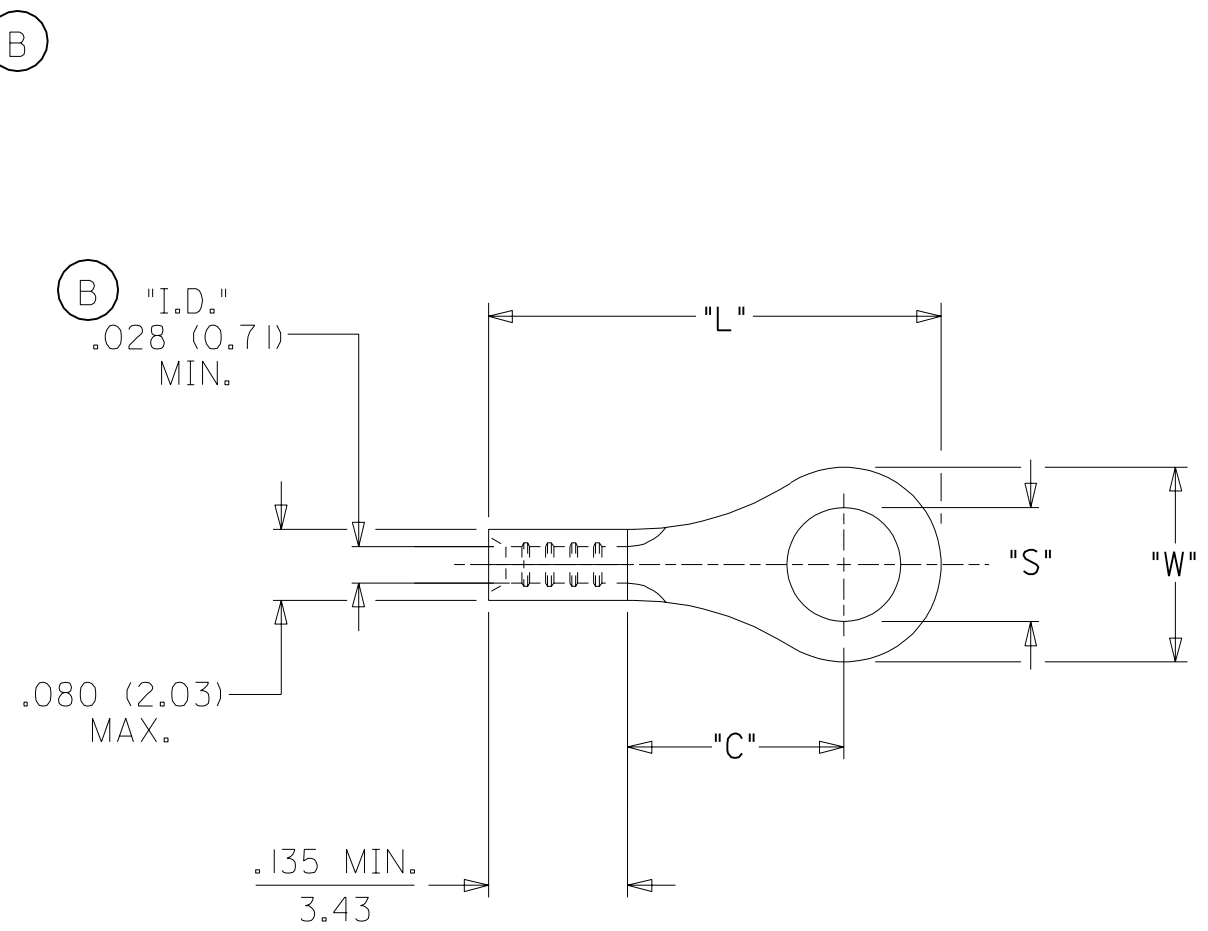

SALES DRAWING

NOTE(S):  
 1. MATERIAL: COPPER (.018/0.46 THICK)  
 2. PLATING: ELECTROPLATE TIN  
 3. ALL DIMENSIONS IN INCHES/(MM).  
 WIRE SIZE: 26-24 AWG  
 .14-.25 MM<sup>2</sup>

UPDATE TO MX STDS EC NO. ETC2003-0171 DRWN: DLM 04/05/05 CHK: HB 04/05/05 APPR: RWD 04/05/05	QUALITY SYMBOLS MAJOR = ∇ CRITICAL = ∇	GENERAL TOLERANCES: (UNLESS SPECIFIED)		SCALE 5:1	DESIGN UNITS <input type="checkbox"/> mm <input checked="" type="checkbox"/> INCH	THIRD ANGLE PROJECTION <input type="checkbox"/> mm <input checked="" type="checkbox"/> INCH	DIMENSIONS: <input type="checkbox"/> mm <input checked="" type="checkbox"/> INCH <input type="checkbox"/> mm ONLY	SHT	REV	
		4 PLACES ±0.----- ±.-----	3 PLACES ±0.--- ±.005	2 PLACES ±0.13 ±.010	1 PLACE ±0.25 ±.---	ANGULAR: ±1/2°	DRAWN BY & DATE: DLM 84/12/14 CHECKED BY & DATE: SB 84/12/14 APPROVED BY & DATE: RWD 84/12/14			
REV	DESCRIPTION	DRAFT WHERE APPLICABLE MUST REMAIN WITHIN DIMENSIONS		CAD FILENAME: SD19069003.DGN		MATERIAL NO. (SEE CHART)		DRAWING NO. SD-19069-003		SHEET NO. 1 OF 1
		THIS DRAWING CONTAINS INFORMATION THAT IS PROPRIETARY TO MOLEX INCORPORATED AND SHOULD NOT BE USED WITHOUT WRITTEN PERMISSION.		TITLE: RING TONGUE TERMINAL KRIMPTITE 26-24 AWG		MOLEX INCORPORATED		REVISE ON CAD ONLY		SIZE B