

10 9 8 7 6 5 4 3 2 1

F

E

D

C

B

A

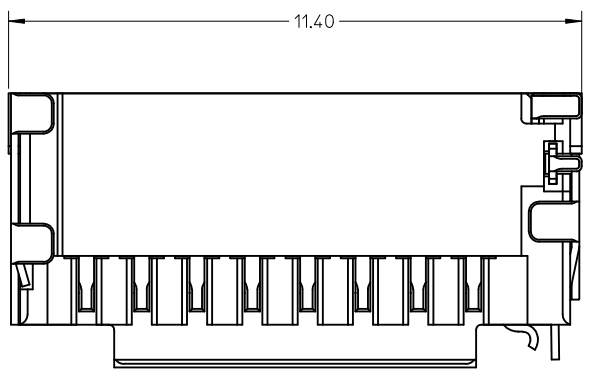
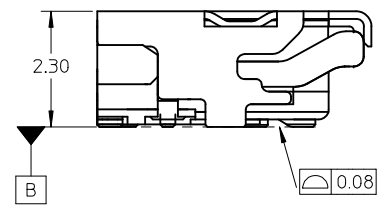
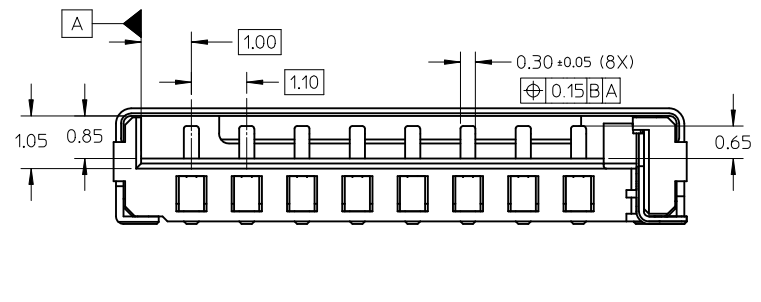
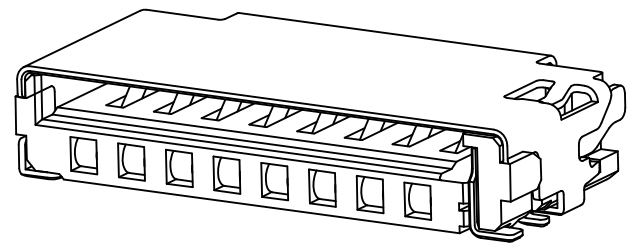
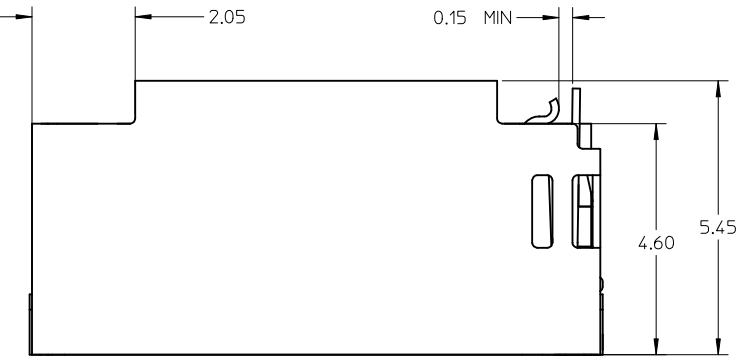

NOTES:

1. MATERIAL:
  - 1-1 HOUSING: LCP, 30% G/F, UL 94V-0, BLACK
  - 1-2 SIGNAL TERMINAL AND DETECT TERMINAL: PHOSPHOR BRONZE
  - 1-3 METAL SHELL: STAINLESS STEEL
2. FINISH:
  - 2-1 SIGNAL TERMINAL: 1.25 MICRON NICKEL MIN UNDER-PLATED, CONTACT AREA SEE TABLE, GOLD FLASH ON SOLDER AREA.
  - 2-2 METAL SHELL: GOLD FLASH OVER NICKEL ON SOLDER AREA.
  - 2-3 DETECT PIN: 1.25 MICRON NICKEL MIN UNDER-PLATED GOLD FLASH PLATED ON CONTACT AREA, TIN PLATED ON SOLDER AREA.
3. PRODUCT SPECIFICATION: PS-47309-001.
4. PACKAGE SPECIFICATION: PK-47571-001.
5. PRODUCT COMPLIANT TO RoHS DIRECTIVE 2002/95/EC AND ELV 2000/53/EC.

|            |                               |
|------------|-------------------------------|
| 47571-0101 | 0.38 MICRON MIN. GOLD PLATING |
| 47571-0001 | 0.76 MICRON MIN. GOLD PLATING |
| 47571-2001 | 0.1 MICRON MIN. GOLD PLATING  |
| P/N        | CONTACT AREA PLATING          |

|   |                          |   |   |                        |   |                                     |              |                              |                        |  |
|---|--------------------------|---|---|------------------------|---|-------------------------------------|--------------|------------------------------|------------------------|--|
| ADD PART NUMBER<br>EC NO: SH2012-0261<br>DRWG: GLLI<br>CHKD:<br>APPR: AYIN<br>REV | 2012/02/10<br>2012/02/23 | QUALITY SYMBOLS<br>$\nabla_A = 0$<br>$\nabla_C = 0$<br>$\nabla_F = 0$ | GENERAL TOLERANCES (UNLESS SPECIFIED)   |                        | DIMENSION STYLE<br>MM ONLY  |                                     | SCALE<br>1:1 | DESIGN UNITS<br>METRIC       | THIRD ANGLE PROJECTION |  |
|   |                          |   | mm      INCH  | DRAWN BY<br>GLLI       | DATE<br>2012/02/10  | TITLE<br>TFR HEADER WITH DETECT PIN |              |                              |                        |  |
|   |                          |   | 4 PLACES ± --- ± ---<br>3 PLACES ± --- ± ---<br>2 PLACES ± 0.15 ± ---<br>1 PLACE ± 0.25 ± --- | CHECKED BY<br>XQ ZHANG | DATE<br>2012/02/10  |                                     |              |                              |                        |  |
|   |                          |   | ANGULAR ± 3 °   | APPROVED BY<br>AYIN    | DATE<br>2012/02/23  | MATERIAL NO.<br>SEE TABLE           |              | DOCUMENT NO.<br>SD-47571-001 | SHEET NO.<br>1 OF 2    |  |
|   |                          |   | DRAFT WHERE APPLICABLE MUST REMAIN WITHIN DIMENSIONS  |                        | THIS DRAWING CONTAINS INFORMATION THAT IS PROPRIETARY TO MOLEX INCORPORATED AND SHOULD NOT BE USED WITHOUT WRITTEN PERMISSION |                                     |              |                              |                        |  |

9 8 7 6 5 4 3 2 1

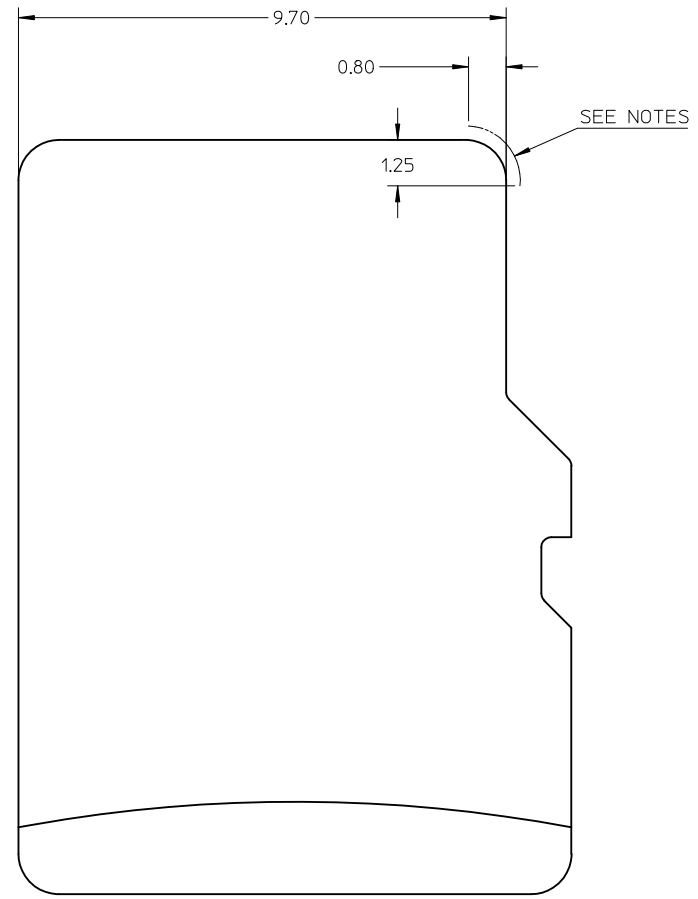
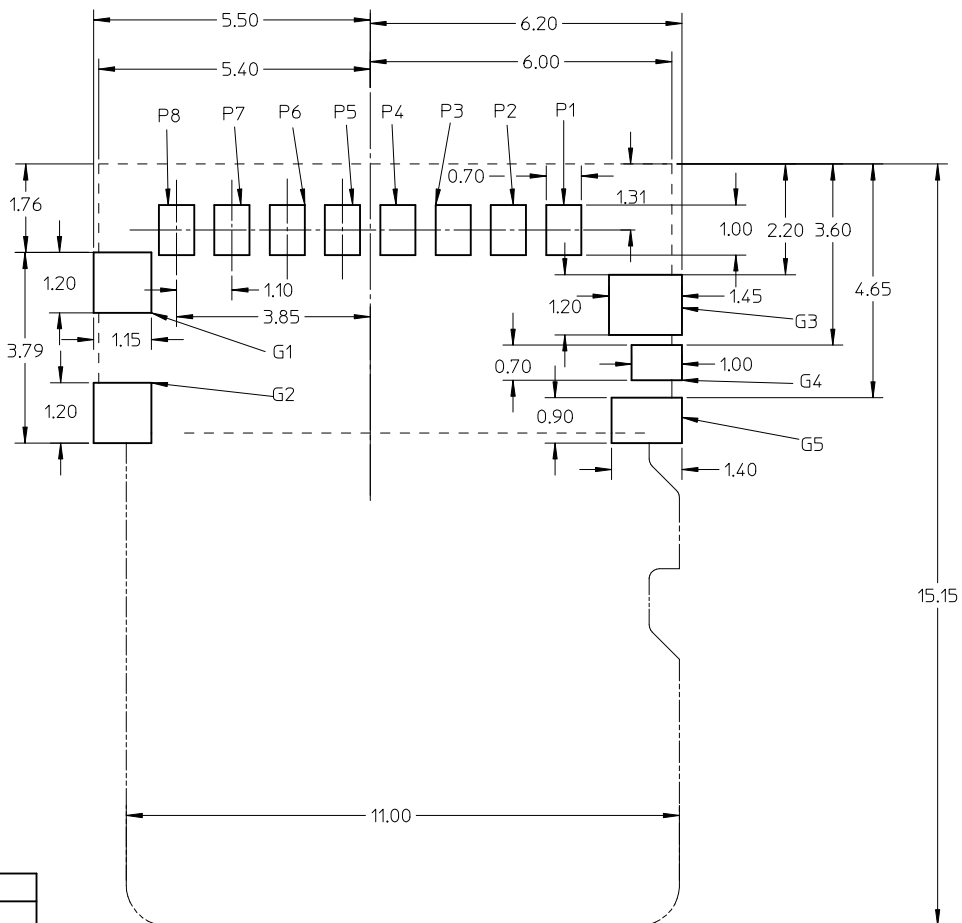

|                |         |
|----------------|---------|
| G5             | DET     |
| G4             | POL     |
| G3             | GND     |
| G2             | GND     |
| G1             | GND     |
| P8             | DAT1    |
| P7             | DAT0    |
| P6             | VSS     |
| P5             | CLK     |
| P4             | VDD     |
| P3             | CMD     |
| P2             | CD/DAT3 |
| P1             | DAT2    |
| NAME           | TYPE    |
| PIN ASSIGNMENT |         |

----- CONNECTOR PROFILE  
 - - - - - CARD PROFILE

NOTES:  
 NO CONDUCTIVE EXPOSURE TRACE IS ALLOWED ON THE SIDE FACE OF THE CARD AT THIS AREA.

|                |         |
|----------------|---------|
| G5             | DET     |
| G4             | POL     |
| G3             | GND     |
| G2             | GND     |
| G1             | GND     |
| P8             | DAT1    |
| P7             | DAT0    |
| P6             | VSS     |
| P5             | CLK     |
| P4             | VDD     |
| P3             | CMD     |
| P2             | CD/DAT3 |
| P1             | DAT2    |
| NAME           | TYPE    |
| PIN ASSIGNMENT |         |

|   |   |                                       |         |   |                    |  |                               |                            |  |  |  |
|---|---|---------------------------------------|---------|---|--------------------|--|-------------------------------|----------------------------|--|--|--|
| SEE SHEET 1<br>EC NO: SH2012-0261<br>DRW:GLL1<br>CHKD:<br>APPR:AYIN<br>2012/02/10<br>2012/02/23 | QUALITY SYMBOLS<br>$\nabla_F=0$<br>$\nabla_E=0$<br>$\nabla_D=0$ | GENERAL TOLERANCES (UNLESS SPECIFIED) |         | DIMENSION STYLE<br><b>MM ONLY</b>   |                    | SCALE<br><b>1:1</b>                        | DESIGN UNITS<br><b>METRIC</b> | THIRD ANGLE PROJECTION     |  |  |  |
|   |   | 4 PLACES $\pm$ --- $\pm$ ---          | mm INCH | DRAWN BY<br>GLL1  | DATE<br>2012/02/10 | TITLE<br><b>TFR HEADER WITH DETECT PIN</b> |                               |                            |  |  |  |
|   |   | 3 PLACES $\pm$ --- $\pm$ ---          |         | CHECKED BY<br>XQ ZHANG  | DATE<br>2012/02/10 |  |                               |                            |  |  |  |
|   |   | 2 PLACES $\pm$ 0.15 $\pm$ ---         |         | APPROVED BY<br>AYIN   | DATE<br>2012/02/23 | MOLEX INCORPORATED                         |                               |                            |  |  |  |
|   |   | ANGULAR $\pm$ 3 °                     |         | MATERIAL NO.<br><b>SEE SHEET 1</b>  |                    | DOCUMENT NO.<br><b>SD-47571-001</b>        |                               | SHEET NO.<br><b>2 OF 2</b> |  |  |  |
| DRAFT WHERE APPLICABLE MUST REMAIN WITHIN DIMENSIONS  |   |                                       |         | THIS DRAWING CONTAINS INFORMATION THAT IS PROPRIETARY TO MOLEX INCORPORATED AND SHOULD NOT BE USED WITHOUT WRITTEN PERMISSION |                    |  |                               |                            |  |  |  |