

REVISIONS			
REV	DESCRIPTION	DATE	APPV
A	PRODUCTION RELEASE	AJVM 9/28/2022	

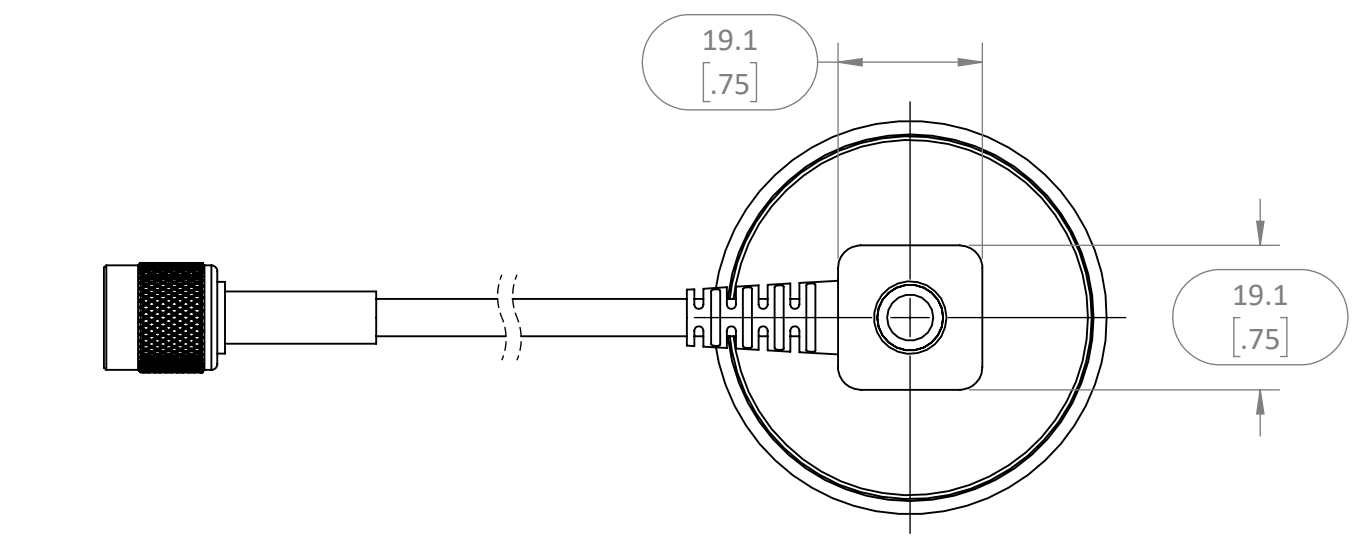
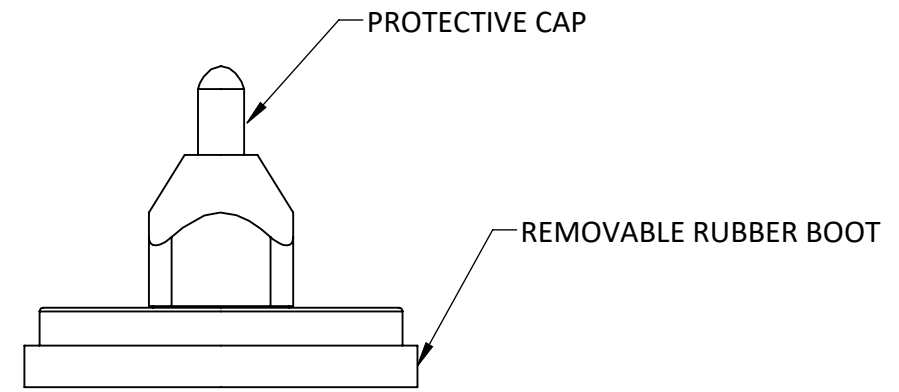
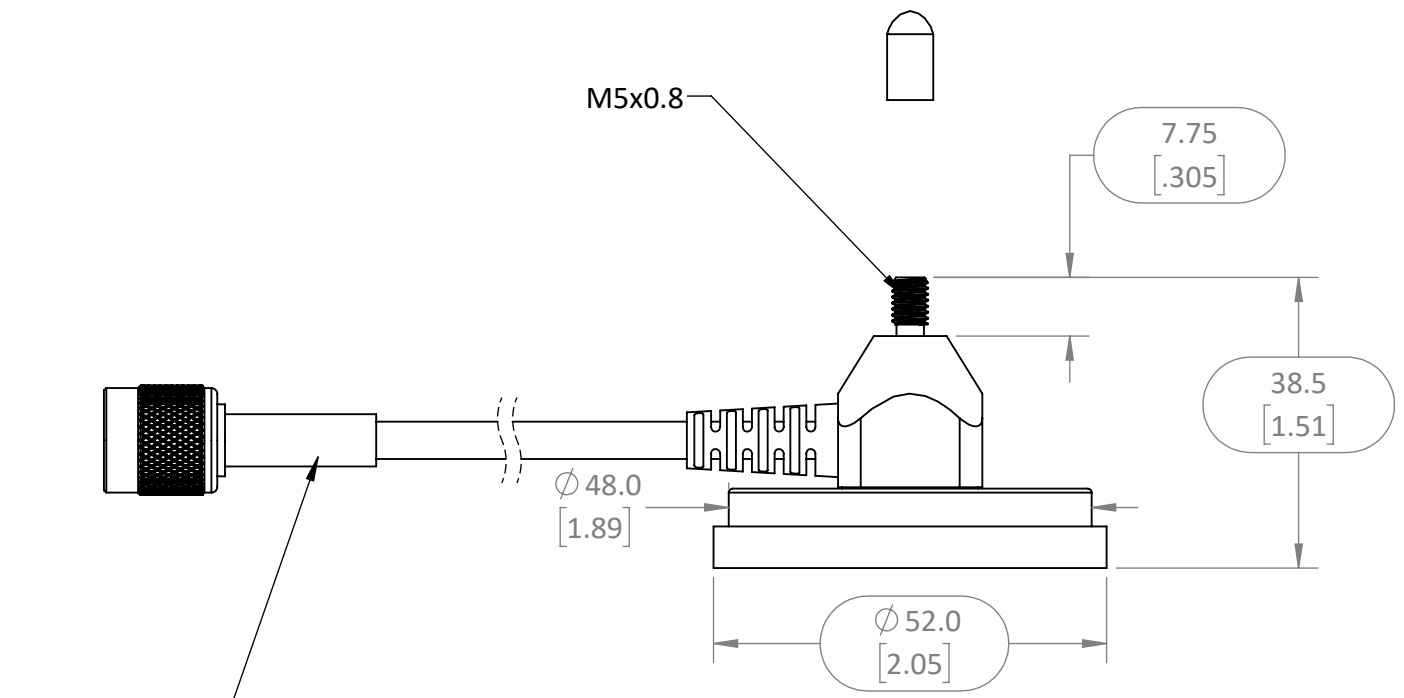

- NOTES: (UNLESS OTHERWISE SPECIFIED)
- ALL DIMENSIONS ARE IN MILLIMETERS [IN].
 - DIMENSIONS APPLY AFTER FINISHING.
 - MANUFACTURE TO BE COMPLIANT WITH EU RoHS DIRECTIVE, USE MATERIALS THAT DO NOT CONTAIN REACH SUBSTANCES OF VERY HIGH CONCERN >1000ppm, AND USE DRC CONFLICT-FREE SOURCED MATERIALS.
 - ELECTRICAL SPECIFICATIONS ARE LISTED FOR REFERENCE ONLY. SEE LINX DATA SHEET FOR ELECTRICAL PROPERTIES.
 - IMPEDANCE: 50Ω
 - MECHANICAL:
 - CABLE: RG-58
 - MINIMUM CABLE BEND RADIUS: 19.8mm
 - OPERATING TEMPERATURE: -40°C TO +80°C
 - TNC TYPE INTERFACE IAW [MIL-STD-348B][SEE TABLE]
 - BLACK PROTECTIVE PVC CAP FOR THREAD PROTECTION DURING TRANSIT
 - PRODUCT QUALIFIED IAW LINX TEST PLAN AT CURRENT REVISION.
 - UNLISTED DIMENSIONS ARE CONTROLLED BY SOLID MODEL AT LATEST REVISION.
 - PACKAGE INDIVIDUALLY IN BOX AND LABEL IAW LINX LABEL DRAWING [MEC-LBL-4x2.5-PAPER-ID]

WARNING: THIS DRAWING CONTAINS PROPRIETARY INFORMATION THAT IS THE SOLE PROPERTY OF LINX TECHNOLOGIES, AND SHALL BE TREATED AS SUCH. NO DISCLOSURE OR REPRODUCTION OF THIS DOCUMENT IS PERMITTED, IN WHOLE OR IN PART, WITHOUT THE EXPRESS WRITTEN PERMISSION OF LINX TECHNOLOGIES OR ITS DESIGNATED AGENTS.

STE 159 ORT LANE
connectivity MERLIN, OR 97532

MATERIAL:	INTERPRET DIMENSIONS AND TOLERANCES PER ASME Y14.5.	PROJECTION:
WEIGHT:	.X ±2.0 .XX ±1.00 .XXX ±.500	
FINISH:	ANGLES: ±1° SURFACE:	
DRAWN: JHAGER	DT:	
ENGR:	DT: 10-JUL-08	

TITLE: 50mm MAGNETIC BASE CONNECTOR TNC		
SIZE B	DWG. NO. C-ANT-MAG-B50-TNC	REV A
SCALE: 1:1	DO NOT SCALE DRAWING	SHEET 1 OF 1