

PARAMETER	PERFORMANCE	
MODEL NUMBER	TRAB9023P	TRA9023P
FREQUENCY	902-928 MHz	
GAIN (*)	3 dBI	
VSWR	<2 : 1	
INPUT IMPEDANCE	50 OHM	
POLARIZATION	VERTICAL	
RADOME COLOR	BLACK	WHITE
MAX INPUT POWER	100 WATTS	
RADIATION PATTERN	OMNIDIRECTIONAL	
MOUNTING	P-MOUNT	
WIND SURVIVOL	282 KM/H	
OPERATING TEMPERATURE	-45°C TO +85°C	
STORAGE TEMPERATURE	-50°C TO +85°C	
INSTALLATION TORQUE ON NUT	5.4NM TO 8.1 NM	

(*) NOTE: THIS PARAMETER IS DEVICE DEPENDANT AND SHOULD SERVE AS REFERENCE

REVISIONS					
REV.	ECN#	ZONE	DESCRIPTION	CHANGED BY/DATE	APPROVED BY/DATE
F01	ECO-21-00716		INITIAL RELEASE	TP 14DEC21	WT 14DEC21

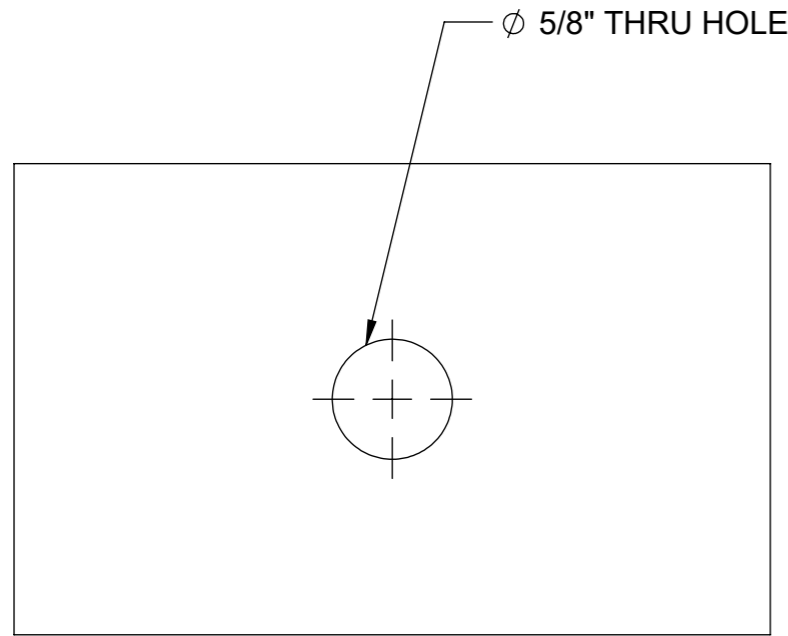
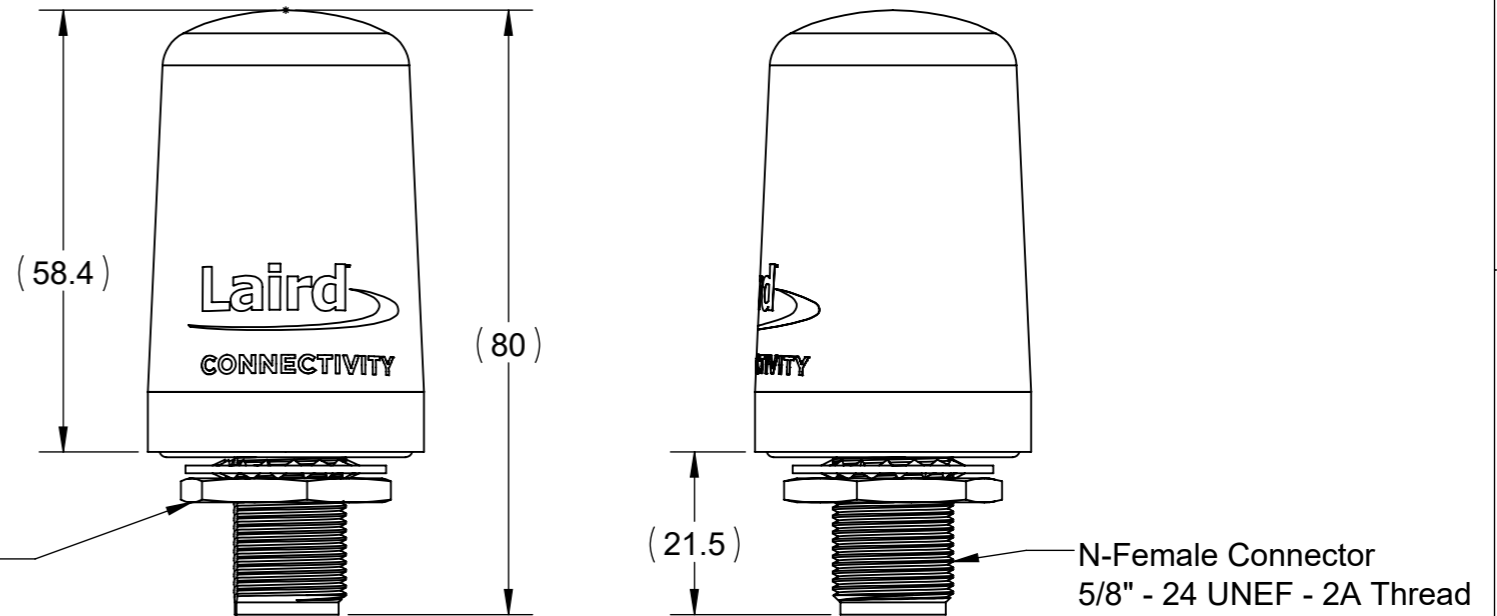
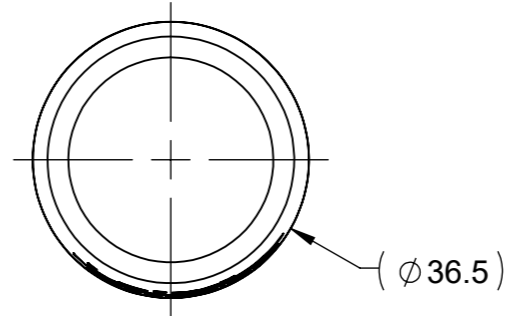

RECOMMENDED MOUNTING CONDITIONS:
 METALLIC SURFACE SHOULD BE FLAT AND CLEAN AS POSSIBLE
 HOLE SHOULD BE CENTERED AS MUCH AS POSSIBLE
 MAXIMUM THICKNESS : 22MM

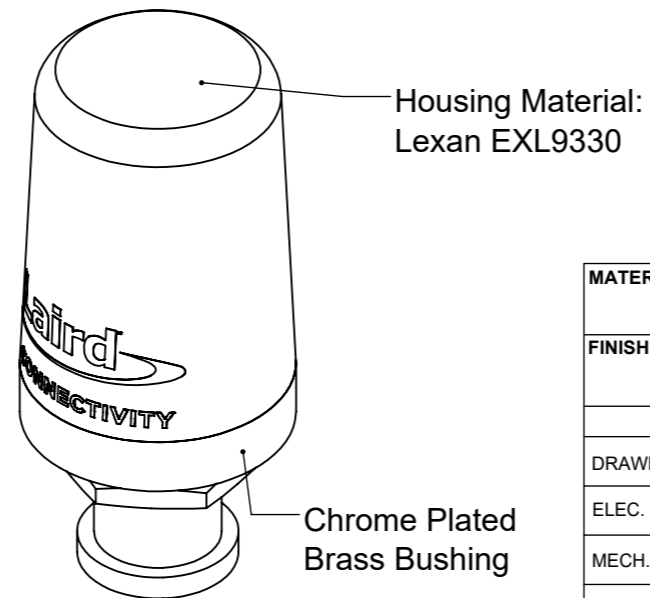

Stainless Steel
Lock washer and Nut

MATERIAL:		THIRD ANGLE PROJECTION	
FINISH:		DO NOT SCALE DRAWING	
APPROVALS		DATE	
DRAWN BY	TP	14DEC21	
ELEC. ENG.	TY	14DEC21	
MECH. ENG.	WT	14DEC21	
MFG./OPS.	GL	14DEC21	
INTERPRET DIMENSIONING AND TOLERANCING IN ACCORDANCE WITH ASME Y14.5M-2009		TOLERANCES UNLESS OTHERWISE SPECIFIED	
ANGLE: ±30'		DIMENSIONS ARE IN MILLIMETERS	
0 PLACE DECIMAL: ±0.5		ANGLE: ±0.13	
1 PLACE DECIMAL: ±0.25		SURFACE ROUGHNESS 1.6/√	
2 PLACE DECIMAL: ±0.13			

Laird™ **CONNECTIVITY**
 PENANG, MALAYSIA

TITLE: **TRAB9023P/ TRA9023P MOUNTING & OUTLINE**

SIZE	DWG. NO.	REV
A3	TRAB9023PMO	F01
SCALE: 1:1	PREVIOUS#	SHEET 1 OF 1

UNLESS OTHERWISE NOTED, THIS DOCUMENT CONTAINS LAIRD TECHNOLOGIES CONFIDENTIAL INFORMATION. REPRODUCTION, USE, DISCLOSURE OR TRANSMITTAL OF ALL OR ANY PART OF THIS DOCUMENT IS PROHIBITED EXCEPT TO THE EXTENT APPROVED IN WRITING BY AN AUTHORIZED REPRESENTATIVE OF LAIRD TECHNOLOGIES. LAIRD TECHNOLOGIES RESERVES ALL RIGHTS UNDER PATENTS, TRADEMARKS, COPYRIGHTS AND TRADE SECRETS. COPYRIGHT, LAIRD TECHNOLOGIES 2014, ALL RIGHTS RESERVED.