

REVISIONS				
P.	LTN	DESCRIPTION	DATE	OWN APVD
A		RELEASED	27JUL17	RZ JY
A1		REVISED ECO-17-005347	05SEP17	RZ JY

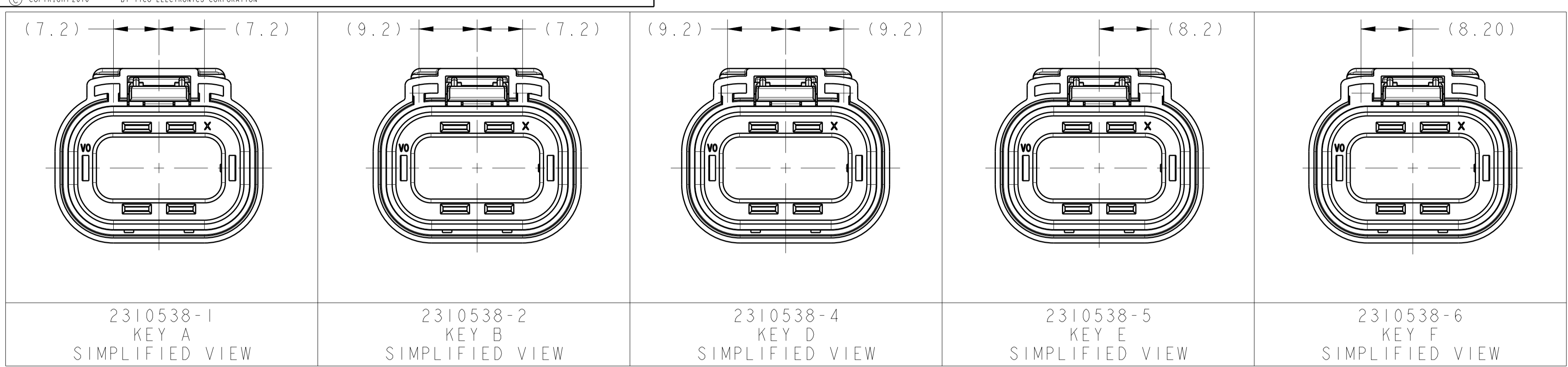

2310538-1 KEY A SIMPLIFIED VIEW 2310538-2 KEY B SIMPLIFIED VIEW 2310538-4 KEY D SIMPLIFIED VIEW 2310538-5 KEY E SIMPLIFIED VIEW 2310538-6 KEY F SIMPLIFIED VIEW

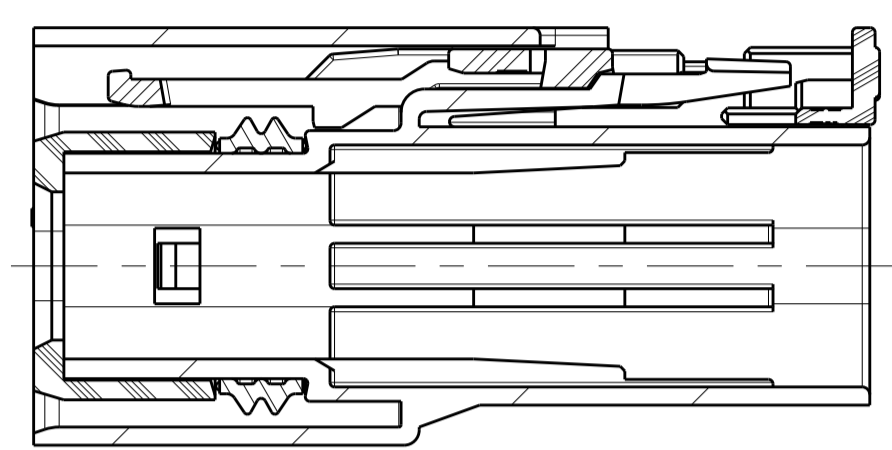
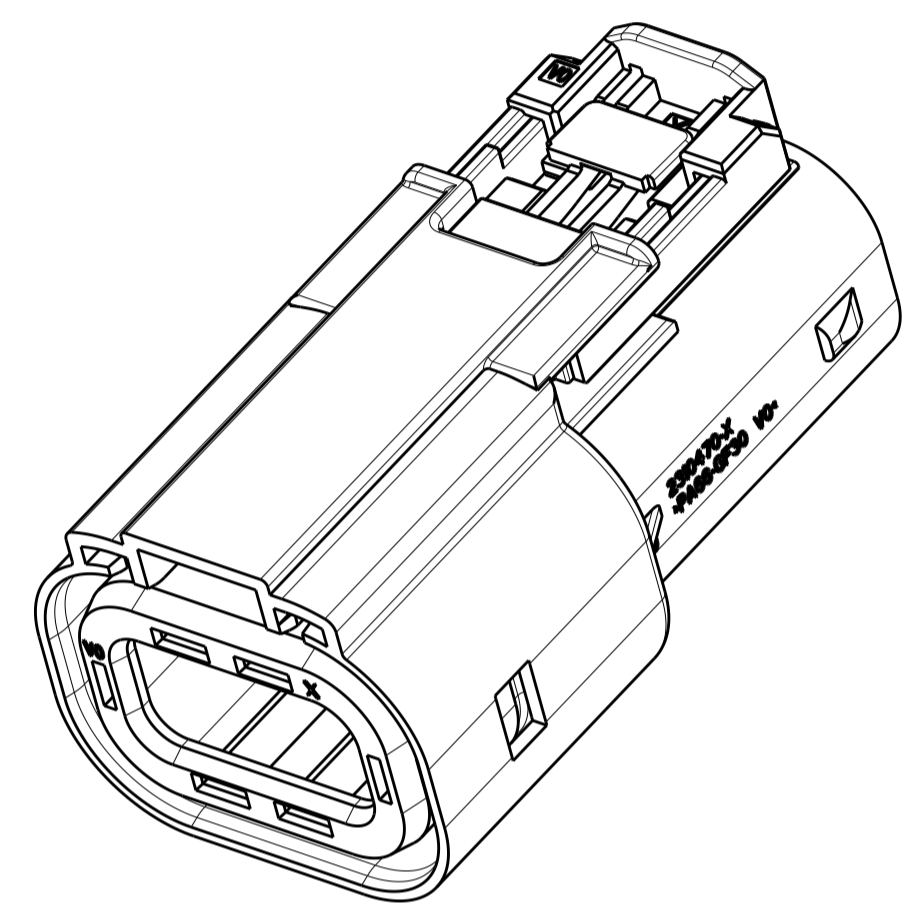

A-A

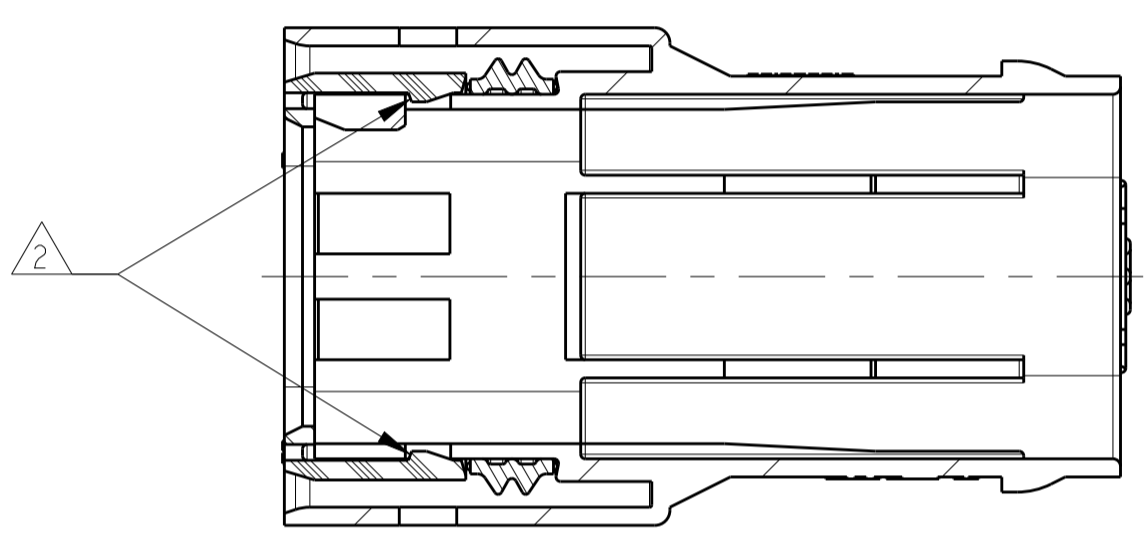

B-B

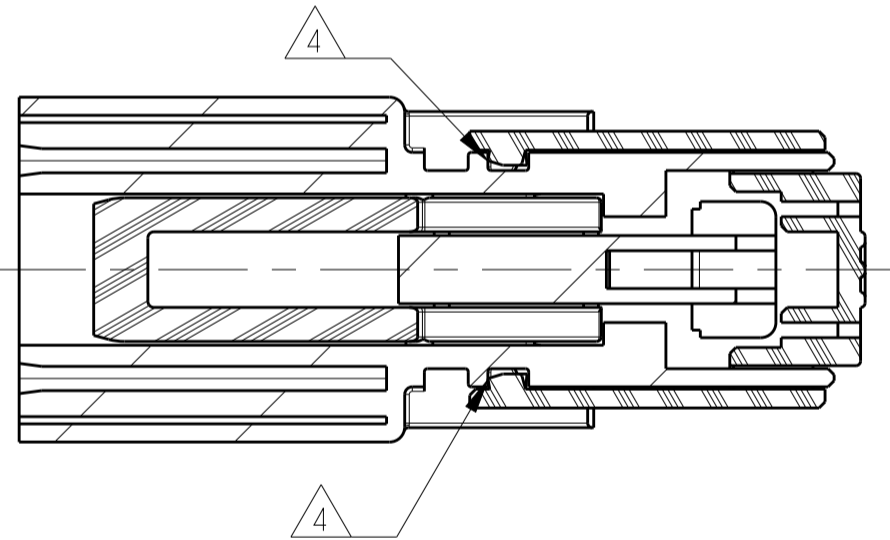

C-C

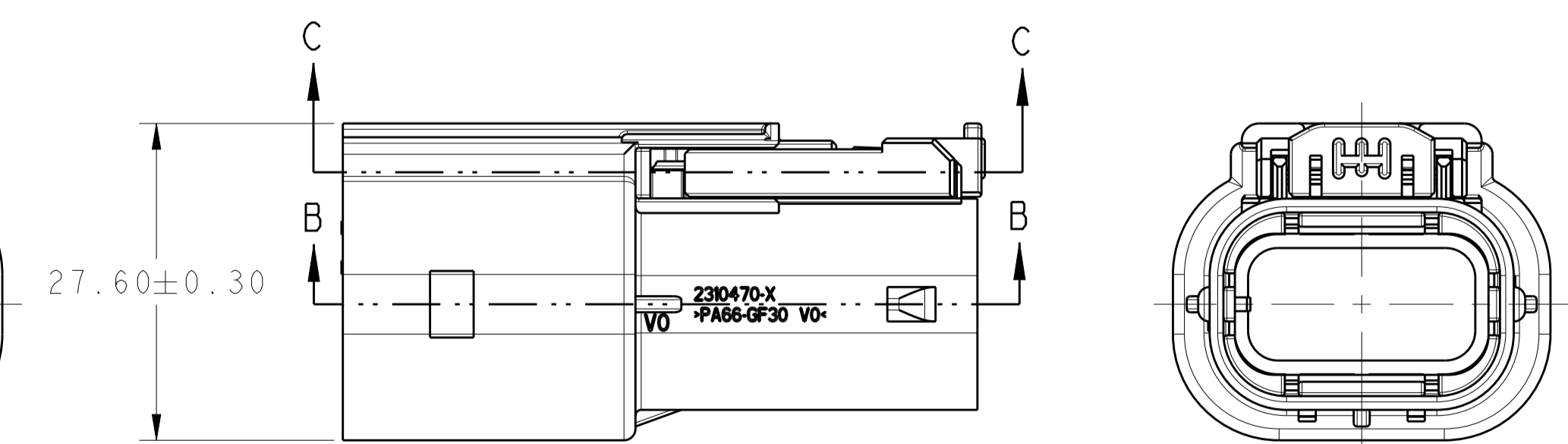
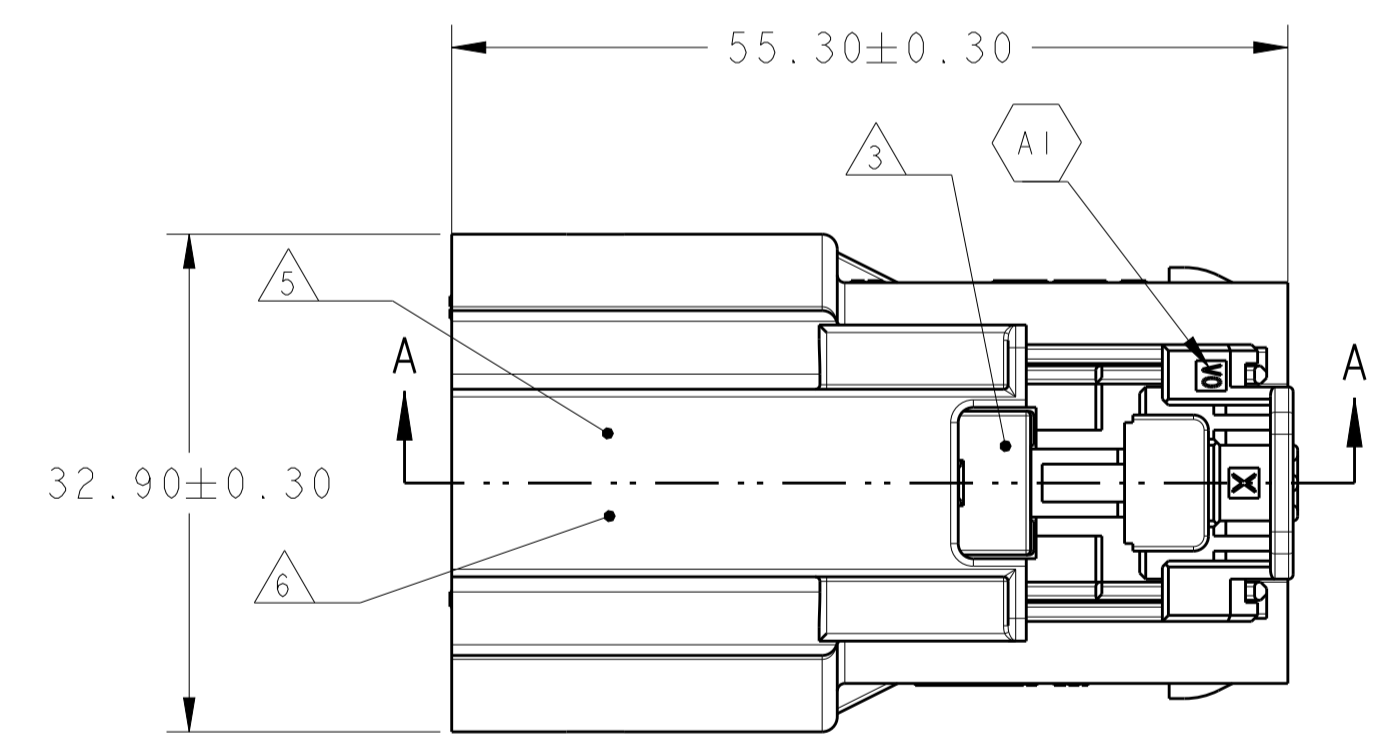

NOTES:

- CONNECTOR MUST BE FREE OF ANY MECHANICAL DEFECTS WHICH COULD NEGATIVELY AFFECT FIT, FUNCTION, OR PERFORMANCE
- PERIPHERAL SEAL RETAINER MUST BE FULLY LOCKED IN TWO LOCATIONS INTO OUTER HOUSING
- FLOATING LATCH MUST INSTALLED AS SHOWN
- ON APPLICABLE ASSEMBLIES CPA MUST INSTALLED IN PRE-STAGE POSITION AS SHOWN
- ASSEMBLY DATE CODE IN THIS LOCATION AT ASSEMBLY
- TE PART NUMBER IN THIS LOCATION AT ASSEMBLY
- ALL PLASTIC PARTS ARE UL94 V0 FLAME RETARDANT MATERIAL
- FOR HB VERSION REFER TO DRAWING 2103015

- 1 AS SHOWN

DESCRIPTION	INDEX CODE	REV	PART NO
F	A		2310538-6
E	A		2310538-5
D	A		2310538-4
B	A		2310538-2
A	A		2310538-1

THIS DRAWING IS A CONTROLLED DOCUMENT.		OWN: R. ZHANG 15OCT2016	TE Connectivity	
DIMENSIONS: mm		CHK: S.Y. WANG 10JUL2017		
TOLERANCES UNLESS OTHERWISE SPECIFIED:		APVD: J. YIN 27JUL2017	NAME: PLUG SUB-ASSEMBLY, HVA280-2PHM	
0 PLC ±	1 PLC ±0.2	PRODUCT SPEC: 108-32020	SIZE: A1	
2 PLC ±0.10	3 PLC ±	APPLICATION SPEC: 114-13310	CAGE CODE: -	
4 PLC ±	ANGLES ±1°	WEIGHT: 15.7 g	DRAWING NO: C=2310538	
CUSTOMER DRAWING		SCALE: 2:1	SHEET 1 OF 1	