

THIS DRAWING IS A CONTROLLED DOCUMENT

DWG NO FDBA_5X_++

Example of order : FDBA 5 X X XX - XX X X - K XXXX

CONNECTOR TYPE
Standard and Hermetic

VERSION
5 - Standard

SHELL TYPE
0 Square Flange Receptacle
4 Jam-nut Mounting Receptacle
6 Plug
7 Plug with RFI (RADIO FREQUENCY INTERFERENCE) fingers

VERSION
H - Hermetic
Without Index - Sealed

SHELL SIZE
08-10-12-14-16-18-20-22-24

ARRANGEMENTS
As per EN3646

CONTACT TYPE
P Male Contact
S Female Contact

INSERT CLOCKING POSITION
N Normal
W-X-Y-Z Others

INDEX
Connector Evolution

Special Modifications

- 059 Straight Cable Clamp
- 081 Elbowed Cable Clamp
- 090 Delivery without contact
- A246 Size 20 contact in accordance with ASNE
- A499 Nickel version connector
- A838 Olive drab cadmium
- B246 Hybrid arrangement size 20 & 16 in accordance with ASNE
- A377 PC tail connector

For Olive Drab Cadmium plating (A838) - Teeth over the entire periphery

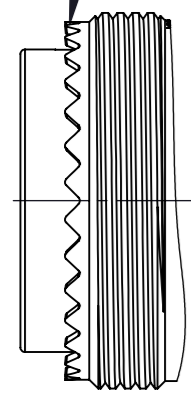

CHARACTERISTIQUES

1. Shell material : Sealed Version - Aluminium alloy
Hermetic version - Stainless Steel
2. Insert material : Sealed Version - Thermosetting elastomer
Hermetic version - Sintered glass insert
3. Plating : Black Anodize, Nickel or Cadmium plated Aluminium shells.
Hermetics are nickel plated steel.
3. Service Temperature : -55°C to +200°C
4. Service Voltage : 500 V eff. ; 50 Hz

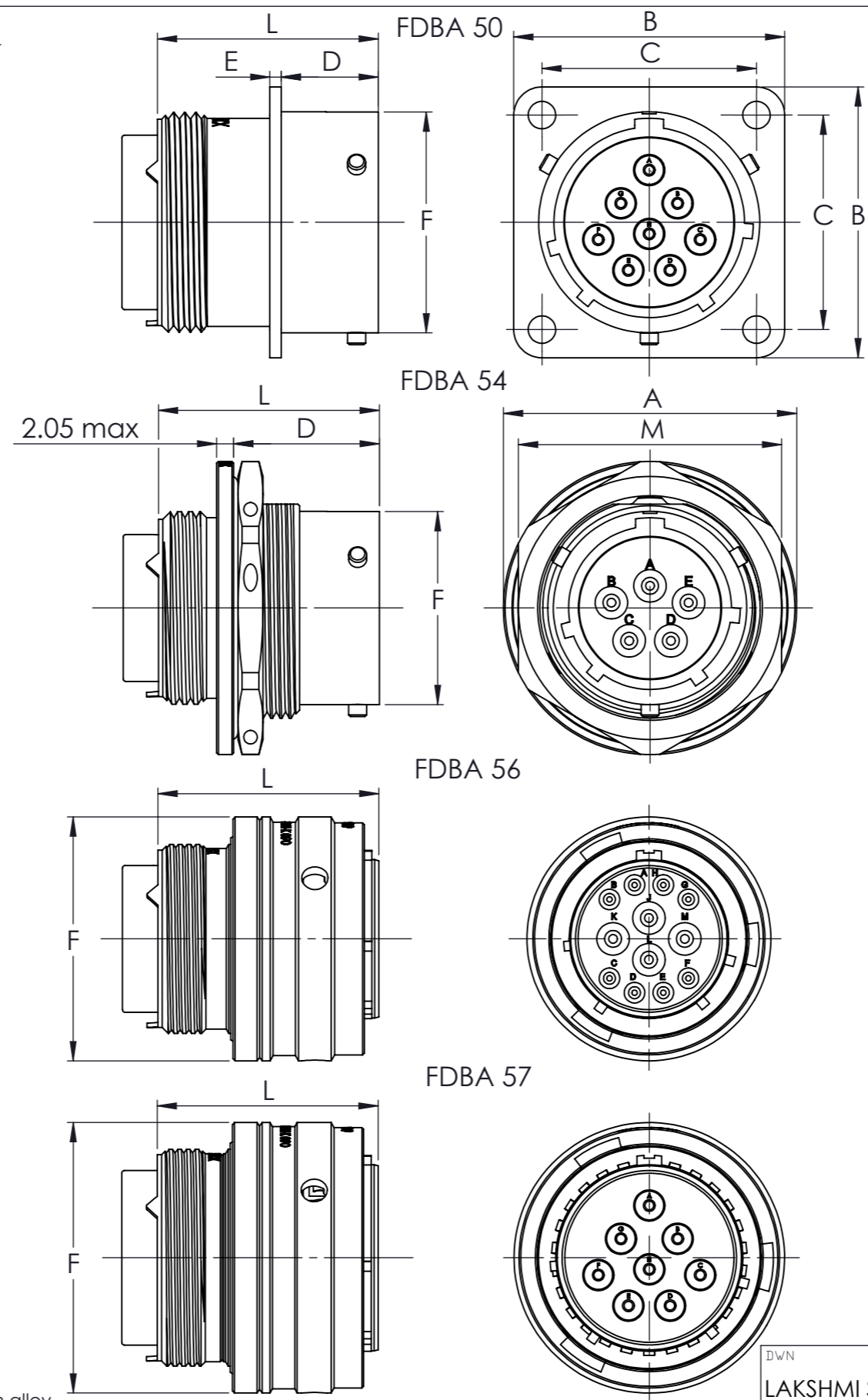

USED ON -

FDBA 50

Size	08	10	12	14	16	18	20	22	24
B max.	21.00	24.25	26.60	29.00	31.30	33.70	36.85	39.95	43.15
C ±0.1	15.08	18.26	20.62	23.02	24.58	26.98	29.36	31.76	34.92
D ±0.15	11.13	11.13	11.13	11.13	11.13	11.13	14.85	14.85	15.70
E max.	1.45	1.45	1.45	1.45	1.45	1.45	2.25	2.25	2.25
F max.	12.03	15.01	19.07	22.24	25.42	28.60	31.77	34.94	38.12
L max.	25.50	25.50	25.50	25.50	25.50	25.50	27.95	27.95	27.95

FDBA 54

Size	08	10	12	14	16	18	20	22	24
A max.	23.30	26.60	30.40	33.80	37.00	40.15	45.20	48.35	51.55
D ±0.1	11.13	11.13	11.13	11.13	11.13	11.13	14.85	14.85	15.70
F max.	12.03	15.01	19.07	22.24	25.42	28.60	31.77	34.94	38.12
L max.	25.50	25.50	25.50	25.50	25.50	25.50	27.95	27.95	27.95
M max.	19.20	22.37	27.12	30.30	33.47	36.67	39.82	43.02	46.17

FDBA 56 & 57

Size	08	10	12	14	16	18	20	22	24
F max.	17.75	21.05	24.60	28.05	31.10	34.40	37.65	40.90	44.10
L max.	25.55	25.55	25.55	25.55	25.55	25.55	27.10	27.10	27.10

Shell type 57 with RFI fingers must be ordered in accordance with part numbering system with the modification A499 (Nickel version connector)

DIMENSIONS: MM		TOLERANCES UNLESS OTHERWISE SPECIFIED:	
	0 PLC	±	±
	1 PLC	±	±0.05
	2 PLC	±	±0.05
	3 PLC	±	±0.02
	4 PLC	±	±

DWN	LAKSHMI SUDHA R	MATERIAL	-	HEAT TREAT	-
CHK	RAKESH S	TE Connectivity			
APVD	VINCENT P				
NAME	FDBA 50,54,56,57 SERIES				
SCALE	2:1	SIZE	A3	DRAWING NO	FDBA_5X_++
SHEET	1	OF	1	REV	A