

7

6

5

4

3

2

1

REVISIONS				
EC NO	DATE	REV	DESCRIPTION	CHANGER
N/A	2013/12/16	A	INITIAL RELEASE.	IFEI

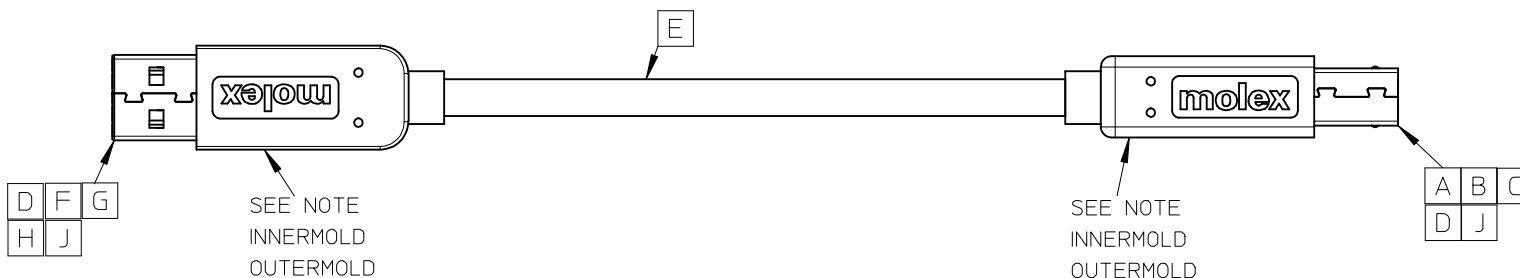
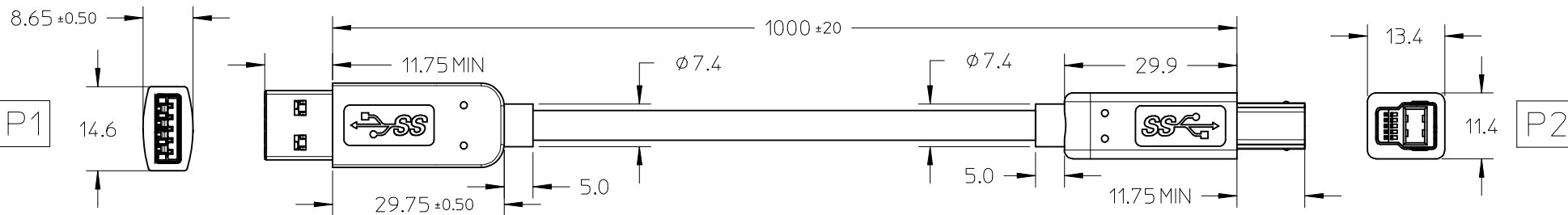
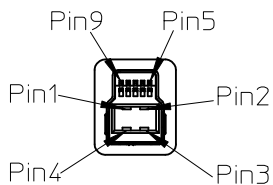
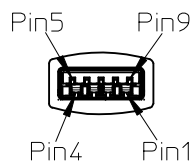

WIRING CHART			
P1	SIGNAL NAME	WIRE COLOUR	P2
1	VBUS	RED	1
2	D-	WHITE	2
3	D+	GREEN	3
4	GND	BLACK	4
5	Std_SSRX-	BLUE	5
6	Std_SSRX+	YELLOW	6
7	GND_DRAIN	GND_DRAIN	7
8	Std_SSTX-	PURPLE	8
9	Std_SSTX+	ORANGE	9
SHELL	SHIELD	BRAID	SHELL

J	HST F 1.5MM 125C (UL) BLK HF	A/R	1
H	FRONT METAL FOR STD A PLUG		1
G	USB 3.0 STD A CONNECTOR ASSY		1
F	REAR METAL FOR STD A PLUG		1
E	USB 3.0 CABLE(2P+1P)*28*2C*24,SHLD,PVC,BK,5.0,UL2725	A/R	1
D	PRE-CUT COPPER FOIL 25*5		2
C	REAR METAL SHELL FOR B PLUG		1
B	STD B CONNECTOR ASSY		1
A	FRONT METAL SHELL FOR B PLUG		1
ITEM	DESCRIPTION	L(MM)	Q'TY

SEE REVISIONS EC NO: CPG2014-2080 DRWN: IFEI 2014/01/16 CHKD: APPR: RTSAI 2014/01/17	QUALITY SYMBOLS $\nabla_F = 0$ $\nabla_F = 0$ $\nabla_F = 0$	GENERAL TOLERANCES (UNLESS SPECIFIED)		DIMENSION STYLE MM ONLY		SCALE 1:1	DESIGN UNITS METRIC	THIRD ANGLE PROJECTION																					
		<table border="1"> <thead> <tr> <th></th> <th>mm</th> <th>INCH</th> </tr> </thead> <tbody> <tr> <td>4 PLACES</td> <td>± ---</td> <td>± ---</td> </tr> <tr> <td>3 PLACES</td> <td>± ---</td> <td>± ---</td> </tr> <tr> <td>2 PLACES</td> <td>± 0.25</td> <td>± ---</td> </tr> <tr> <td>1 PLACE</td> <td>± 0.5</td> <td>± ---</td> </tr> <tr> <td>0 PLACE</td> <td>± ---</td> <td>± ---</td> </tr> </tbody> </table>			mm	INCH	4 PLACES	± ---	± ---	3 PLACES	± ---	± ---	2 PLACES	± 0.25	± ---	1 PLACE	± 0.5	± ---	0 PLACE	± ---	± ---	DRAWN BY DATE IFEI 2014/01/16		TITLE USB 3.0 A MALE TO B MALE 1M		APPROVED BY DATE RTSAI 2014/01/17		molex	
			mm	INCH																									
		4 PLACES	± ---	± ---																									
3 PLACES	± ---	± ---																											
2 PLACES	± 0.25	± ---																											
1 PLACE	± 0.5	± ---																											
0 PLACE	± ---	± ---																											
ANGULAR ± 3 °		MATERIAL NO. 687890004		DOCUMENT NO. SD-68789-010		SHEET NO. 1 OF 2		DRAFT WHERE APPLICABLE MUST REMAIN WITHIN DIMENSIONS																					
SIZE $\Delta 4$		THIS DRAWING CONTAINS INFORMATION THAT IS PROPRIETARY TO MOLEX INCORPORATED AND SHOULD NOT BE USED WITHOUT WRITTEN PERMISSION																											

6

5

4

3

2

1

NOTE:

- 1. OVERMOLDING SPECIFICATION:**
 - 1.1 INNER MOLDING: PE RESIN
 - 1.2 OUTER MOLDING: PVC RESIN
- 2. APPLICATION CONDITION**
 - 2.1 WORKING TEMPERATURE: 0° — +50°
 - 2.2 STORAGE TEMPERATURE: -20° — +60°
- 3. MECHANICAL PERFORMACNE**
 - 3.1. CABLE ASSLY CAN PASS FLEXING TEST IN 100 CYCLES AT EACH OF 2 PLANES, PER EIA364-41 CONDITION I.
 - 3.2. CABLE ASSEMBLY SR AREA SHOULD WITHSTAND A PULL FORCE 40N FOR ONE MINUTE WITHOUT COSMETIC AND FUNCTION DAMAGE.
- 4. ELECTRICAL PERFORMACNE**
 - 4.1 CURRENT RATING:1.8A FOR POWER WIRE/ 0.25A FOR SIGNAL WIRE
 - 4.2 VOLTAGE RATING:30V AC
- 5. THIS PRODUCT MUST MEET THE EU RoHS CHEMICAL SUBSTANCES SPECIFICATION FOR PRODUCTS (2011/65/EU).**

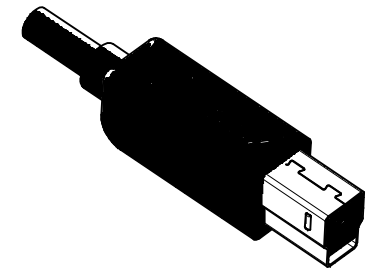
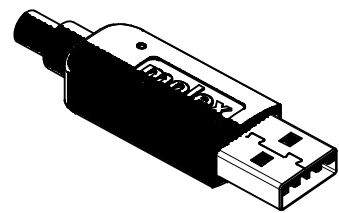
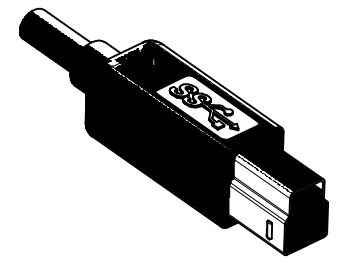
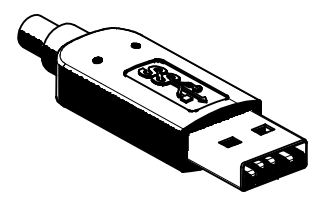

SEE REVISIONS EC NO: CPG2014-2080 DRWN:IFEI 2014/01/16 CHKD: APPR:RTSAI 2014/01/17	DESCRIPTION REV	QUALITY SYMBOLS	GENERAL TOLERANCES (UNLESS SPECIFIED)		DIMENSION STYLE MM ONLY		SCALE 1:1	DESIGN UNITS METRIC	THIRD ANGLE PROJECTION		
		▽Fa=0	4 PLACES ± --- ± ---	mm	INCH	DRAWN BY IFEI	DATE 2014/01/16	TITLE USB 3.0 A MALE TO B MALE 1M			
		▽Fb=0	3 PLACES ± --- ± ---			CHECKED BY	DATE				
		▽Fc=0	2 PLACES ± 0.25 ± ---			APPROVED BY RTSAI	DATE 2014/01/17	<div style="text-align: center; font-size: 2em; font-weight: bold;">molex</div> DOCUMENT NO. SD-68789-010 SHEET NO. 2 OF 2			
			1 PLACE ± 0.5 ± ---			MATERIAL NO. 687890004					
	0 PLACE ± --- ± ---	ANGULAR ± 3 °		SIZE A 4		THIS DRAWING CONTAINS INFORMATION THAT IS PROPRIETARY TO MOLEX INCORPORATED AND SHOULD NOT BE USED WITHOUT WRITTEN PERMISSION					
DRAFT WHERE APPLICABLE MUST REMAIN WITHIN DIMENSIONS											