

LOC	DIST	REVISIONS			
P	LTR	DESCRIPTION	DATE	DWN	APVD
1K	2	A	RELEASED	11JUL2011	LC JS
		B	SEE ECR-11-024446	13DEC2011	LC JS

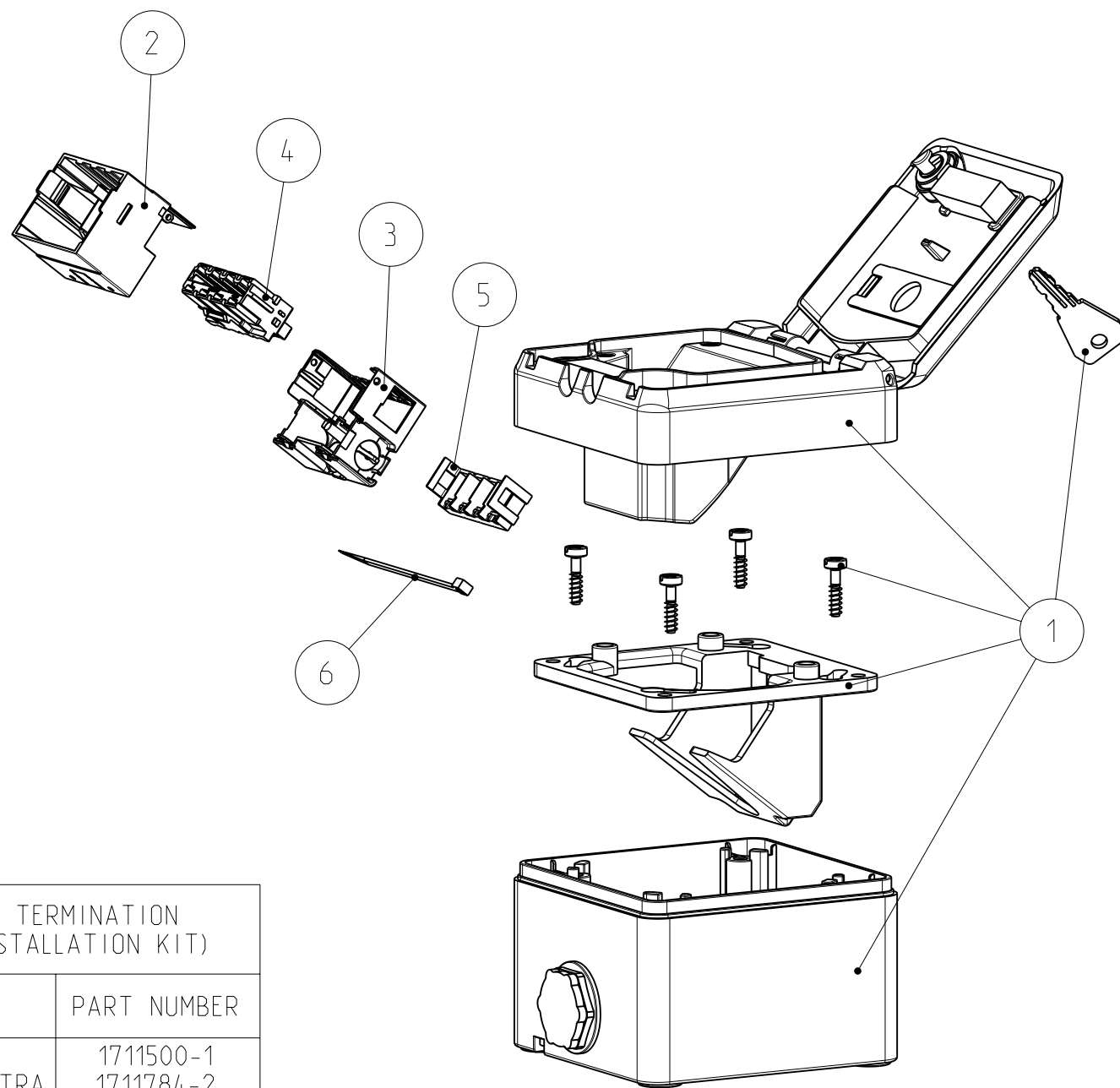

1. PACKAGING UNIT:  
 1 INSTALLATION KIT  
 + 1 APPLICATION SPEC. 114-93018  
 + 1 APPLICATION SPEC. 114-93022  
 PACKED INTO CARDBOARD BOX

REQUIRED TOOL FOR TERMINATION (NOT INCLUDED IN INSTALLATION KIT)	
DESCRIPTION	PART NUMBER
PISTOL-GRIP TOOL	1711500-1
ADAPTER FOR AMP CO ULTRA	1711784-2
ALTERNATIVE TOOL: IMPACT TOOL	1375308-1 1583608-1

ACCESSORY PARTS (NOT INCLUDED IN INSTALLATION KIT)	
DESCRIPTION	PART NUMBER
AMP CO INSERTS	SEE CATALOGUE
LABELS FOR AMP CO DUAL INSERTS	2-0101021-X

1	APPL. SPEC. IP44 114-93022	8
1	APPL. SPEC. HOUSING 114-93018	7
1	CABLE TIE	6
1	COVER SHIELDED EDGE CONNECTOR	5
1	SUBASSY SHIELDED EDGE CONNECTOR	4
1	BACK AMP CO HOUSING WITH LABEL	3
1	FRONT AMP CO HOUSING WITHOUT DOVETAIL	2
1	IP44 OUTLET FOR AMP CO	1
-1		
QTY	DESCRIPTION	ITEM

THIS DRAWING IS A CONTROLLED DOCUMENT.		DWN L. COBACHO 11JUL2011	<b>STE</b> TE Connectivity	
DIMENSIONS: mm		CHK J. GATNAU 11JUL2011		
TOLERANCES UNLESS OTHERWISE SPECIFIED:		APVD J. SANABRA 11JUL2011	NAME AMP CO ULTRA INDUSTRIAL KIT	
0 PLC ±-		PRODUCT SPEC 108-93037	DUAL OUTLET IP44	
1 PLC ±-		APPLICATION SPEC 114-93018	SIZE A3	RESTRICTED TO -
2 PLC ±-		- 114-93022	CAGE CODE -	DRAWING NO ©=1711873
3 PLC ±-		WEIGHT -	SCALE 1:2	SHEET 1 OF 1
4 PLC ±-		CUSTOMER DRAWING	REV B	
ANGLES ±				
FINISH -				