

DESIGNED & DIMENSIONED
IN MILLIMETERS [INCHES]

DO NOT
SCALE FROM
THIS PRINT

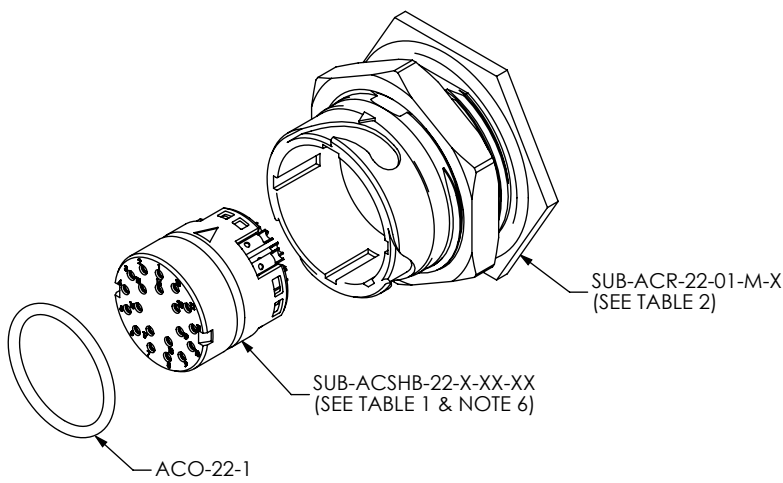

FIG 1
ACRC-22-02-X-S-X-M-1 SHOWN

ACRC-22-XX-X-X-XX-M-X

RECEPTACLE KIT
SIZE

KEY FEATURE (SEE NOTE 2, SHT. 4)
-1: ORANGE
-2: GREEN
-3: BLUE
-4: YELLOW

STYLE
-M: METAL

TERMINATION (SEE SHT. 4)
-C: SOLDER CUP
-B1: .062 BOARD MOUNT (NOT AVAILABLE WITH -04, OR -06 LEADSTYLES.)

GENDER
-T: TERMINAL
-S: SOCKET

PLATING
-G: 10µ" GOLD ON CONTACT
-H: 30µ" GOLD ON CONTACT

LEAD STYLE
-01: 30 POS (1.0 TERM/SKT), 20 - 24 AWG
-02: 20 POS (1.0 TERM/SKT), 20 - 24 AWG
-03: 8 POS PWR (1.5 TERM/SKT), 14 - 18 AWG
* -04: 6 POS (COAX PLUG/JACK), CCA-316
-05: 20 POS COMBO (4 X 1.5 TERM/SKT, 14 - 18 AWG) (16 X 1.0 TERM/SKT, 20 - 24 AWG)
* -06: 16 POS COMBO (4 X COAX PLUG/JACK, CCA-316) (12 X 1.0 TERM/SKT, 20 - 24 AWG)

* = NOT RELEASED FOR PRODUCTION

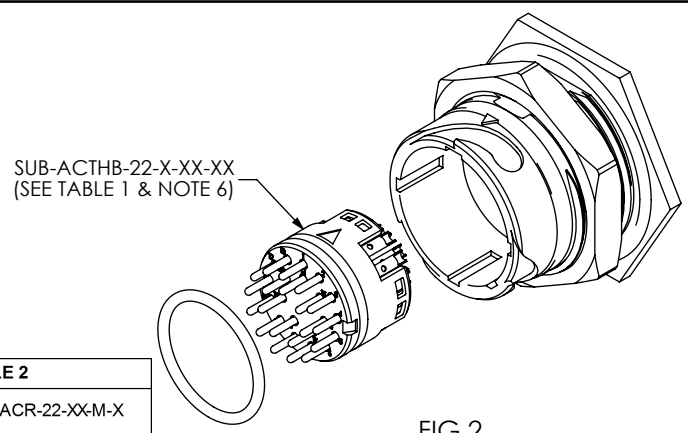

FIG 2
ACRC-22-02-X-T-X-M-1 SHOWN
(SAME AS FIG 1, EXCEPT AS SHOWN)

TABLE 2	
KEY FEATURE	SUB-ACR-22-XX-M-X
-1	SUB-ACR-22-01-M-1
-2	SUB-ACR-22-01-M-2
-3	SUB-ACR-22-01-M-3
-4	SUB-ACR-22-01-M-4

TABLE 1							
LEAD STYLES	GENDER	TERMINATION					
		-C: SOLDER CUP			-B1: BOARD MOUNT		
		SUB-ASSEMBLY/HOLDER BODY PART #		COAX PLUG/JACK PART #		SUB-ASSEMBLY PART #	
		PLATING					
		-G	-H	AC-X-C-H-ST-CA1	QTY	-G	-H
-01	-T	SUB-ACTHB-22-G-01	SUB-ACTHB-22-H-01	NA		SUB-ACTHB-22-G-01-B1	SUB-ACTHB-22-H-01-B1
-02	-T	SUB-ACTHB-22-G-02	SUB-ACTHB-22-H-02	NA		SUB-ACTHB-22-G-02-B1	SUB-ACTHB-22-H-02-B1
-03	-T	SUB-ACTHB-22-G-03	SUB-ACTHB-22-H-03	NA		SUB-ACTHB-22-G-03-B1	SUB-ACTHB-22-H-03-B1
* -04	-T	ACTHB-22-6	ACTHB-22-6	AC-P-C-H-ST-CA1	6	NA	NA
* -05	-T	SUB-ACTHB-22-G-05	SUB-ACTHB-22-H-05	NA		SUB-ACTHB-22-G-05-B1	SUB-ACTHB-22-H-05-B1
* -06	-T	SUB-ACTHB-22-G-06	SUB-ACTHB-22-H-06	AC-P-C-H-ST-CA1	4	NA	NA
-01	-S	SUB-ACSHB-22-G-01	SUB-ACSHB-22-H-01	NA		SUB-ACSHB-22-G-01-B1	SUB-ACSHB-22-H-01-B1
-02	-S	SUB-ACSHB-22-G-02	SUB-ACSHB-22-H-02	NA		SUB-ACSHB-22-G-02-B1	SUB-ACSHB-22-H-02-B1
-03	-S	SUB-ACSHB-22-G-03	SUB-ACSHB-22-H-03	NA		SUB-ACSHB-22-G-03-B1	SUB-ACSHB-22-H-03-B1
* -04	-S	ACSHB-22-6	ACSHB-22-6	AC-J-C-H-ST-CA1	6	NA	NA
* -05	-S	SUB-ACSHB-22-G-05	SUB-ACSHB-22-H-05	NA		SUB-ACSHB-22-G-05-B1	SUB-ACSHB-22-H-05-B1
* -06	-S	SUB-ACSHB-22-G-06	SUB-ACSHB-22-H-06	AC-J-C-H-ST-CA1	4	NA	NA

NOTES:

1. KIT COMPONENTS TO BE PACKAGED IN BAGS PER PACKAGING STANDARD CO-RF-WI-3001-M.
2. KEY FEATURE DETERMINES COLOR OF COLOR KEY RING AND DUSTCAP LANYARD IF APPLICABLE.
3. REFER TO DCA-ACR-22-M-X PRINT FOR DUST CAP.
4. PANEL THICKNESS RANGE: 0.80[.031] - 5.20[.205].
5. TORQUE SPECIFICATION FOR PANEL NUT: 1.7Nm[15.00 IN-LB] - 2.3Nm[20IN-LB].
6. RECOMMENDED INSERTION TOOL: CAT-AC-22-M.
7. NOTE DELETED.

UNLESS OTHERWISE SPECIFIED, DIMENSIONS ARE IN MILLIMETERS. TOLERANCES ARE:
DECIMALS ANGLES
X.X: ±0.3 [.01] 2°
X.XX: ±0.13 [.005]
X.XXX: ±0.051 [.0020]

PROPRIETARY NOTE
THIS DOCUMENT CONTAINS INFORMATION CONFIDENTIAL AND PROPRIETARY TO SAMTEC, INC. AND SHALL NOT BE REPRODUCED OR TRANSFERRED TO OTHER DOCUMENTS OR DISCLOSED TO OTHERS OR USED FOR ANY PURPOSE OTHER THAN THAT WHICH IT WAS OBTAINED WITHOUT THE EXPRESSED WRITTEN CONSENT OF SAMTEC, INC.

samtec
520 PARK EAST BLVD, NEW ALBANY, IN 47150
PHONE: 812-944-6733 FAX: 812-948-5047
e-Mail: info@SAMTEC.com code 53322

MATERIAL: DO NOT SCALE DRAWING SHEET SCALE: 1:1
SHELL: ZAMAK 3
INSULATOR: PBT, COLOR: BLACK
O-RING: NITRILE
NUT: BRASS
COLOR RING: SILICONE
TERMINALS: BRASS
CONTACTS: BRASS/BeCu

DESCRIPTION:
ACCLIMATE CIRC. FIELD TERM. KIT
DWG. NO.
ACRC-22-XX-X-X-XX-M-X
BY: VICKY Z 06/16/2011 SHEET 1 OF 4

-T END OPTIONS

-01: 30 POS
Ø 1.0 TERMINALS

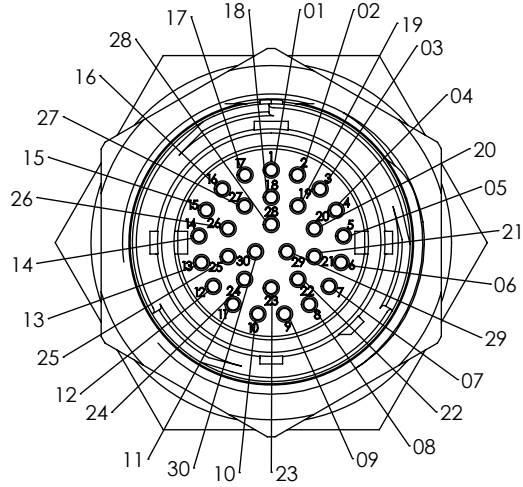

-02: 20 POS
Ø 1.0 TERMINALS

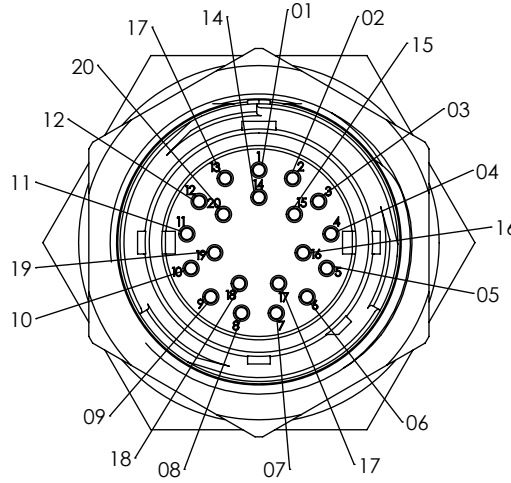

-03: 8 POS
Ø 1.5 TERMINALS

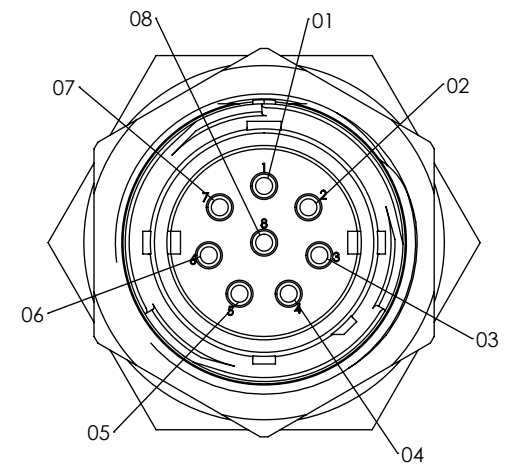

*-04: 6 POS
COAX PLUG

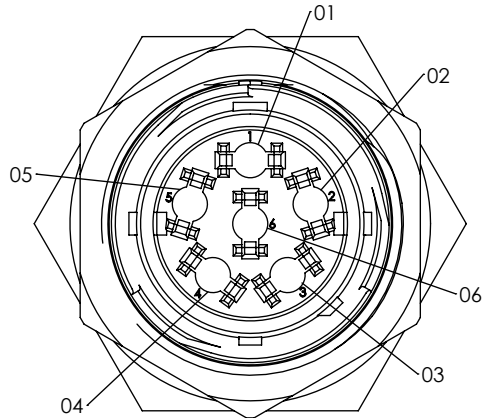

-05: 20 POS COMBO
16 X Ø 1.0 TERMINALS
4 X Ø 1.5 TERMINALS

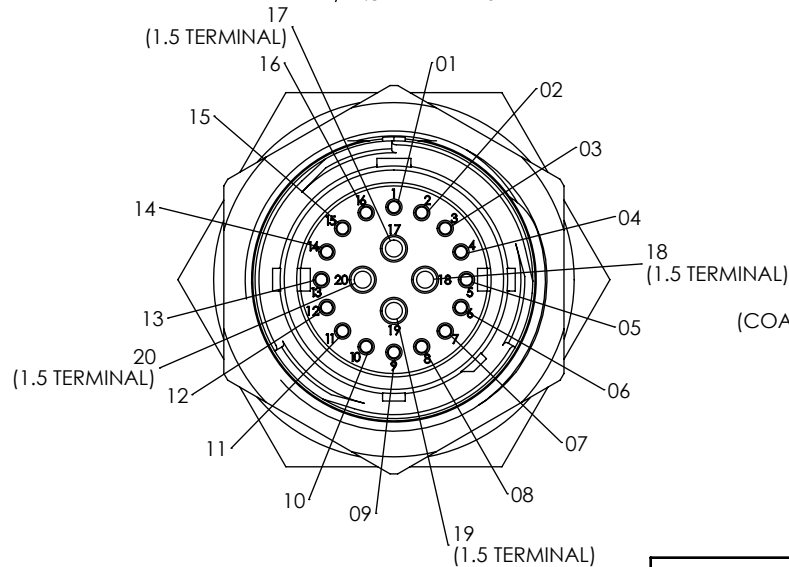

*-06: 16 POS COMBO
4 X COAX PLUG
12 X Ø 1.0 TERMINALS

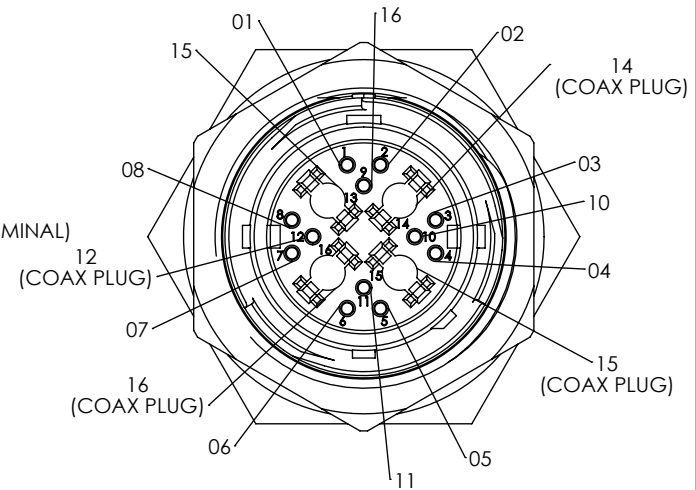

* = NOT RELEASED FOR PRODUCTION

PROPRIETARY NOTE
THIS DOCUMENT CONTAINS CONFIDENTIAL AND PROPRIETARY INFORMATION AND ALL DESIGN, MANUFACTURING, REPRODUCTION, USE, PATENT RIGHTS AND SALES RIGHTS ARE EXPRESSLY RESERVED BY SAMTEC, INC. THIS DOCUMENT SHALL NOT BE DISCLOSED, IN WHOLE OR PART, TO ANY UNAUTHORIZED PERSON OR ENTITY NOR REPRODUCED, TRANSFERRED OR INCORPORATED IN ANY OTHER PROJECT IN ANY MANNER WITHOUT THE EXPRESS WRITTEN CONSENT OF SAMTEC, INC.

DO NOT SCALE DRAWING

SHEET SCALE: 1.5:1

samtec

520 PARK EAST BLVD, NEW ALBANY, IN 47150
PHONE: 812-944-6733 FAX: 812-948-5047
e-Mail info@SAMTEC.com code 55322

DESCRIPTION: ACCLIMATE CIRC. FIELD TERM. KIT

DWG. NO. ACRK-22-XX-X-X-XX-M-X

BY: VICKY Z 06/16/2011 SHEET 2 OF 4

-S END OPTIONS

-01: 30 POS
Ø 1.0 SOCKETS

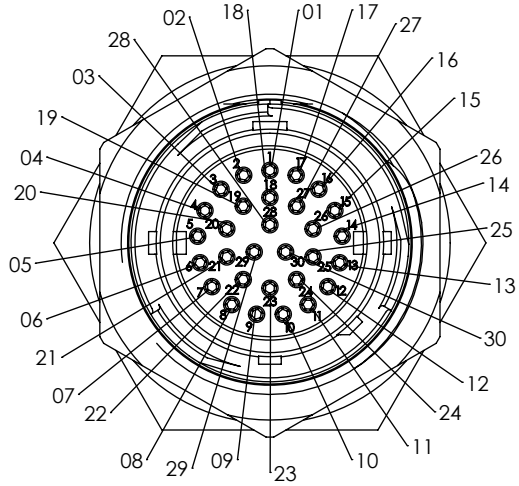

-02: 20 POS
Ø 1.0 SOCKETS

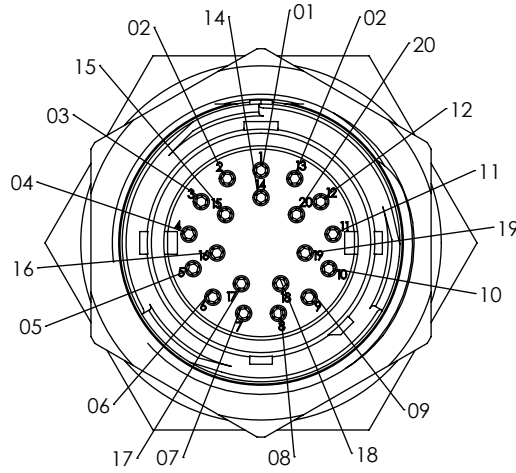

-03: 8 POS
Ø 1.5 SOCKETS

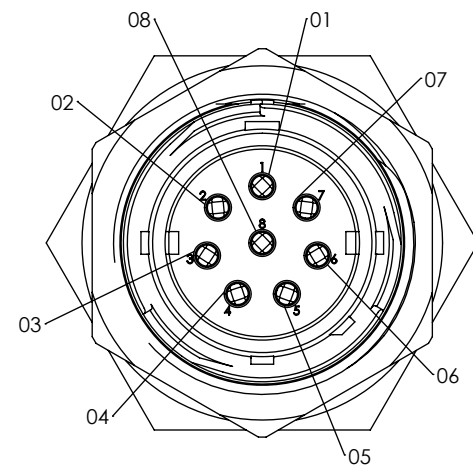

*-04: 6 POS
COAX JACK

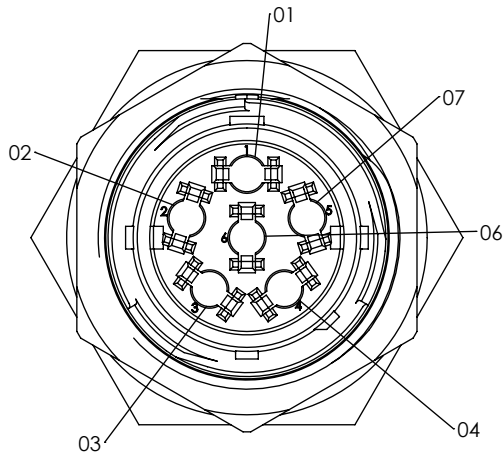

-05: 20 POS COMBO
16 X Ø 1.0 SOCKETS
4 X Ø 1.5 SOCKETS

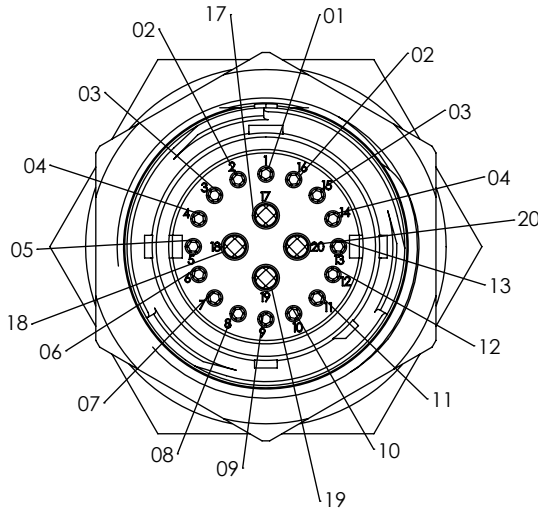

*-06: 16 POS COMBO
4 X COAX JACK
12 X Ø 1.0 SOCKETS

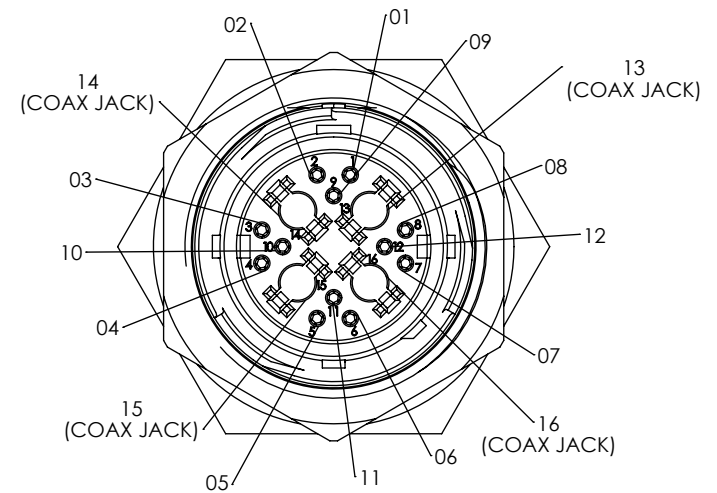

* = NOT RELEASED FOR PRODUCTION

PROPRIETARY NOTE
THIS DOCUMENT CONTAINS CONFIDENTIAL AND PROPRIETARY INFORMATION AND ALL DESIGN, MANUFACTURING, REPRODUCTION, USE, PATENT RIGHTS AND SALES RIGHTS ARE EXPRESSLY RESERVED BY SAMTEC, INC. THIS DOCUMENT SHALL NOT BE DISCLOSED, IN WHOLE OR PART, TO ANY UNAUTHORIZED PERSON OR ENTITY NOR REPRODUCED, TRANSFERRED OR INCORPORATED IN ANY OTHER PROJECT IN ANY MANNER WITHOUT THE EXPRESS WRITTEN CONSENT OF SAMTEC, INC.

DO NOT SCALE DRAWING

SHEET SCALE: 1.5:1

samtec

520 PARK EAST BLVD, NEW ALBANY, IN 47150
PHONE: 812-944-6733 FAX: 812-948-5047
e-Mail info@SAMTEC.com code 55322

DESCRIPTION: ACCLIMATE CIRC. FIELD TERM. KIT

DWG. NO. ACRK-22-XX-X-X-XX-M-X

BY: VICKY Z 06/16/2011 SHEET 3 OF 4

REVISION B

-C: SOLDER CUP
ACRK-22-01-X-S-C-M-1 SHOWN

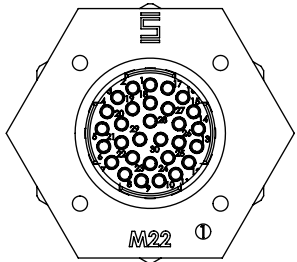
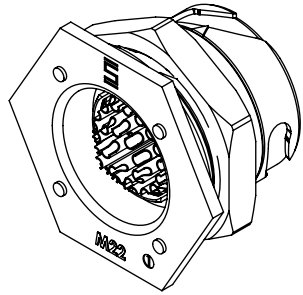

-B1: BOARD MOUNT
ACRK-22-02-X-S-B1-M-1 SHOWN

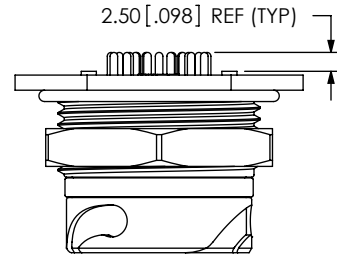
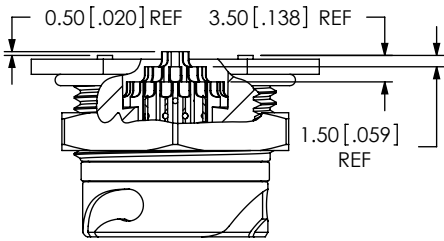
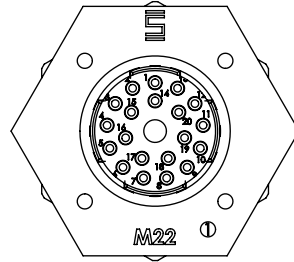
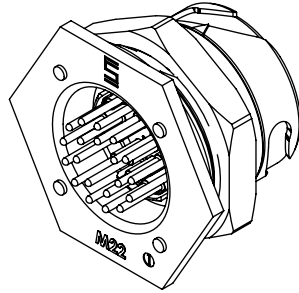

RECOMMENDED PANEL OPENING
SEE NOTE 4

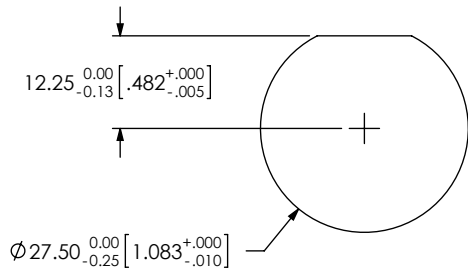

KEY FEATURE
SEE NOTE 2

-1
ORANGE KEY RING

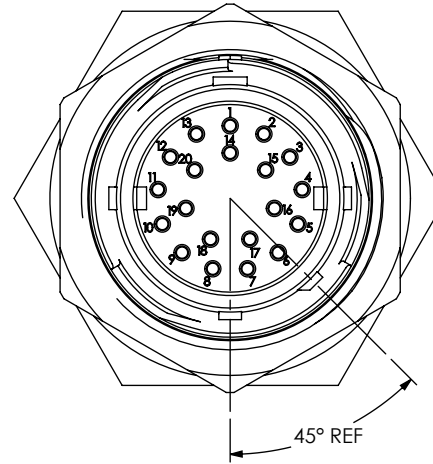

-2
GREEN KEY RING

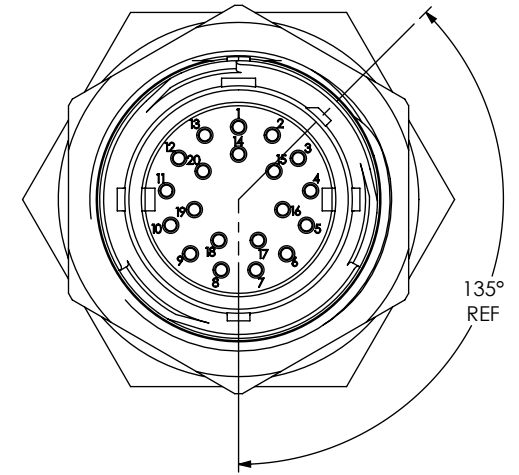

-3
BLUE KEY RING

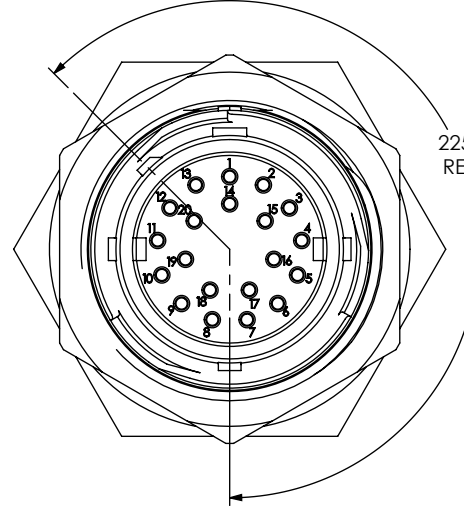

-4
YELLOW KEY RING

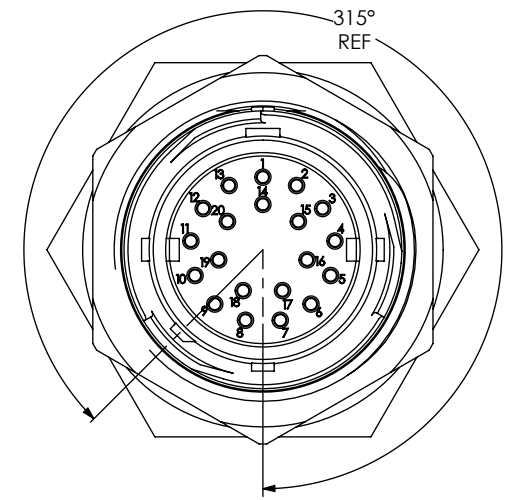

PROPRIETARY NOTE
THIS DOCUMENT CONTAINS CONFIDENTIAL AND PROPRIETARY INFORMATION AND ALL DESIGN, MANUFACTURING, REPRODUCTION, USE, PATENT RIGHTS AND SALES RIGHTS ARE EXPRESSLY RESERVED BY SAMTEC, INC. THIS DOCUMENT SHALL NOT BE DISCLOSED, IN WHOLE OR PART, TO ANY UNAUTHORIZED PERSON OR ENTITY NOR REPRODUCED, TRANSFERRED OR INCORPORATED IN ANY OTHER PROJECT IN ANY MANNER WITHOUT THE EXPRESS WRITTEN CONSENT OF SAMTEC, INC.

DO NOT SCALE DRAWING

SHEET SCALE: 1:1



520 PARK EAST BLVD, NEW ALBANY, IN 47150
PHONE: 812-944-6733 FAX: 812-948-5047
e-Mail: info@SAMTEC.com code 55322

DESCRIPTION: **ACCLIMATE CIRC. FIELD TERM. KIT**

DWG. NO. **ACRK-22-XX-X-X-XX-M-X**

BY: VICKY Z 06/16/2011 SHEET 4 OF 4